

State Geological Survey

29-32-22E

KANSAS DRILLERS LOG

WICHITA, BRANCH

S. 29 T. 32 R. 22 E
XX

API No. 15 — 021 — 20,066
County Number

Loc. NE NW NW

County Cherokee

Operator
Spradling Drilling, Inc.

Address
Rt. 1 Hermitage, Missouri

Well No. #1 Lease Name Rennie

Footage Location
feet from (N) (S) line feet from (E) (W) line

Principal Contractor Geologist
Spradling Drilling Inc. Steve Brown

Spud Date Total Depth P.B.T.D.
750'

Date Completed Oil Purchaser
12/31/74

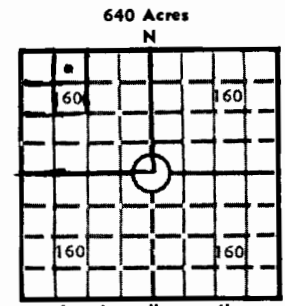

Elev.: Gr. _____

DF _____ KB _____

CASING RECORD

Report of all strings set — surface, intermediate, production, etc.

Purpose of string	Size hole drilled	Size casing set (in O.D.)	Weight lbs/ft.	Setting depth	Type cement	Sacks	Type and percent additives

LINER RECORD

PERFORATION RECORD

Top, ft.	Bottom, ft.	Sacks cement	Shots per ft.	Size & type	Depth interval

Size	Setting depth	Packer set at

ACID, FRACTURE, SHOT, CEMENT SQUEEZE RECORD

Amount and kind of material used	Depth interval treated

INITIAL PRODUCTION

Date of first production	Producing method (flowing, pumping, gas lift, etc.)				
RATE OF PRODUCTION PER 24 HOURS	Oil bbls.	Gas MCF	Water bbls.	Gas-oil ratio	CFPB
Disposition of gas (vented, used on lease or sold)			Producing interval (s)		

INSTRUCTIONS: As provided in KCC Rule 82-2-125, within 90 days after completion of a well, one completed copy of this Drillers Log shall be transmitted to the State Geological Survey of Kansas, 4150 Monroe Street, Wichita, Kansas 67209. Copies of this form are available from the Conservation Division, State Corporation Commission, 3830 So. Meridian (P.O. Box 17027), Wichita, Kansas 66217. Phone AC 316-522-2206. If confidential custody is desired, please note Rule 82-2-125. Drillers Logs will be on open file in the Oil and Gas Division, State Geological Survey of Kansas, Lawrence, Kansas 66044.

Operator

DESIGNATE TYPE OF COMP.: OIL, GAS, DRY HOLE, SWDW, ETC.:

Spradling Drilling Inc.

Dry Hole

Well No.

Lease Name

#1

Rennie

S 29 T 32 R 22 E
Wx

WELL LOG

Show all important zones of porosity and contents thereof; cored intervals, and all drill-stem tests, including depth interval tested, cushion used, time tool open, flowing and shut-in pressures, and recoveries.

SHOW GEOLOGICAL MARKERS, LOGS RUN, OR OTHER DESCRIPTIVE INFORMATION.

FORMATION DESCRIPTION, CONTENTS, ETC.	TOP	BOTTOM	NAME	DEPTH
Overburden	0	20		
Shale rock	20	25		
White lime	25	35		
Shale rock	35	38		
Coal	38	41		
Lime white	41	50		
Coal	50	56		
Gray Shale	56	135		
Lime rock	135	140		
Gray shale	140	170		
Lime white	170	180		
Gray shale	180	190		
Black shale	190	200		
Gray shale	200	245		
Black shale	245	247		
Gray shale	247	287		
Black shale	287	425		
Lime (520-570 Some flint)	425	750		
Total Depth 750'				

USE ADDITIONAL SHEETS, IF NECESSARY, TO COMPLETE WELL RECORD.

Date Received

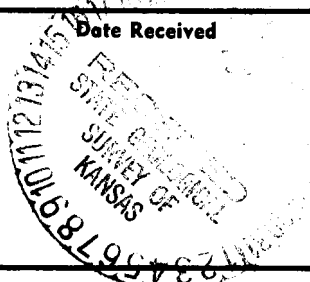

Dorothy Dankas
Signature

Secretary
Title

January 28, 1975
Date

48-32-978

524134