

IMPORTANT
 Kans. Geo. Survey request
 samples on this well.

15-32-25E

S. 15 T. 32 R. 25 E
 Loc. 1000' E & 1200' S/NWc
 County Cherokee

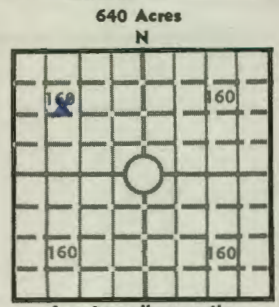

Elev.: Gr. 851
 DF _____ KB _____

KANSAS DRILLERS LOG
 WICHITA, BRANCH
 API No. 15 — 021 — 20,099
 County Number

Operator
Missouri Lead-Zinc Company

Address
1705 North Walnut Pittsburg, Kansas 66762

Well No. 87-7-1 Lease Name A. Junior Bower

Footage Location
1200 feet from (N) line 1000 feet from (E) (W) line

Principal Contractor American Water Wells Geologist Allan Park

Spud Date 11/11/75 Total Depth 305 P.B.T.D.

Date Completed 11/11/75 Oil Purchaser

CASING RECORD

Report of all strings set — surface, intermediate, production, etc.

Purpose of string	Size hole drilled	Size casing set (in O.D.)	Weight lbs/ft.	Setting depth	Type cement	Sacks	Type and percent additives
	<u>5 7/8"</u>	<u>6"</u>		<u>25'</u>			

LINER RECORD

PERFORATION RECORD

Top, ft.	Bottom, ft.	Sacks cement	Shots per ft.	Size & type	Depth interval

TUBING RECORD

Size	Setting depth	Packer set at

ACID, FRACTURE, SHOT, CEMENT SQUEEZE RECORD

Amount and kind of material used	Depth interval treated

INITIAL PRODUCTION

Date of first production _____ Producing method (flowing, pumping, gas lift, etc.) _____

RATE OF PRODUCTION PER 24 HOURS	Oil	Gas	Water	Gas-oil ratio
	bbis.	MCF	bbis.	CFPB

Disposition of gas (vented, used on lease or sold) _____ Producing interval (s) _____

INSTRUCTIONS: As provided in KCC Rule 82-2-125, within 90 days after completion of a well, one completed copy of this Drillers Log shall be transmitted to the State Geological Survey of Kansas, 4150 Monroe Street, Wichita, Kansas 67209. Copies of this form are available from the Conservation Division, State Corporation Commission, 3830 So. Meridian (P.O. Box 17027), Wichita, Kansas 66217. Phone AC 316-522-2206. If confidential custody is desired, please note Rule 82-2-125. Drillers Logs will be on open file in the Oil and Gas Division, State Geological Survey of Kansas, Lawrence, Kansas 66044.

Operator

Missouri Lead-Zinc

DESIGNATE TYPE OF COMP.: OIL, GAS, DRY HOLE, SWDW, ETC.:

Well No.

67-7-1

Lease Name

A. Junior Bower

S 15 T 32S R 25 E

WELL LOG

Show all important zones of porosity and contents thereof; cored intervals, and all drill-stem tests, including depth interval tested, cushion used, time tool open, flowing and shut-in pressures, and recoveries.

SHOW GEOLOGICAL MARKERS, LOGS RUN, OR OTHER DESCRIPTIVE INFORMATION.

FORMATION DESCRIPTION, CONTENTS, ETC.	TOP	BOTTOM	NAME	DEPTH
Overburden	0	20		
Shale	20	45		
Limestone & chert (Warsaw)	45	106		
Limestone (Short Creek)	106	110		
Limestone (Burlington)	110	185		
Chert & Cotton rock (Eisey)	185	235		
Limestone & chert (Reeds Spring)	235	305		

USE ADDITIONAL SHEETS, IF NECESSARY, TO COMPLETE WELL RECORD.

Date Received

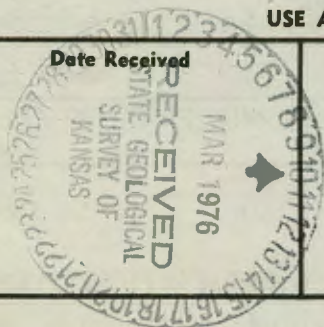

Allen M. Beck

Signature

Project Geologist

Title

11/12/75

Date

12-29-92E

5185 PC