

KANSAS

State Geological Survey
WICHITA BRANCH
AUG 8 0 1970

P1

WELL COMPLETION REPORT AND
DRILLER'S LOG

S. 1 T. 33 R. 17 E
W

Loc. 500' FEL & 320' FSL

County Labette

API No. 15 — 099 — 21,172
County Number

Operator Diamond Oil Producers, Inc.

Address 114 South Depot Cherryvale, Kansas 67335

Well No. #1 Lease Name Ruttgen-B

Footage Location
feet from (N) (S) line feet from (E) (W) line

Principal Contractor Plains Drilling Co. Geologist

Spud Date Date Completed Total Depth 780 ft. P.B.T.D.

Directional Deviation Oil and/or Gas Purchaser

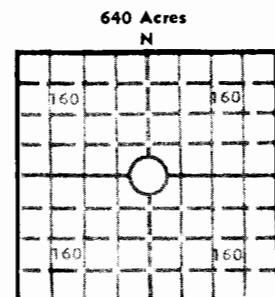

Locate well correctly
Elev.: Gr.

DF KB

CASING RECORD

Report of all strings set — surface, intermediate, production, etc.

| Purpose of string | Size hole drilled | Size casing set (in O.D.) | Weight lbs/ft. | Setting depth | Type cement | Sacks | Type and percent additives |
|-------------------|-------------------|---------------------------|----------------|---------------|-------------|-------|----------------------------|
| | | | | | | | |
| | | | | | | | |
| | | | | | | | |
| | | | | | | | |

LINER RECORD

PERFORATION RECORD

| Top, ft. | Bottom, ft. | Sacks cement | Shots per ft. | Size & type | Depth interval |
|----------|-------------|--------------|---------------|-------------|----------------|
| | | | | | |
| | | | | | |
| | | | | | |

TUBING RECORD

| Size | Setting depth | Packer set at |
|------|---------------|---------------|
| | | |

ACID, FRACTURE, SHOT, CEMENT SQUEEZE RECORD

| Amount and kind of material used | Depth interval treated |
|----------------------------------|------------------------|
| | |
| | |
| | |

INITIAL PRODUCTION

| | | | | | |
|--|---|------------|------------------------|---------------|------|
| Date of first production | Producing method (flowing, pumping, gas lift, etc.) Dry Hole | | | | |
| RATE OF PRODUCTION PER 24 HOURS | Oil bbls. | Gas MCF | Water bbls. | Gas-oil ratio | CFPB |
| Disposition of gas (vented, used on lease or sold) | | | Producing interval (s) | | |

INSTRUCTIONS: As provided in KCC Rule 82-2-125, within 90 days after completion of a well, one completed copy of this Drillers Log shall be transmitted to the State Geological Survey of Kansas, 4150 Monroe Street, Wichita, Kansas 67209. Copies of this form are available from the Conservation Division, State Corporation Commission, 245 No. Water, Wichita, Kansas 67202. Phone AC 316-522-2206. If confidential custody is desired, please note Rule 82-2-125. Drillers Logs will be on open file in the Oil and Gas Division, State Geological Survey of Kansas, Lawrence, Kansas 66044.

Operator _____ DESIGNATE TYPE OF COMP.: OIL, GAS, DRY HOLE, SWDW, ETC.:

Well No. _____ Lease Name _____

S _____ T _____ R _____ E _____ W _____

WELL LOG
Show all important zones of porosity and contents thereof; cored intervals, and all drill-stem tests, including depth interval tested, cushion used, time tool open, flowing and shut-in pressures, and recoveries. SHOW GEOLOGICAL MARKERS, LOGS RUN, OR OTHER DESCRIPTIVE INFORMATION.

| FORMATION DESCRIPTION, CONTENTS, ETC. | TOP | BOTTOM | NAME | DEPTH |
|---------------------------------------|-----|--------|------|-------|
| | | | | |

USE ADDITIONAL SHEETS, IF NECESSARY, TO COMPLETE WELL RECORD.

| | |
|---------------|--|
| Date Received | Signature _____ Title _____ Date _____ |
|---------------|--|