

KANSAS DRILLERS LOG

State Geological Survey
WICHITA, BRANCH

S. 5 T. 33 R. 21 ~~W~~_{SW}

Loc. NE SE NW

County Labette

API No. 15 — 099 — 20,353
County Number

Operator
Joy Spradling Drilling, Inc.

Address
Route #1 Box 36 Hermitage, Missouri 65668

Well No. 2 Lease Name Sykes

Footage Location
feet from (N) (S) line _____ feet from (E) (W) line _____

Principal Contractor Joy Spradling Drilling, Inc. Geologist James Finch

Spud Date _____ Total Depth 890' P.B.T.D. _____

Date Completed June 4, 1975 Oil Purchaser _____

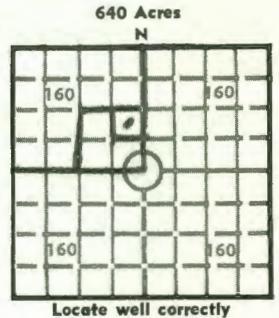

Elev.: Gr. _____

DF _____ KB _____

CASING RECORD

Report of all strings set — surface, intermediate, production, etc.

Purpose of string	Size hole drilled	Size casing set (in O.D.)	Weight lbs/ft.	Setting depth	Type cement	Sacks	Type and percent additives
Hold back Overburden	6 1/8"	6 5/8"	13#				

LINER RECORD

PERFORATION RECORD

Top, ft.	Bottom, ft.	Sacks cement	Shots per ft.	Size & type	Depth interval

TUBING RECORD

Size	Setting depth	Packer set at

ACID, FRACTURE, SHOT, CEMENT SQUEEZE RECORD

Amount and kind of material used	Depth interval treated

INITIAL PRODUCTION

Date of first production _____		Producing method (flowing, pumping, gas lift, etc.) _____			
RATE OF PRODUCTION PER 24 HOURS	Oil _____ bbls.	Gas _____ MCF	Water _____ bbls.	Gas-oil ratio _____ CFPB	
Disposition of gas (vented, used on lease or sold) _____			Producing interval (s) _____		

INSTRUCTIONS: As provided in KCC Rule 82-2-125, within 90 days after completion of a well, one completed copy of this Drillers Log shall be transmitted to the State Geological Survey of Kansas, 4150 Monroe Street, Wichita, Kansas 67209. Copies of this form are available from the Conservation Division, State Corporation Commission, 3830 So. Meridian (P.O. Box 17027), Wichita, Kansas 66217. Phone AC 316-522-2206. If confidential custody is desired, please note Rule 82-2-125. Drillers Logs will be on open file in the Oil and Gas Division, State Geological Survey of Kansas, Lawrence, Kansas 66044.

Operator Joy Spradling Drilling, Inc. DESIGNATE TYPE OF COMP.: OIL, GAS, DRY HOLE, SWDW, ETC.: Dry Hole

Well No. 2 Lease Name Sykes

S 5 T 33 R 21 ^E/_{SW} NE SE NW Labette

WELL LOG

Show all important zones of porosity and contents thereof; cored intervals, and all drill-stem tests, including depth interval tested, cushion used, time tool open, flowing and shut-in pressures, and recoveries.

SHOW GEOLOGICAL MARKERS, LOGS RUN, OR OTHER DESCRIPTIVE INFORMATION.

FORMATION DESCRIPTION, CONTENTS, ETC.	TOP	BOTTOM	NAME	DEPTH
Overburden	0	11'		
Lime	11'	25'		
Shale (Coal)	25'	30'		
Lime	30'	32'		
Shale	32'	149'		
Lime	149'	153'		
Shale	153'	563½'		
Lime	563½'	890'		
690' - 20 GPM				
Total Depth - 890'				

USE ADDITIONAL SHEETS, IF NECESSARY, TO COMPLETE WELL RECORD.

Date Received	<u>Gladys Morrow</u>
	Secretary
	6-20-75

Signature

Title

Date

95545