

BURR ROCK OIL AND GAS CO.  
 L. A. Brooks No. 1.

SEC. 5 T. 33 R. 3E.  
 SWc SW

Total Depth. 3535  
 Comm. 10-9-33 Comp. 3-25-34  
 Shot or Treated.  
 Contractor. T.F. Van Meter.  
 Issued. 10-20-34.

County. Cowley.

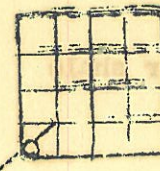

CASING.

20" 55' 10" 1965'  
 15 1/2" 400' 8 1/2" 2215'  
 12 1/2" 945' 6 5/8" 3170'

Elevation.

Production. DRY

Figures Indicate Bottom of Formations.

sand	50	shale	823	lime wh hard	1805
shale and shells	120	lime	827	shale dark soft	1830
lime	170	shale blue soft	868	lime	1840
shale	175	lime	874	shale dark	1848
lime white	190	shale	885	lime wh hard	1852
shale wh then green	208	lime	889	shale blue soft	1870
lime	245	shale	940	red rock	1882
shale	255	sand 1BW	950	lime wh hard	1887
lime	310	shale	965	red rock	1903
shale white	315	lime	970	lime	1910
red rock	316	shale blue	1020	lime wh hard	1923
shale white	336	lime shell	1025	shale blue cave	1965
lime	342	shale	1057	lime brown hard	1976
shale blue	348	lime	1070	shale blue sdy	2032
red rock	355	shale	1105	lime sdy	2048
lime	370	lime little wtr 1110	1115	shale blue	2050
shale	375	shale and shells	1125	lime sdy	2060
lime wh hard	404	shells and lime	1153	shale sdy	2124
shale light	415	shale blue	1180	lime	2129
red rock	425	lime white	1188	shale blue	2161
lime	433	shale pink soft	1202	lime sdy	2170
shale blue	440	lime	1225	sand	2203
lime	445	shale	1238	250' wtr in hole	
shale	455	lime	1243	shale	2205
lime	470	red rock	1248	sand grey HFW	2248
shale blue soft	476	shale	1281	lime hard sdy	2254
lime wh hard	480	lime white	1288	shale blue	2372
shale blue soft	490	shale blue	1335	lime sdy hard	2392
lime wh hard	495	lime sdy	1365	shale	2525
shale blue soft	507	shale	1375	shale blk	2535
lime	510	lime	1390	shale blue	2545
shale	523	shale	1395	lime brown	2555
lime	544	lime	1410	shale blue	2572
shale	550	shale blue	1474	sand	2594
red rock	590	lime wh hard	1480	lime sdy	2620
lime	615	lime broken wh	1505	shale blue	2730
shale light soft	620	lime 2 BW 1510	1530	lime brown hard	2845
lime wh hard	624	shale	1535	lime sdy	2855
shale blue soft	629	lime wh hard	1568	shale blue	2878
lime wh hard	633	shale blk soft	1570	sand grey oil sh	2885
shale blue	637	lime wh hard	1590	shale blue	2915
lime	643	shale dark soft	1600	lime brown	2947
shale	650	lime wh hard	1622	shale dark	2954
lime	656	shale	1625	lime	2986
shale	662	lime	1635	shale blk	2992
lime	700	shale blue	1639	lime	3014
1 BW 672		lime wh hard	1657	shale	3019
shale	703	shale dark	1660	lime	3025
lime and shale	730	lime	1665	shale	3088
shale blue soft	738	shale sdy	1689	lime 2 BW 3095	3097
lime	748	shale blue	1702	sdly shale blk	3143
shale blue soft	755	lime hard	1710	red rock	3147
lime	765	shale	1725	shale blue	3166
shale	767	sand	1728	lime	3195
lime shells	770	shale sdy	1742	lime brown hard	3234
shale	786	sand 2 BW 1743	1748		
lime	792	shale blue soft	1755		
shale	812	sand grey	1778		
lime	815	shale blue	1792		

OVER

5-33-3E.  
 L. A. Brooks No. 1.  
 Burr Rock Oil and Gas Co.

lime blk	3386
lime dark or shale	3402
lime	3404
shale blue	3420
lime green	3428
shale blk	3504
sand top green HFV	3530
sand	3535 TD.

Quit drilling March 25, 1934.

1800	lime blk	3386	lime blk	3386	lime blk	3386
1801	lime dark or shale	3402	lime dark or shale	3402	lime dark or shale	3402
1802	lime	3404	lime	3404	lime	3404
1803	shale blue	3420	shale blue	3420	shale blue	3420
1804	lime green	3428	lime green	3428	lime green	3428
1805	shale blk	3504	shale blk	3504	shale blk	3504
1806	sand top green HFV	3530	sand top green HFV	3530	sand top green HFV	3530
1807	sand	3535 TD.	sand	3535 TD.	sand	3535 TD.
1808						
1809						
1810						
1811						
1812						
1813						
1814						
1815						
1816						
1817						
1818						
1819						
1820						
1821						
1822						
1823						
1824						
1825						
1826						
1827						
1828						
1829						
1830						
1831						
1832						
1833						
1834						
1835						
1836						
1837						
1838						
1839						
1840						
1841						
1842						
1843						
1844						
1845						
1846						
1847						
1848						
1849						
1850						
1851						
1852						
1853						
1854						
1855						
1856						
1857						
1858						
1859						
1860						
1861						
1862						
1863						
1864						
1865						
1866						
1867						
1868						
1869						
1870						
1871						
1872						
1873						
1874						
1875						
1876						
1877						
1878						
1879						
1880						
1881						
1882						
1883						
1884						
1885						
1886						
1887						
1888						
1889						
1890						
1891						
1892						
1893						
1894						
1895						
1896						
1897						
1898						
1899						
1900						