

15-035-22151

27-33-4E

State Geological Survey
WICHITA BRANCH
KANSAS DRILLERS LOG

S. 27 T. 33S R. 4E E W
Loc. C- NW-SW
County Cowley

API No. 15 — 035 — 22,151
County Number

Operator
Petroleum Enterprises

Address
0201 College Drive, Winfield, Kansas 67156

Well No. **1** Lease Name **McFarland**

Footage Location
990 feet from (N) (S) line **660** feet from (E) (W) line

Principal Contractor **B & N Drilling** Geologist **F.W. Morgan**

Spud Date **2/26/79** Total Depth **750'** P.B.T.D.

Date Completed **3/2/79** Oil Purchaser **none**

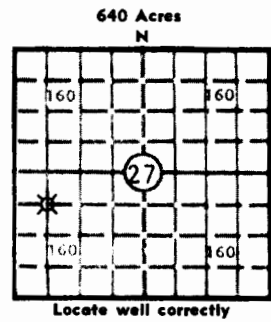

Locate well correctly
Elev.: Gr. **1144**
DF _____ KB _____

CASING RECORD

Report of all strings set — surface, intermediate, production, etc.

Purpose of string	Size hole drilled	Size casing set (in O.D.)	Weight lbs/ft.	Setting depth	Type cement	Sacks	Type and percent additives
Surface	8-3/4	7"	S.H.	203'	common	100	circulated
Production	7"	4 1/2"	8.5	750'	Portland	76	Halco Gel 2% Salt 10%

LINER RECORD

PERFORATION RECORD

Top, ft.	Bottom, ft.	Sacks cement	Shots per ft.	Size & type	Depth interval
none			Two	3 1/2 stick	640-648
TUBING RECORD			Two	3 1/2 stick	674-682
Size	Setting depth	Pecker set at			
none					

ACID, FRACTURE, SHOT, CEMENT SQUEEZE RECORD

Amount and kind of material used	Depth interval treated
Treated Formation with 300 gal. 15% MCA Acid. During treatment	640-648 674-682
dropped 14 Perf. Pac. Balls. Formation broke at 1700 psi;	
acid overflushed by 2 bbls. water	

INITIAL PRODUCTION

Date of first production **Shut in** Producing method (flowing, pumping, gas lift, etc.) **Flowing**

RATE OF PRODUCTION PER 24 HOURS	Oil _____ bbls.	Gas 500,000 CF	Water _____ bbls.	Gas-oil ratio _____ CFPB
---------------------------------	-----------------	-----------------------	-------------------	--------------------------

Disposition of gas (vented, used on lease or sold) **Shut in** Producing interval (s) **640-648; 674-682**

INSTRUCTIONS: As provided in KCC Rule 82-2-125, within 90 days after completion of a well, one completed copy of this Drillers Log shall be transmitted to the State Geological Survey of Kansas, 4150 Monroe Street, Wichita, Kansas 67209. Copies of this form are available from the Conservation Division, State Corporation Commission, 3830 So. Meridian (P.O. Box 17027), Wichita, Kansas 66217. Phone AC 316-522-2206. If confidential custody is desired, please note Rule 82-2-125. Drillers Logs will be on open file in the Oil and Gas Division, State Geological Survey of Kansas, Lawrence, Kansas 66044.

Operator **Petroleum Enterprises** DESIGNATE TYPE OF COMP.: OIL, GAS, DRY HOLE, SWDW, ETC.:

Well No. **1** Lease Name **McFarland** Gas

S 27 T 33R 4E^E_W **27-33-4E**

WELL LOG
 Show all important zones of porosity and contents thereof; cored intervals, and all drill-stem tests, including depth interval tested, cushion used, time tool open, flowing and shut-in pressures, and recoveries. SHOW GEOLOGICAL MARKERS, LOGS RUN, OR OTHER DESCRIPTIVE INFORMATION.

FORMATION DESCRIPTION, CONTENTS, ETC.	TOP	BOTTOM	NAME	DEPTH
top soil	0	10		
lime	10	12		
water sand	12	35		
shale	35	60		
sandy lime	60	124		
shale	124	160		
lime	160	204		
shale	204	254		
sandy lime	254	480		
lime	480	495		
shale	495	580		
sand	580	671		
shale	671	689		
lime/shale	689	690		
shale	690	750		

USE ADDITIONAL SHEETS, IF NECESSARY, TO COMPLETE WELL RECORD.

Date Received _____

Signature *[Handwritten Signature]*

Title _____

Date *May 23 1979*