

KANSAS DRILLERS LOG

S. 36 T. 33 R. 6 ^E/_W
 Loc. 150' W/SE NE NW
 County Cowley

API No. 15 — 035 — 21,805
 County Number

Operator
McNeish Oil Corp. OPERATIONS

Address
528 State Bank Bldg., Box 734 Winfield, Kansas 67156

Well No. #1 Lease Name David

Footage Location
990 feet from (N) (X) line 480' feet from (E) (W) line

Principal Contractor White & Ellis Drilling, Inc. Geologist George R. McNeish

Spud Date 1-23-78 Total Depth 2845 KB P.B.T.D.

Date Completed 1-28-78 Oil Purchaser Apco Oil Corporation

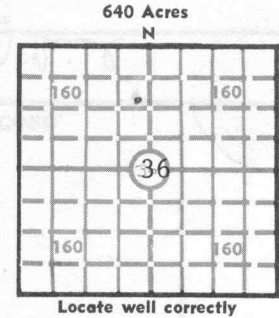

Elev.: Gr. 1179
 DF _____ KB 1184

CASING RECORD

Report of all strings set — surface, intermediate, production, etc.

Purpose of string	Size hole drilled	Size casing set (in O.D.)	Weight lbs/ft.	Setting depth	Type cement	Sacks	Type and percent additives
Surface		8 5/8		205		85	
Production		4 1/2		2799	60/40 Pos	200	10% Salt

LINER RECORD

PERFORATION RECORD

Top, ft.	Bottom, ft.	Sacks cement	Shots per ft.	Size & type	Depth interval
			2		2720-28

Size	Setting depth	Packer set at
2"	2740	

ACID, FRACTURE, SHOT, CEMENT SQUEEZE RECORD

Amount and kind of material used	Depth interval treated
500 Gal. MCA	2720-28
20,000# Sd and 475 BW	2720-28

INITIAL PRODUCTION

Date of first production <u>3/78</u>	Producing method (flowing, pumping, gas lift, etc.) <u>Pumping</u>
RATE OF PRODUCTION PER 24 HOURS	Oil <u>25</u> bbls. Gas <u>50</u> bbls. Water <u>50</u> bbls. Gas-oil ratio _____ CFPB
Disposition of gas (vented, used on lease or sold)	Producing interval (s) <u>2720-28</u>

INSTRUCTIONS: As provided in KCC Rule 82-2-125, within 90 days after completion of a well, one completed copy of this Drillers Log shall be transmitted to the State Geological Survey of Kansas, 4150 Monroe Street, Wichita, Kansas 67209. Copies of this form are available from the Conservation Division, State Corporation Commission, 3830 So. Meridian (P.O. Box 17027), Wichita, Kansas 66217. Phone AC 316-522-2206. If confidential custody is desired, please note Rule 82-2-125. Drillers Logs will be on open file in the Oil and Gas Division, State Geological Survey of Kansas, Lawrence, Kansas 66044.

Operator **George R. McNeish** DESIGNATE TYPE OF COMP.: **OIL, GAS, DRY HOLE, SWDW, ETC.:**

Well No. **1** Lease Name **David**

S 36 T 33S R 6 ^E_W

WELL LOG

Show all important zones of porosity and contents thereof; cored intervals, and all drill-stem tests, including depth interval tested, cushion used, time tool open, flowing and shut-in pressures, and recoveries.

SHOW GEOLOGICAL MARKERS, LOGS RUN, OR OTHER DESCRIPTIVE INFORMATION.

FORMATION DESCRIPTION, CONTENTS, ETC.	TOP	BOTTOM	NAME	DEPTH
Cellar	0	7		
Lime & Shale	7	415	Kansas City	2112
Shale & Lime (Stks)	415	750	Mississippi	2714
Lime & Shale	750	1000		
Sand	1000	1090		
Shale	1090	1100		
Shale & Lime (Stks)	1100	1635		
Shale-Sand-Lime	1635	1865		
Shale & Sand	1865	2112		
Lime	2112	2120		
Lime & Shale	2120	2285		
Sandy Shale	2285	2335		
Lime	2335	2486		
Shale & Lime (Stks)	2486	2595		
Lime & Shale	2595	2714		
Lime	2714	2845		

USE ADDITIONAL SHEETS, IF NECESSARY, TO COMPLETE WELL RECORD.

Date Received _____

Signature George R. McNeish

Operator _____

Title _____

Date 3/30/78

30-33-96

DRILLERS LOG

15-035-2180J

36-33-6E

OPERATOR: George McNeish; Box 734; Winfield, Kansas 67156

CONTRACTOR: **White & Ellis Drilling, Inc., Box 448, El Dorado, Kansas 67042**

Lease Name David Well No. 1

Sec. 36 T. 33S R. 6E Spot SE NE NW

County Cowley State Kansas Elevation _____

Casing Record:

Surface: 8 5/8" @ 205' with 85 Sxs.
Production: 4 1/2" @ 2799' with 200 Sxs.

Type Well: Oil Total Depth 2845' K.B.

Drilling Commenced: 1-23-78 Drilling Completed 1-28-78

Formation	From	To	Tops
Cellar	0	7	Kansas City 2112
Lime & Shale	7	415	Mississippi 2714
Shale & Lime (Stks)	415	750	
Lime & Shale	750	1000	
Sand	1000	1090	
Shale	1090	1100	
Shale & Lime (Stks)	1100	1635	
Shale-Sand-Lime	1635	1865	
Shale & Sand	1865	2112	
Lime	2112	2120	
Lime & Shale	2120	2285	
Sandy Shale	2285	2335	
Lime	2335	2486	
Shale & Lime (Stks)	2486	2595	
Lime & Shale	2595	2714	
Lime	2714	2845	