

**KANSAS DRILLERS LOG**

S. 17 T. 34S R. 1W <sup>E</sup> EAST

Loc. SE SE NE

County Sumner

API No. 15 — 191 — 21089  
County Number

Operator  
A. L. Abercrombie, Inc.

Address  
801 Union Center, Wichita, KS 67202

Well No. #1 Lease Name POSEY

Footage Location  
2310 feet from (N)  line 330 feet from (E)  line

Principal Contractor White & Ellis Geologist Dean Jirrels

Spud Date 8/30/80 Total Depth 3986 P.B.T.D. 3986

Date Completed \_\_\_\_\_ Oil Purchaser \_\_\_\_\_

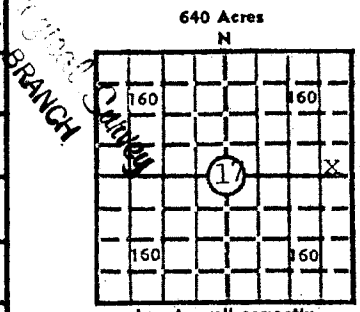

Locate well correctly  
Elev.: Gr. 1170

DF \_\_\_\_\_ KB 1175

**CASING RECORD**

Report of all strings set— surface, intermediate, production, etc.

Purpose of string	Size hole drilled	Size casing set (in O.D.)	Weight lbs/ft.	Setting depth	Type cement	Sacks	Type and percent additives
Surface	12 1/4	8 5/8"	28#	263	common	90	2% gel
production	7 7/8	5 1/2"	14#	3984	common	100	
		D.V. Tool		3115	common	100	

**LINER RECORD**

**PERFORATION RECORD**

Top, ft.	Bottom, ft.	Sacks cement	Shots per ft.	Size & type	Depth interval
			open hole		3984-3986

**TUBING RECORD**

Size	Setting depth	Packer set at

**ACID, FRACTURE, SHOT, CEMENT SQUEEZE RECORD**

Amount and kind of material used	Depth interval treated
None	Open hole 3984-3986

**INITIAL PRODUCTION**

Date of first production		Producing method (flowing, pumping, gas lift, etc.) <u>pumping</u>			
RATE OF PRODUCTION PER 24 HOURS	Oil <u>6</u> bbls.	Gas MCF	Water <u>90</u> bbls.	Gas-oil ratio	CFPB
Disposition of gas (vented, used on lease or sold)			Producing interval(s) <u>Open hole 3984-3986</u>		

INSTRUCTIONS: As provided in KCC Rule 82-2-125, within 90 days after completion of a well, one completed copy of this Drillers Log shall be transmitted to the State Geological Survey of Kansas, 4150 Monroe Street, Wichita, Kansas 67209. Copies of this form are available from the Conservation Division, State Corporation Commission, 3830 So. Meridian (P.O. Box 17027), Wichita, Kansas 66217. Phone AC 316-522-2206. If confidential custody is desired, please note Rule 82-2-125. Drillers Logs will be on open file in the Oil and Gas Division, State Geological Survey of Kansas, Lawrence, Kansas

Operator A. L. Abercrombie, Inc. DESIGNATE TYPE OF COMP.: OIL, GA,  
DRY HOLE, SWDW, ETC.:

Well No. 1 Lease Name POSEY Dry Hole

S 17 T 34S R 1W E EAST

**WELL LOG**

Show all important zones of porosity and contents thereof; cored intervals, and all drill-stem tests, including depth interval tested, cushion used, time tool open, flowing and shut-in pressures, and recoveries.

SHOW GEOLOGICAL MARKERS, LOGS RUN, OR OTHER DESCRIPTIVE INFORMATION.

FORMATION DESCRIPTION, CONTENTS, ETC.	TOP	BOTTOM	NAME	DEPTH
Cellar	0	7	SAMPLE TOPS:	
Shale, Lime	7	1855		
Lime	1855	2040	Kansas City	3194'
Shale, Lime	2040	2765	Mississippi	3658'
Shale	2765	2885		
Shale, Lime	2885	3032		
Sand	3032	3053		
Shale	3033	3077		
Sand	3077	3079		
Shale, Sand	3079	3194		
Lime	3194	3297		
Shale	3297	3312		
Lime	3312	3517		
Shale, Lime	3517	3658		
Lime	3658	3785		
Shale	3785	3805		
Shale, Lime	3805	3832		
Lime	3832	3919		
Shale	3919	3982		
Sand	3982	3986		
<p>DST #1 (3033'-3053). 30", 30", 45", 45". Weak 1/2" blow increasing to 6" after 20 minutes. Steady 6" thereafter. Recovered 10' gas in pipe and 350' fluid. Breakdown was: 170' thick, grassy, froggy, muddy oil emulsion (est. 10% oil too thick to grind our - like peanut butter) 60' very slightly oil cut watery mud. 120' muddy salt water. IFP 125#-160#, FFP 170#-200#, IBHP 930#, FBHP 930#. Temp. 110°.</p> <p>DST #2 (3068'-3079'). (Second Layton Sd.). 30", 30", 45", 45". Weak blow increasing to 6" after 15 min. Second opening, blew off bottom of bucket after 10 minutes. Recovered 520' fluid. 45' slightly oil &amp; gas cut mud, 120' heavy</p>				
USE ADDITIONAL SHEETS, IF NECESSARY, TO COMPLETE WELL RECORD.				

Date Received	<p>_____ Jack L. Partridge Signature Assistant Secretary/Treasurer _____ Title December, 16, 1980 _____ Date</p>
---------------	--

P2

State Geologist ~~17-34~~ 1W

WICHITA BRANCH

oil and gas cut mud (10% oil - 40% gas, 50% mud), 120' froggy, heavy oil & gas cut mud (15% oil), 60' slightly oil cut salty mud, 175' muddy salt water, IFP 160#-200#, FFP 220#-275#, IBHP 1105#, FBHP 1130#. Temp. 116°.

DST #3 (3662 - 3673'). Missrun slid tool 15'. Plugged tool.

DST #4 (3662'-3673'). 30", 30", 30", 30". Weak blow increasing to strong blow off bottom of bucket in 12 minutes. 1110' gas in pipe, 90' thick, froggy, gassy, muddy, oily emulsion, 60' oily salt water, IFP 17#-34#, FFP 34#-52#, IBHP 953#, FBHP 858#. Temp. 120°.

DST #5 (3682'-3694'). 30", 30", 45", 45". Weak blow increasing to 3 inches on first opening. On second opening increased to bottom of bucket. 240' gas in pipe, 100' froggy, gassy, muddy oil emulsion (8% oil) 120' muddy water, IFP 20#-75#, FFP 105#-115#, IBHP 1065#, FBHP 970#, Temp. 128°.

DST #6 (3974'-3984'). 30", 30", 20", 30". Very weak blow. Died 7 minutes into first flow. Flushed tool after 10 minutes. No blow on second flow. Recovered 2' mud. IFP 0#-0#, FFP 0#-0#, IBHP 0#, FBHP 10#. Temp 127°.

DST #7 (3976'-3986') 30", 30", 30", 30". Good blow on first flow. Decreasing on second flow. 1410' gas, 90' thick gassy muddy oil emulsion, 120' gassy muddy oil cut water (scum of oil), 540' clean salt water, IFP 31#-201#, FFP 225#-349#, IBHP 1242#, FBHP 1245#. Temp. 137°.

17-345-1W  
#1 Posey

DRILLERS LOG

State Geological Survey  
WICHITA, BRANCH

OPERATOR: ABERCROMBIE DRILLING, INC., 801 Union Center, Wichita, Ks. 67202  
CONTRACTOR: White & Ellis Drilling, Inc., Box 448, El Dorado, Kansas 67042

Lease Name Posey Well No. 1  
Sec. 17 T. 34S R. 1E Spot SE SE NE  
County Sumner State Kansas Elevation \_\_\_\_\_

Casing Record:

Surface: 8 5/8" @ 263.4' with 90 sx Sxs.

Production: \_\_\_\_\_ @ \_\_\_\_\_ with \_\_\_\_\_ Sxs.

Type Well: Oil Well Total Depth 3986'

Drilling Commenced: 8-30-80 Drilling Completed 9-11-80

Formation	From	To	Tops
Cellar	0	7	Kansas City - 3194
Shale, Lime	7	1855	Mississippi - 3658
Lime	1855	2040	
Shale, Lime	2040	2765	
Shale	2765	2885	
Shale, Lime	2885	3032	
Sand	3032	3053	
Shale	3033	3077	
Sand	3077	3079	
Shale, Sand	3079	3194	
Lime	3194	3297	
Shale	3297	3312	
Lime	3312	3517	
Shale, Lime	3517	3658	
Lime	3658	3785	
Shale	3785	3805	
Shale, Lime	3805	3832	
Lime	3832	3919	
Shale	3919	3982	
Sand	3982	3986	