

KANSAS DRILLERS LOG

S. 5 T. 34 R. 13 E. XXX

API No. 15 CHAUTAUQUA 22, 193
County Number

Loc. NE 1/4
County CHAUTAUQUA

Operator WELLS-BATTELSTEIN OIL & GAS, INC.

Address 17 S. ASHBY P.O. BOX 762 CHANUTE, KANSAS 66720

Well No. #8 Lease Name LUMLEY

Footage Location 990' FS & EL NE 1/4
feet from (N) (S) line feet from (E) (W) line

Principal Contractor WHITE HAWK DRILLING, INC. Geologist N.A.

Spud Date FEBRUARY 14, 1981 Total Depth 1095' P.B.T.D.

Date Completed FEBRUARY 16, 1981 Oil Purchaser KOCH

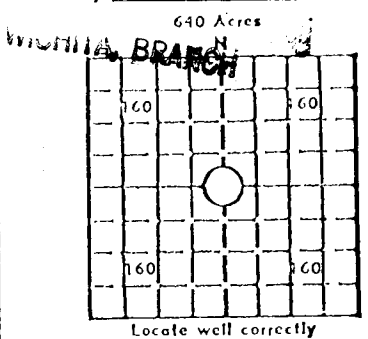

Elev.: Gr. _____
DF _____ KB _____

CASING RECORD

Report of all strings set— surface, intermediate, production, etc.

Purpose of string	Size hole drilled	Size casing set (in O.D.)	Weight lbs/ft.	Setting depth	Type cement	Sacks	Type and percent additives
PRODUCTION	6 3/4	4 1/2	9.5	1092.45'	POZMIX "A"	150	NONE
SURFACE CASING	9 7/8	7 5/8	26.40	92'	PORTLAND	30	NONE

LINER RECORD

PERFORATION RECORD

Top, ft.	Bottom, ft.	Sacks cement	Shots per ft.	Size & type	Depth interval
			2	DML-JETS 3 1/2"	996-1014'

TUBING RECORD

Size	Setting depth	Packer set at

ACID, FRACTURE, SHOT, CEMENT SQUEEZE RECORD

Amount and kind of material used	Depth interval treated
FRAC-SAND 125 Sacks of 10/20 & FRAC-SAND 125 Sacks of 8/12	996-1014'
USED 500 GAL. OF MCA-ACID	

INITIAL PRODUCTION

Date of first production.	Producing method (flowing, pumping, gas lift, etc.)				
RATE OF PRODUCTION PER 24 HOURS	Oil bbls.	Gas MCF	Water bbls.	Gas-oil ratio	CFPB
Disposition of gas (vented, used on lease or sold)				Producing interval (s)	

INSTRUCTIONS: As provided in KCC Rule 82-2-125, within 90 days after completion of a well, one completed copy of this Drillers Log shall be transmitted to the State Geological Survey of Kansas, 4150 Monroe Street, Wichita, Kansas 67209. Copies of this form are available from the Conservation Division, State Corporation Commission, 3830 So. Meridian (P.O. Box 17027), Wichita, Kansas 66217. Phone AC 316-522-2206. If confidential custody is desired, please note Rule 82-2-125. Drillers Logs will be on an open file in the Oil and Gas Division, State Geological Survey of Kansas, Lawrence, Kansas 66044.

WELLS-BATTELSTEIN OIL & GAS, INC.

DESIGNATE TYPE OF COMP.: OIL, GAS, DRY HOLE, SWDW, ETC.:

Well No.

#8

Lease Name

LUMLEY

5 T 34 R 13 E XXX

WELL LOG

SHOW GEOLOGICAL MARKERS, LOGS RUN, OR OTHER DESCRIPTIVE INFORMATION.

Show all important zones of porosity and contents thereof; cored intervals, and all drill-stem tests, including depth interval tested, cushion used, time tool open, flowing and shut-in pressures, and recoveries.

FORMATION DESCRIPTION, CONTENTS, ETC.	TOP	BOTTOM	NAME	DEPTH
Clay	0	15		
Sandstone	15	17		
Clay	17	23		
Shale	23	28		
Shale	28	32		
Hard Gray Sand	32	34		
Shale & Sand.	34	42		
Shale	42	92		
Shale	92	210		
Lime	210	216		
Shale	216	230		
Lime	230	236		
Shale	236	274		
Hard Gray Lime	274	281		
Hard Gray Lime or Sand	281	290		
Easy Drlg. Gray Sand	290	293		
Hard Gray Sand	293	306		
Off & on Easy Drlg. Gray Sand	306	316		
Black Shale	316	329		
Lime	329	331		
Gray With White Sand	331	334		
Hard Gray Sand	334	337		
Gray Easy Drlg. Sand	337	368		
Sandy Shale	368	399		
Shale	399	440		
IOLA LIME	440	443		
Sandy Shale	443	496		
Shale	496	536		
Black Shale	536	540		
Shale	540	620		
Shale	620	688		
Lime (Drum)	668	695		
Sandy Shale	695	721		
RED SAND NO ODOR	721	750		
Shale	750	889		
Lime (LENÉPAH)	889	905		
Sandy Shale	905	955		
LIME (ALTAMONT)	955	983		
Lime (ALTAMONT)	983	989		

(CONTINUED)

USE ADDITIONAL SHEETS, IF NECESSARY, TO COMPLETE WELL RECORD.

Date Received

J. L. HAIGLER
General Manager

C. HUTINETT
Field Superintendent

Signature

Title

Date

Operator

WELLS-BATTELSTEIN OIL & GAS, INC.

DESIGNATE TYPE OF COMPLETION: OIL, GAS, DRY HOLE, SWDOW, ETC.

Well No.

#8

Lease Name

LUMLEY

S 5 T 34 R 13 E
XXX

21

WELL LOG

Show all important zones of porosity and contents thereof; cored intervals, and all drill-stem tests, including depth interval tested, cushion used, time tool open, flowing and shut-in pressures, and recoveries.

SHOW GEOLOGICAL MARKERS, LOGS RUN, OR OTHER DESCRIPTIVE INFORMATION.

FORMATION DESCRIPTION, CONTENTS, ETC.	TOP	BOTTOM	NAME	DEPTH
Shale	989	996		
WIESER OIL SAND	996	1017	(FAIR SHOW LIGHT TO FAIR ODOR	
WIESER WATER SAND	1017	1065		
Shale	1065	1095'	T.D.	

USE ADDITIONAL SHEETS, IF NECESSARY, TO COMPLETE WELL RECORD.

Date Received

J. L. HAIGLER
General Manager

C. HUTINETT
Field Superintendent

Signature

Title

Date