

15-125-22,092

WICHITA BRANCH

KANSAS DRILLERS LOG

API No. 15 — 125 — 22,093
 County Number

S. 3 T. 34S R. 14E W
 Loc. NW SW NW
 County Montgomery

Operator
 Layton Oil Company

Address
 Box: 263, Independence, KS 67301

Well No. V-50 Lease Name Gullick

Footage Location
 990 feet from ~~XX~~ (S) line 220 feet from ~~XXX~~ (W) line NW/4

Principal Contractor Layton Oil Company Geologist

Spud Date 3-21-79 Total Depth 720 P.B.T.D. 713

Date Completed 6-6-79 Oil Purchaser Producers Group, Inc.

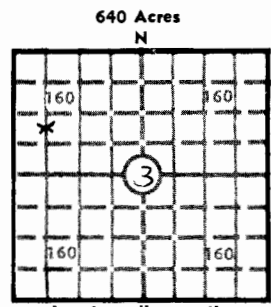

Elev.: Gr. _____
 DF _____ KB _____

CASING RECORD

Report of all strings set — surface, intermediate, production, etc.

Purpose of string	Size hole drilled	Size casing set (in O.D.)	Weight lbs/ft.	Setting depth	Type cement	Sacks	Type and percent additives
Surface	8 3/4"	7"		90	Portland	7	
Production	6 1/4"	4 1/2"		713	Portland	80	

LINER RECORD

PERFORATION RECORD

Top, ft.	Bottom, ft.	Sacks cement	Shots per ft.	Size & type	Depth interval
			2	3 1/2 Alum Jet	674-686

Size	Setting depth	Packer set at

ACID, FRACTURE, SHOT, CEMENT SQUEEZE RECORD

Amount and kind of material used	Depth interval treated
Fraced with 2000# coarse sand 200# rock salt and 130 barrels jelled water	674-686

INITIAL PRODUCTION

Date of first production	Producing method (flowing, pumping, gas lift, etc.)
RATE OF PRODUCTION PER 24 HOURS	Oil Gas Water Gas-oil ratio
Disposition of gas (vented, used on lease or sold)	Producing interval(s)
	674-686

INSTRUCTIONS: As provided in KCC Rule 82-2-125, within 90 days after completion of a well, one completed copy of this Drillers Log shall be transmitted to the State Geological Survey of Kansas, 4150 Monroe Street, Wichita, Kansas 67209. Copies of this form are available from the Conservation Division, State Corporation Commission, 3830 So. Meridian (P.O. Box 17027), Wichita, Kansas 66217. Phone AC 316-522-2206. If confidential custody is desired, please note Rule 82-2-125. Drillers Logs will be on open file in the Oil and Gas Division, State Geological Survey of Kansas, Lawrence, Kansas 66044.

Operator
Layton Oil Company

DESIGNATE TYPE OF COMP.: OIL, GAS, DRY HOLE, SWDW, ETC.:

Well No. V-50 Lease Name Gullick OIL

S 3 T 34S R 14E E W

WELL LOG

Show all important zones of porosity and contents thereof; cored intervals, and all drill-stem tests, including depth interval tested, cushion used, time tool open, flowing and shut-in pressures, and recoveries.

SHOW GEOLOGICAL MARKERS, LOGS RUN, OR OTHER DESCRIPTIVE INFORMATION.

FORMATION DESCRIPTION, CONTENTS, ETC.	TOP	BOTTOM	NAME	DEPTH
Soil	0	2		
Clay	2	13		
Sand	13	25		
Shale	25	35		
Lime	35	45		
Shale	45	47		
Hard Sand	47	65		
Shale	65	68		
Lime	68	70		
Shale	70	77		
Sand	77	81		
Shale	81	189		
Lime	189	199		
Shale	199	311		
Sand	311	343		
Shale	343	396		
Lime	396	399		
Sand	399	470		
Shale	470	472		
Sand	472	478		
Shale	478	487		
Lime	487	488		
Shale	488	490		
Sand	490	520		
Sandy Shale	520	654		
Lime	654	667		
Sand (Wayside)	667	690		
Shale	690	720 TD		

USE ADDITIONAL SHEETS, IF NECESSARY, TO COMPLETE WELL RECORD.

Date Received

Marsha E. Wohltman
Signature

Assistant Eng.
Title

9-28-79
Date