

STATE CORPORATION COMMISSION OF KANSAS  
OIL & GAS CONSERVATION DIVISION

WELL COMPLETION OR RECOMPLETION FORM  
ACO-1 WELL HISTORY

DESCRIPTION OF WELL AND LEASE



Operator: License # 4469  
Name KELT ENERGY  
Address 524 N. PENN. Ste. 114  
City/State/Zip Independence, Ks. 67301

Purchaser KOCH IND

Operator Contact Person Jeff Goodrich  
Phone (316) 331-4445

Contractor: License # 9350  
Name Thompson Drilling

Wellsite Geologist  
Phone

Designate Type of Completion

- New Well  Re-Entry  Workover
- Oil  SWD  Temp Abd
- Gas  Inj  Delayed Comp.
- Dry  Other (Core, Water Supply etc.)

If OWWO: old well info as follows:

Operator  
Well Name  
Comp. Date ..... Old Total Depth.....

WELL HISTORY

Drilling Method:

- Mud Rotary  Air Rotary  Cable

7/19/85      7/20/85      5/13/85  
Spud Date      Date Reached TD      Completion Date  
580'      875'  
Total Depth      PBTB

Amount of Surface Pipe Set and Cemented at 20 feet  
Multiple Stage Cementing Collar Used?  Yes  No  
If yes, show depth set..... feet  
If alternate 2 completion, cement circulated  
from 875 feet depth to surface w/.....SX cmt

API NO. 15-125-27,907  
County Montgomery  
SE SE SW Sec. 16 Twp. 34 Rge. 14  East  West

495 Ft North from Southeast Corner of Section  
3135 Ft West from Southeast Corner of Section  
(Note: Locate well in section plat below)

Lease Name Ferguson Well # KF-2  
Field Name Whyside Havana

Producing Formation WEISER

Elevation: Ground 530 KB 532  
Section Plat

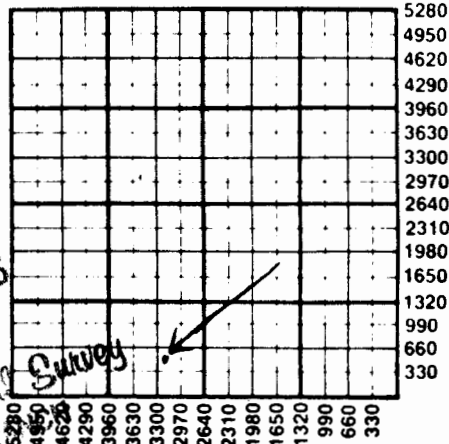

NOV 20 1985

WATER SUPPLY INFORMATION

Disposition of Produced Water:  Disposal  Repressuring  
Docket # F 10,945

Questions on this portion of the ACO-1 call:  
Water Resources Board (913) 296-3717

Source of Water:  
Division of Water Resources Permit #.....  
 Groundwater.....Ft North from Southeast Corner (Well) .....Ft West from Southeast Corner of Sec Twp Rge  East  West  
 Surface Water.....Ft North from Southeast Corner (Stream, pond etc).....Ft West from Southeast Corner Sec Twp Rge  East  West  
 Other (explain) WATER TRANSFERRED FROM OTHER SAW PITS  
(purchased from city, R.W.D. #)

INSTRUCTIONS: This form shall be completed in duplicate and filed with the Kansas Corporation Commission, 200 Colorado Derby Building, Wichita, Kansas 67202, within 90 days after completion or recompletion of any well. Rule 82-3-130 and 82-3-107 apply.  
Information on side two of this form will be held confidential for a period of 12 months if requested in writing and submitted with the form. See rule 82-3-107 for confidentiality in excess of 12 months.  
One copy of all wireline logs and drillers time log shall be attached with this form. Submit CP-4 form with

SIDE TWO

Operator Name KELT ENERGY Lease Name FERGUSON Well # KE-2

Sec. 16 Twp. 34 Rge. 14  East  West County Montgomery

WELL LOG

INSTRUCTIONS: Show important tops and base of formations penetrated. Detail all cores. Report all drill stem tests giving interval tested, time tool open and closed, flowing and shut-in pressures, whether shut-in pressure reached static level, hydrostatic pressures, bottom hole temperature, fluid recovery, and flow rates if gas to surface during test. Attach extra sheet if more space is needed. Attach copy of log.

Drill Stem Tests Taken  Yes  No  
 Samples Sent to Geological Survey  Yes  No  
 Cores Taken  Yes  No

Formation Description  
 Log  Sample

Name Top Bottom

SEE ATTACHED

SEE ATTACHED

Date of First Production <u>8/13/85</u>	Producing Method <input type="checkbox"/> Flowing <input checked="" type="checkbox"/> Pumping <input type="checkbox"/> Gas Lift <input type="checkbox"/> Other (explain).....				
Estimated Production Per 24 Hours	Oil <u>5</u> Bbls	Gas <u>0</u> MCF	Water <u>68</u> Bbls	Gas-Oil Ratio CFPB	Gravity <u>34.5</u>

METHOD OF COMPLETION

Production Interval

CASING RECORD <input checked="" type="checkbox"/> New <input type="checkbox"/> Used Report all strings set-conductor, surface, intermediate, production, etc.							
Purpose of String	Size Hole Drilled	Size Casing Set (In O.D.)	Weight Lbs/Ft.	Setting Depth	Type of Cement	#Sacks Used	Type and Percent Additives
<u>SURFACE PRODUCTION</u>	<u>10"</u>	<u>7"</u>		<u>30</u>	<u>Portland</u>	<u>7</u>	<u>3% Cal.</u>
	<u>5-5/8"</u>	<u>2-7/8"</u>		<u>875</u>	<u>TYPE A</u>	<u>122</u>	<u>50/50 Flo Seal</u> <u>1 gal. DHC</u>
PERFORATION RECORD				Acid, Fracture, Shot, Cement Squeeze Record			
Shots Per Foot	Specify Footage of Each Interval Perforated			(Amount and Kind of Material Used)		Depth	
<u>2</u>	<u>764-780</u>			<u>60.5% 13/32 sand 95.5% 10/20 SAND</u> <u>6 gal. clay slurry 2.5% water gel</u>			
TUBING RECORD				Liner Run <input type="checkbox"/> Yes <input checked="" type="checkbox"/> No			
Size	Set At	Packer at					
<u>1"</u>	<u>804'</u>	<u>X</u>					

OILFIELD RESEARCH LABORATORIES

P1  
16-34-14e

LOG

Company Kelt Energy, Inc. Lease Ferguson Well No. KF-2

<u>Depth Interval, Feet</u>	<u>Description</u>
	<u>WEISER SANDSTONE</u>
764.0 - 765.4	Sandstone, brown, with scattered carbonaceous partings.
765.4 - 766.0	Sandstone, grayish brown, very shaly, slightly calcareous.
766.0 - 766.4	Sandstone, brown, very shaly.
766.4 - 767.0	Sandstone, brown.
767.0 - 767.9	Sandstone, grayish brown, shaly, slightly calcareous.
767.9 - 769.8	Sandstone, brown.
769.8 - 771.0	Sandstone, light brown, containing vertical fracture.
771.0 - 772.0	Sandstone, light brown, shaly.
772.0 - 773.0	Sandstone, light brown.
773.0 - 774.0	Sandstone, light brown, shaly.
774.0 - 774.6	Sandstone, light brown, with shale partings.

NOV 20 1935

State Geological Survey  
WICHITA BRANCH

RECEIVED  
STATE CORPORATION COMMISSION

NOV 18 1935

CONSERVATION DIVISION  
Wichita, Kansas

P1  
16-34-14e

**Oilfield Research Laboratories**  
**RESULTS OF SATURATION & PERMEABILITY TESTS**

TABLE 1

Company Kelt Energy, Inc. Lease Ferguson Well No. KF-2

Sample No.	Depth, Feet	Porosity Percent	Percent Saturation			Oil Content Bbls. / A. Ft.	Permeability, Millidarcys
			Oil	Water	Total		
1	764.5	21.3	21	43	64	347	86.
2	765.5	11.7	15	81	96	136	0.98
3	766.5	23.1	18	44	62	323	80.
4	767.5	8.5	29	61	90	191	2.0
5	768.5	22.6	24	36	60	421	153.
6	769.5	22.6	27	38	65	473	123.
7	770.5	22.0	18	45	63	307	43.
8	771.6	14.1	16	75	91	175	5.3
9	772.5	19.1	13	60	73	193	18.
10	773.5	14.9	20	63	83	231	2.2
11	774.5	18.7	15	57	72	218	17.

NOV 20 1985  
State Geological Survey  
WICHITA BRANCH

NOV 18 1985  
CONSERVATION DIVISION  
Wichita, Kansas

The Thompson Drilling Co., Inc.  
 125 South 26th Street  
 Independence, Kansas 67301  
 (316) 331-3092

DRILLERS LOG

S. 16 T. 34 R. 14 E  
 W

API No. 15 - 125 - 27,907  
 County Number

Loc. SE SE SW

County Montgomery

640 Acres

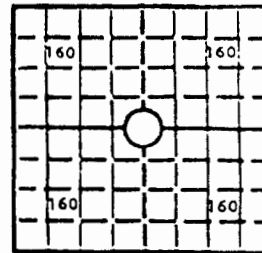

Locate well correctly

Elev.: Gr. \_\_\_\_\_

DF \_\_\_\_\_ KB \_\_\_\_\_

CASING RECORD

NOV 20 1985

Report of all strings set—surface, intermediate, production, etc.

State Geological Survey  
 WICHITA BRANCH

Purpose of string	Size hole drilled	Size casing set (in O.D.)	Weight lbs/ft.	Setting depth	Type of cement	Sacks	Type and percent additives
SURFACE	10"	7"		20	Portland	7	3% Cal.
PRODUCTION	5-5/8						

Circlated By Consolidated

WELL LOG

Core-761-781

Show all important zones of porosity and contents thereof; cored intervals, and all drill-stem tests, including depth interval tested, cushion used, time tool open, flowing and shut-in pressures, and recoveries.

Formation	Top	Btm.	Formation	Top	Btm.	Formation	Top	Btm.
Soil	0	3	Shale	470	568			
Clay	3	20	Lime	568	569			
Lime	20	21	Shale	569	624			
Shale	21	46	Coal	624	626			
H U Sand	46	56	Shale	626	637			
Shale	56	74	Lime	637	638			
Sandy Shale	74	90	Sandy Shale	638	647			
Shale	90	173	Shale	647	652			
Lime	173	241	Lime	652	667			
Sandy Shale	241	249	Sandy Shale	667	721			
Sand	249	271	Lime	721	734			
B. Shale	271	273	Shale	734	736			
Sand	273	281	Lime	736	758			
Shale	281	287	Shale	758	760			
Sandy Shale	287	298	Sand (Oil)	760	779			
Sand	298	302	Sand	779	818			
Sandy Shale	302	323	Sandy Shale	818	870			
Shale	323	331	Lime (PINK)	870	880			
Sand	337	386	T.D.	880				
Shale	386	451						
Lime	451	459						
Coal	459	461						
Shale	461	463						
Sand	463	470						

STATE GEOLOGICAL SURVEY

NOV 18 1985