

State Geological Survey

WICHITA BRANCH

KANSAS DRILLERS LOG

API No. 15 — 125 — 21,795
 County Number

Operator
Gator Oil Company

Address
P. O. Box 1628 Lake Worth, Florida 33460

Well No. #1-G Lease Name McConnell North

Footage Location
660 feet from (S) line 165 feet from (E) line SW

Principal Contractor CANEY Valley Drilling Geologist _____

Spud Date 7-20-78 Total Depth 550 P.B.T.D. _____

Date Completed 7-21-78 Oil Purchaser _____

15-125-21795

S. 17 T. 34 R. 15 E
 Loc. 165' FEL & 660' FSL SW
 County Montgomery

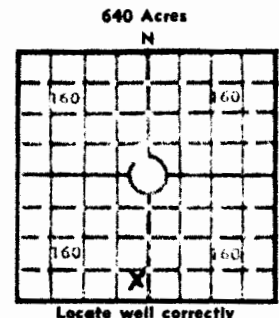

Elev.: Gr. _____
 DF _____ KB _____

CASING RECORD

Report of all strings set — surface, intermediate, production, etc.

Purpose of string	Size hole drilled	Size casing set (in O.D.)	Weight lbs./ft.	Setting depth	Type cement	Sacks	Type and percent additives
<u>SURFACE</u>	<u>9"</u>	<u>6 1/4"</u>		<u>50</u>	<u>PORTLAND</u>	<u>10</u>	<u>3% CAL</u>
<u>PRODUCTION</u>	<u>5 1/4"</u>	<u>2 1/2"</u>		<u>547</u>			<u>CIRCULATE</u>

LINER RECORD

PERFORATION RECORD

Top, ft.	Bottom, ft.	Sacks cement	Shots per ft.	Size & type	Depth interval
			<u>1</u>	<u>-</u>	<u>492-510</u>

TUBING RECORD

Size	Setting depth	Packer set at

ACID, FRACTURE, SHOT, CEMENT SQUEEZE RECORD

Amount and kind of material used	Depth interval treated
<u>5000 # SAND & WATER</u>	<u>492-510</u>

INITIAL PRODUCTION

Date of first production <u>7-21-78</u>	Producing method (flowing, pumping, gas lift, etc.) <u>PUMPING</u>				
RATE OF PRODUCTION PER 24 HOURS	Oil <u>2</u> bbls.	Gas MCF	Water bbls.	Gas-oil ratio	CFPB
Disposition of gas (vented, used on lease or sold)			Producing interval (s) <u>492-510</u>		

INSTRUCTIONS: As provided in KCC Rule 82-2-125, within 90 days after completion of a well, one completed copy of this Drillers Log shall be transmitted to the State Geological Survey of Kansas, 4150 Monroe Street, Wichita, Kansas 67209. Copies of this form are available from the Conservation Division, State Corporation Commission, 3830 So. Meridian (P.O. Box 17027), Wichita, Kansas 66217. Phone AC 316-522-2206. If confidential custody is desired, please note Rule 82-2-125. Drillers Logs will be on open file in the Oil and Gas Division, State Geological Survey of Kansas, Lawrence, Kansas 66044.

Operator **GATOR Oil Company** DESIGNATE TYPE OF COMP.: OIL, GAS, DRY HOLE, SWDW, ETC.:
 Well No. **18** Lease Name **McConnell North** **Oil**

S **17** T **34** R **15** E

WELL LOG

Show all important zones of porosity and contents thereof; cored intervals, and all drill-stem tests, including depth interval tested, cushion used, time tool open, flowing and shut-in pressures, and recoveries.

SHOW GEOLOGICAL MARKERS, LOGS RUN, OR OTHER DESCRIPTIVE INFORMATION.

FORMATION DESCRIPTION, CONTENTS, ETC. TOP BOTTOM NAME DEPTH

WELL LOG

Show all important zones of porosity and contents thereof; cored intervals, and all drill-stem tests, including depth interval tested, cushion used, time tool open, flowing and shut-in pressures, and recoveries.

Full recovery
Core # 1 494'-514'

Formation	Top	Btm.	Formation	Top	Btm.	Formation	Top	Btm.
Dirt	0	4						
Clay	4	5						
Lime	5	16						
Shale	16	20						
Sand	20	85						
Coal	85	89						
Shaley sand	89	106						
Sandy shale	106	126						
Sand	126	153						
Lime	153	157						
Sand	157	169						
Lime	169	179						
Shaley sand	179	206						
Sandy shale	206	314						
Lime	314	349						
Shale	349	448						
Lime	448	450						
Shale	450	465						
Cap lime	465	476						
Shale	476	491						
Sand	491	494						
Core # 1	494	514						
Shale	514	547						
Lime	547	550	T. D.					

MISCH-COFFEYVILLE

USE ADDITIONAL SHEETS, IF NECESSARY, TO COMPLETE WELL RECORD.

Date Received

Geo. A. Haller
Signature
Vice Pres
Title
8-17-78
Date