

8122187

KCC
JML

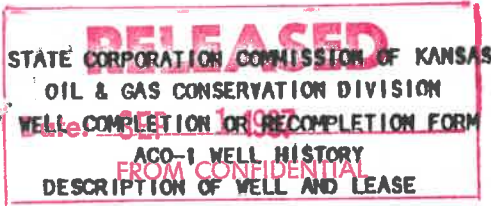

125-28,373

API NO. 15-.....

Montgomery

County.....

SW NE 20 34S 15 X East
..... Sec..... Twp..... Rge..... West

2970
2310 Ft North from Southeast Corner of Section
..... Ft West from Southeast Corner of Section
(Note: Locate well in section plat below)

Lease Name..... McConnell East Well #..... B-5

Field Name..... Tyro

Producing Formation..... Bartlesville

Elevation: Ground..... KB.....

Section Plat

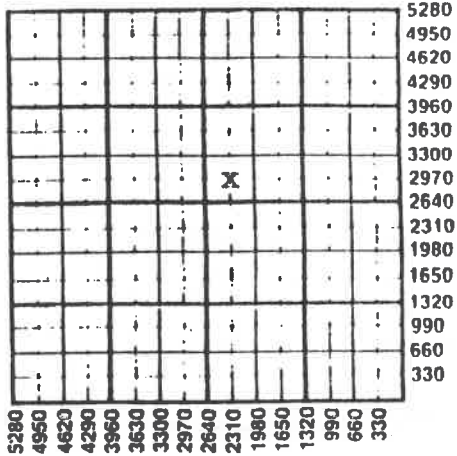

WATER SUPPLY INFORMATION

Disposition of Produced Water: _____ Disposal
Docket # _____ Repressuring

Questions on this portion of the ACO-1 call:
Water Resources Board (913) 296-3717

Source of Water:
Division of Water Resources Permit #.....

Groundwater.....Ft North from Southeast Corner
(Well)Ft West from Southeast Corner of
Sec Twp Rge East West

Surface Water.....Ft North from Southeast Corner
(Stream, pond etc).....Ft West from Southeast Corner
Sec Twp Rge East West

X Other (explain) drilled w/ lease salt water
(purchased from city, R.W.D. #)

Operator: License # 04905
Name K. C. Crude, Inc.
Address 6600 College Blvd.
..... Suite 320
City/State/Zip Overland Park, KS 66211

Purchaser Enron Oil Trading and
Transportation 21022

Operator Contact Person Steve Allee
Phone 913-345-8000

Contractor: License # 5675
Name McPherson Drilling

Wellsite Geologist Steve Allee
Phone 913-345-8000

Designate Type of Completion
X New Well _____ Re-Entry _____ Workover
Oil _____ SWD _____ Temp Abd
X Gas _____ Inj _____ Delayed Comp.
Dry _____ Other (Core, Water Supply etc.)

If OWNED: old well info as follows:
Operator
Well Name
Comp. Date Old Total Depth.....

WELL HISTORY

Drilling Method:
X Mud Rotary _____ Air Rotary _____ Cable
6-27-86 7-2-86 7-9-86
Spud Date Date Reached TD Completion Date
1184.6'
Total Depth PBTD

Amount of Surface Pipe Set and Cemented at 21 feet
Multiple Stage Cementing Collar Used? Yes X No
If yes, show depth set.....feet
If alternate 2 completion, cement circulated
from.....feet depth to.....w/.....SX cmt
Cement Company Name
Invoice #

INSTRUCTIONS: This form shall be completed in triplicate and filed with the Kansas Corporation Commission, 200 Colorado Derby Building, Wichita, Kansas 67202, within 120 days of the spud date of any well. Rule 82-3-130, 82-3-107 and 82-3-106 apply. Information on side two of this form will be held confidential for a period of 12 months if requested in writing and submitted with the form. See rule 82-3-107 for confidentiality in excess of 12 months. One copy of all wireline logs and drillers time log shall be attached with this form. Submit CP-4 form with all plugged wells. Submit CP-111 form with all temporarily abandoned wells.

SIDE TWO

Operator Name K. C. Crude, Inc. Lease Name..... McConnell Well #..... B-5

Sec..... 20 Twp..... 34S Rge..... 15 East West County..... Montgomery

WELL LOG

INSTRUCTIONS: Show important tops and base of formations penetrated. Detail all cores. Report all drill stem tests giving interval tested, time tool open and closed, flowing and shut-in pressures, whether shut-in pressure reached static level, hydrostatic pressures, bottom hole temperature, fluid recovery, and flow rates if gas to surface during test. Attach extra sheet if more space is needed. Attach copy of log.

Drill Stem Tests Taken Yes No
 Samples Sent to Geological Survey Yes No
 Cores Taken Yes No

Formation Description
 Log Sample

Name Top Bottom

see attached sheet

Estimated Production Per 24 Hours	Oil	Gas	Water	Gas-Oil Ratio	Gravity
0	0 Bbls	30 MCF	0 Bbls	CFPB	

METHOD OF COMPLETION

Disposition of gas: Vented Sold Used on Lease
 Open Hole Perforation
 Other (Specify)

Open hole
 1136' to 1184.6'

CASING RECORD New Used

Report all strings set-conductor, surface, intermediate, production, etc.

Purpose of String	Size Hole Drilled	Size Casing Set (In O.D.)	Weight Lbs/Ft.	Setting Depth	Type of Cement	#Sacks Used	Type and Percent Additives
Surface	9 1/2"	7"	15	21'	Portland	4	
Production	6 1/4"	4 1/2"	9.5	1136'	50/50 PdZ	110	

PERFORATION RECORD

Acid, Fracture, Shot, Cement Squeeze Record
 (Amount and Kind of Material Used) Depth

Shots Per Foot	Specify Footage of Each Interval Perforated	Depth
	Open hole 1136' to 1184.6'	

TUBING RECORD Size Set At Packer at Liner Run Yes No

Date of First Production | Producing Method
 Shut in 8/2/86 | Flowing Pumping Gas Lift Other (explain).....

STATE CORPORATION COMMISSION OF KANSAS
OIL & GAS CONSERVATION DIVISION
WELL COMPLETION OR RECOMPLETION FORM
ACO-1 WELL HISTORY
DESCRIPTION OF WELL AND LEASE

Operator: License # 4905
Name H.C. Grude, INC.
Address 6520 W. 110th, Suite 106, Overland Park, KS
City/State/Zip 66211

Purchaser Great American Systems, Inc
GAS & Sahara, for Oil

Operator Contact Person Larry W. Brown
Phone 913-345-8000

Contractor: License #
Name McPherson Drilling Co.

Wellsite Geologist Steve Allie
Phone NA

Designate Type of Completion

New Well Re-Entry Workover
 Oil SWD Temp Abd
 Gas Inj Delayed Comp.
 Dry Other (Core, Water Supply etc.)

If ONWG: old well info as follows:

Operator
Well Name
Comp. Date
Old Total Depth

WELL HISTORY

Drilling Method: Combination
 Mid Rotary Air Rotary Cable

6/27/86 7/2/86 7/11/86
Spud Date Date Reached TD Completion Date
1130 open hole to 1185'
Total Depth

Amount of Surface Pipe Set and Cemented at 26 feet
Multiple Stage Cementing Collar Used? Yes No

If yes, show depth set.....feet
If alternate 2 completion, cement circulated from 1130 feet depth to Surface 10 SX cmt

Cement Company Name Consolidated
Invoice # 65388

API No. 15-.....125-28,373
County Montgomery
SW NE Sec 20 Twp 34 Rge 15 East West

2970... Ft North from Southeast Corner of Section
2310... Ft West from Southeast Corner of Section
(Note: Locate well in section plat below)

Lease Name McCannell East Well # B-5

Field Name Jefferson - Sycamore/Tyro

Producing Formation Bartlesville

Elevation: Ground.....KB.....

Section Plat

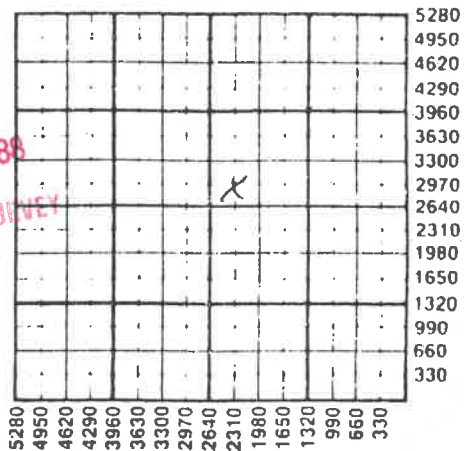

APR 10 1988
KANSAS GEOLOGICAL SURVEY
WICHITA BRANCH

WATER SUPPLY INFORMATION

Disposition of Produced Water: Disposal
Docket # Repressuring

Questions on this portion of the ACO-1 call:

Water Resources Board (913) 296-3717

Source of Water:
Division of Water Resources Permit #.....

Groundwater.....Ft North from Southeast Corner
(Well)Ft West from Southeast Corner of
Sec Twp Rge East West

Surface Water.....Ft North from Southeast Corner
(Stream, pond etc).....Ft West from Southeast Corner
Sec Twp Rge East West

Other (explain).....
(purchased from city, R.W.D. #)

INSTRUCTIONS: This form shall be completed in triplicate and filed with the Kansas Corporation Commission, 200 Colorado Derby Building, Wichita, Kansas 67202, within 120 days of the spud date of any well. Rule 82-3-130, 82-3-107 and 82-3-106 apply. Information on side two of this form will be held confidential for a period of 12 months if requested in writing and submitted with the form. See rule 82-3-107 for confidentiality in excess of 12 months. One copy of all wireline logs and drillers time log shall be attached with this form. Submit CP-4 form with all plugged wells. Submit CP-111 form with all temporarily abandoned wells.

APR 6 1988

Operator Name H. C. Crude, Inc. Lease Name McConnell East Well # B-5

Sec. 20 Twp. 34 Rge. 15 East West County Montgomery

Oil	Gas	Water	Gas-Oil Ratio	Gravity
<u>NA</u>	<u>NA</u>			
Bbls	MCF	Bbls	CFPB	

Estimated Production Per 24 Hours

METHOD OF COMPLETION

Production Interval

Disposition of gas: Vented Sold Open Hole Perforation Other (Specify)

1136-1184

Drill Stem Tests Taken Yes No
 Samples Sent to Geological Survey Yes No
 Cores Taken Yes No

Formation Description

Log Sample

Name	Top	Bottom
Lenape	476	
Altamont	550	
Pawnee	700	
"Oswego"	821	
Base Breezy Hills	904	
Bartlesville	1158	
Bu Base	NA	
E-Log TD	1184.6	

CASING RECORD New Used

Report all strings set-conductor, surface, intermediate, production, etc.

Purpose of String	Size Hole Drilled	Size Casing Set (In O.D.)	Weight Lbs/Ft.	Setting Depth	Type of Cement	#Sacks Used	Type and Percent Additives
Surface	9 1/2"	7"	15	21	Portland	4	NONE
Production	6 1/4"	4 1/2"	9.5	1130	30/50 Poz-Mix	110	gel, Flo-Seal

PERFORATION RECORD

Acid, Fracture, Shot, Cement Squeeze Record

Shots Per Foot	Specify Footage of Each Interval Perforated	(Amount and Kind of Material Used)	Depth
	Open hole completed	4,000 lb	1136-84
	TD 1184.6	10 x 20, 2000 at 8 x 12 Frac Sand 100 gals HCl Ahead (570)	

TUBING RECORD Size 2 7/8 Set At NA ~~Packer at~~ Liner Run Yes No

Date of First Production NA, close to 7-12-86 Producing Method Flowing Pumping Gas Lift Other (explain).....