

KANSAS DRILLERS LOG

S. 36 T. 34 R. 19 ^E_W
 Loc. 1980' FWL & 660' FSL
 County Labette

API No. 15 — 099 — 20,805
 County Number

Operator
Lightning Oil Co.

Address
P.O. Box 6598 San Antonio, Texas 78209

Well No. # 1 Lease Name
Ronald H. Rhodes

Footage Location
460 feet from ~~(S)~~ (S) line 1980 feet from ~~(E)~~ (W) line

Principal Contractor
Nance Drilling Co. Geologist
John W. Stewart

Spud Date
May 12, 1978 Total Depth
988 P.B.T.D.

Date Completed
May 24, 1978 Oil Purchaser

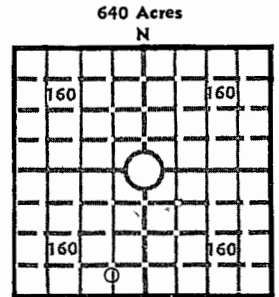

Elev.: Gr. 912
 DF _____ KB _____

CASING RECORD

Report of all strings set—surface, intermediate, production, etc.

Purpose of string	Size hole drilled	Size casing set (in O.D.)	Weight lbs/ft.	Setting depth	Type cement	Sacks	Type and percent additives
Surface Csg.	9-5/8	7	.17	85	Common	215	—

LINER RECORD

PERFORATION RECORD

Top, ft.	Bottom, ft.	Sacks cement	Shots per ft.	Size & type	Depth interval

TUBING RECORD

Size	Setting depth	Packer set at

ACID, FRACTURE, SHOT, CEMENT SQUEEZE RECORD

Amount and kind of material used	Depth interval treated

INITIAL PRODUCTION

Date of first production		Producing method (flowing, pumping, gas lift, etc.)			
RATE OF PRODUCTION PER 24 HOURS	Oil	Gas	Water	Gas-oil ratio	
	bbls.	MCF	bbls.	CFPB	
Disposition of gas (vented, used on lease or sold)			Producing interval (s)		

INSTRUCTIONS: As provided in KCC Rule 82-2-125, within 90 days after completion of a well; one completed copy of this Drillers Log shall be transmitted to the State Geological Survey of Kansas, 4150 Monroe Street, Wichita, Kansas 67209. Copies of this form are available from the Conservation Division, State Corporation Commission, 3830 So. Meridian (P.O. Box 17027), Wichita, Kansas 66217. Phone AC 316-522-2206. If confidential custody is desired, please note Rule 82-2-125. Drillers Logs will be on an open file in the Oil and Gas Division, State Geological Survey of Kansas, Lawrence, Kansas 66044.

Operator

Lightning Oil Company

DESIGNATE TYPE OF COMP.: OIL, GAS, DRY HOLE, SWDW, ETC.:

Well No.

1

Lease Name

Ronald H. Rhodes

Dry Hole

S 36 T 34 R 19 E W

WELL LOG

Show all important zones of porosity and contents thereof; cored intervals, and all drill-stem tests, including depth interval tested, cushion used, time tool open, flowing and shut-in pressures, and recoveries.

SHOW GEOLOGICAL MARKERS, LOGS RUN, OR OTHER DESCRIPTIVE INFORMATION.

FORMATION DESCRIPTION, CONTENTS, ETC.	TOP	BOTTOM	NAME	DEPTH
Overburden	0	8		
Oswego Lime	8	40		
Black Shale	40	47		
Oswego Lime	47	69		
Black Shale	69	71		
Oswego Lime	71	74		
Grey Shale	74	150		
Grey Shale	150	196		
Lime	196	209		
Coal	209	219		
Dk Grey Shale (Streaks of Lime)	219	291		
Grey Shale	291	318		
Black Shale	318	346		
Grey Sandy Shale (Lime Streaks)	346	419		
Black Shale	419	434		
Grey Sandy Shale (Streaks of Lime)	434	469		
Grey Shale Sand & Lime	469	549		
Dk Grey Shale	549	576		
Sandy Grey Shale	576	620		
Miss Chat	620	678		
Chat & Lime	678	729		
Grey Lime	729	742		
Sand	742	763		
Lime and Chat	763	832		
Dk Lime & Chat	832	861		
Lime & Chat	861	892		
Grey Lime & Chat	892	950		
Grey Green Shale	950	957		
Grey Lime Sand & Chat	957	974		
Dk Brown Shaley Lime	974	986		
Brown Dolomite, Arbuckle	986	988		
TD	988			

USE ADDITIONAL SHEETS, IF NECESSARY, TO COMPLETE WELL RECORD.

Date Received

Signature

Geologist

Title

June 19, 1978

Date