

Released 1-7-82
CONFIDENTIAL

KANSAS

**WELL COMPLETION REPORT AND
 DRILLER'S LOG**

API No. 15 — 099 — 21,277
 County Number

S. 6 T. 34S R. 20 E
 XX

Loc. NW NW NE

County Labette

Operator
 Jeff Kephart/Aiken-Poston

Address
 R. R. #1, Box 68A, Thayer, Ks. 66776

Well No. 1 Lease Name M. Gossard

Footage Location
 550 feet from (N) line 1150 feet from (E) (W) line

Principal Contractor Kephart Drilling, Inc. Geologist

Spud Date 8/8/80 Date Completed 8/15/80 Total Depth 524' P.B.T.D.

Directional Deviation Oil and/or Gas Purchaser

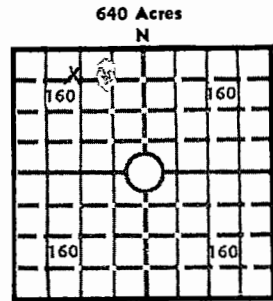

Elev.: Gr. 860'

DF: - KB: -

CASING RECORD

Report of all strings set — surface, intermediate, production, etc.

Purpose of string	Size hole drilled	Size casing set (in O.D.)	Weight lbs/ft.	Setting depth	Type cement	Sacks	Type and percent additives
		7"		85'			

LINER RECORD

PERFORATION RECORD

Top, ft.	Bottom, ft.	Sacks cement	Shots per ft.	Size & type	Depth interval

TUBING RECORD

Size	Setting depth	Packer set at

ACID, FRACTURE, SHOT, CEMENT SQUEEZE RECORD

Amount and kind of material used	Depth interval treated

INITIAL PRODUCTION

Date of first production	Producing method (flowing, pumping, gas lift, etc.)				
RATE OF PRODUCTION PER 24 HOURS	Oil	Gas	Water	Gas-oil ratio	
	bbis.	MCF	bbis.	CFPB	
Disposition of gas (vented, used on lease or sold)			Producing interval (s)		

INSTRUCTIONS: As provided in KCC Rule 82-2-125, within 90 days after completion of a well, one completed copy of this Drillers Log shall be transmitted to the State Geological Survey of Kansas, 4150 Monroe Street, Wichita, Kansas 67209. Copies of this form are available from the Conservation Division, State Corporation Commission, 245 No. Water, Wichita, Kansas 67202. Phone AC 316-522-2206. If confidential custody is desired, please note Rule 82-2-125. Drillers Logs will be on open file in the Oil and Gas Division, State Geological Survey of Kansas, Lawrence, Kansas 66044.

Operator Aiken/Poston/Kephart		DESIGNATE TYPE OF COMP.: OIL, GAS, DRY HOLE, SWDW, ETC.:
Well No. 1	Lease Name M. Gossard	Dry Hole
S 6 T 34 R 20 E W		

WELL LOG

Show all important zones of porosity and contents thereof; cored intervals, and all drill-stem tests, including depth interval tested, cushion used, time tool open, flowing and shut-in pressures, and recoveries.

SHOW GEOLOGICAL MARKERS, LOGS RUN, OR OTHER DESCRIPTIVE INFORMATION.

FORMATION DESCRIPTION, CONTENTS, ETC.	TOP	BOTTOM	NAME	DEPTH
Cored interval with poorly developed sands and marginal oil shows.	410'	487'	Base Oswego	Above 180' (top of log)
			Bartlesville Sd	422'
			Warren Sd	453'
USE ADDITIONAL SHEETS, IF NECESSARY, TO COMPLETE WELL RECORD.				

Date Received	<i>Jeff Kephart</i> Signature
	<i>driller</i> Title
	<i>12-8-80</i> Date