

KANSAS

WELL COMPLETION REPORT AND
DRILLER'S LOG

API No. 15 — 099 — 21,283
County Number

S. 31 T. 34 R. 20 E
State Geological Survey
County Labette
1600' FSL of SE 1/4
2240' FE (KCC Record)

Operator
S & S Oil Company

Address
Box 304 Oswego, Kansas

Well No. 2 Lease Name Ira Goldsmith

Footage Location 1600' FSL 400' FWL
feet from (N) (S) line feet from (E) (W) line

Principal Contractor Blazer Drilling Company Geologist Bill Kardos

Spud Date 9-20-80 Date Completed 9-23-80 Total Depth 628' P.B.T.D. N/A

Directional Deviation None Oil and/or Gas Purchaser None

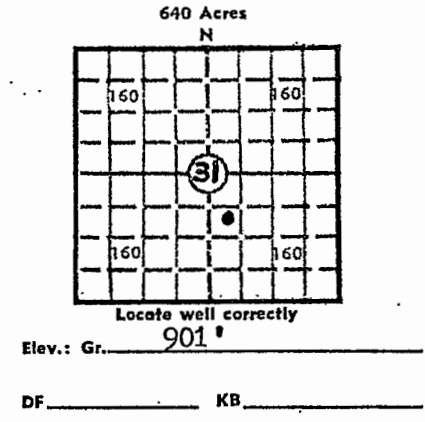

CASING RECORD

Report of all strings set — surface, intermediate, production, etc.

Purpose of string	Size hole drilled	Size casing set (in O.D.)	Weight lbs/ft.	Setting depth	Type cement	Sacks	Type and percent additives
Surface	8 1/2	7"	14	55'	Portland	10	None

LINER RECORD

PERFORATION RECORD

Top, ft.	Bottom, ft.	Sacks cement	Shots per ft.	Size & type	Depth interval

TUBING RECORD

Size	Setting depth	Packer set at

ACID, FRACTURE, SHOT, CEMENT SQUEEZE RECORD

Amount and kind of material used	Depth interval treated
None	

INITIAL PRODUCTION

Date of first production None Producing method (flowing, pumping, gas lift, etc.) _____

RATE OF PRODUCTION PER 24 HOURS	Oil bbls.	Gas MCF	Water bbls.	Gas-oil ratio CFPB

Disposition of gas (vented, used on lease or sold) _____ Producing interval (s) None

INSTRUCTIONS: As provided in KCC Rule 82-2-125, within 90 days after completion of a well, one completed copy of this Drillers Log shall be transmitted to the State Geological Survey of Kansas, 4150 Monroe Street, Wichita, Kansas 67209. Copies of this form are available from the Conservation Division, State Corporation Commission, 245 No. Water, Wichita, Kansas 67202. Phone AC 316-522-2206. If confidential custody is desired, please note Rule 82-2-125. Drillers Logs will be on open file in the Oil and Gas Division, State Geological Survey of Kansas, Lawrence, Kansas 66044.

Operator S & S Oil Company DESIGNATE TYPE OF COMP.: OIL, GAS, DRY HOLE, SWDW, ETC.:

Well No. 2 Lease Name Ira Goldsmith Dry

s 31 T 34 R 20 E

WELL LOG
 Show all important zones of porosity and contents thereof; cored intervals, and all drill-stem tests, including depth interval tested, cushion used, time tool open, flowing and shut-in pressures, and recoveries. SHOW GEOLOGICAL MARKERS, LOGS RUN, OR OTHER DESCRIPTIVE INFORMATION.

FORMATION DESCRIPTION, CONTENTS, ETC.	TOP	BOTTOM	NAME	DEPTH
Overburden	0	9		
Lime	9	35		
Dark shale	35	44		
Lime	44	67		
Gray sand	67	78		
Gray sand	78	155		
Gray sand	155	161		
Gray shale	161	174		
Sandy shale	174	179		
Gray shale	179	190		
Lime	190	196		
Gray shale	196	278		
Lime	278	280		
Gray shale	280	283		
Gray sand	283	291		
Gray shale	291	325		
Sandy shale	325	331		
Gray shale	331	354		
Gray sand	354	357		
Dark sand	357	365	Barts.	
Gray shale streaks of lime	365	615	Top Miss.	
Miss. lime	615	628	T.D.	
		628		

USE ADDITIONAL SHEETS, IF NECESSARY, TO COMPLETE WELL RECORD.

Date Received _____
 Signature Rudy Schreppel Jr.
 Co-Owner _____
 Title _____
 Date 11-21-80