

IMPORTANT
 Kans. Geo. Survey request
 samples on this well.

JUL

KANSAS DRILLERS LOG

S. 32 T. 34 R. 20 E

API No. 15 — 099 — 20,837
 County Number

Operator
 S & S Oil Co.

State Geological Survey
 WICHITA BRANCH

3240' FEL & 350' FSL SW
 3240' FEL (KCC records)
 County Labette

Address
 Box 304 Oswego, Kansas 67356

Well No. #2 Lease Name Mike Hahn

Footage Location 350' FSL 600' FEL
 feet from (N) (S) line feet from (E) (W) line

Principal Contractor Nance Drilling Company Geologist Bill Kardos

Spud Date 9-19-78 Total Depth 625' P.B.T.D. N/A

Date Completed 9-21-78 Oil Purchaser N^Une

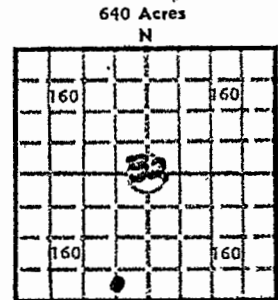

Locate well correctly
 Elev.: Gr. 870'

DF _____ KB _____

CASING RECORD

Report of all strings set—surface, intermediate, production, etc.

Purpose of string	Size hole drilled	Size casing set (in O.D.)	Weight lbs/ft.	Setting depth	Type cement	Sacks	Type and percent additives
Surface	8 1/2	7"	14	50'	Portland	10	None

LINER RECORD

PERFORATION RECORD

Top, ft.	Bottom, ft.	Sacks cement	Shots per ft.	Size & type	Depth interval

TUBING RECORD

Size	Setting depth	Packer set at

ACID, FRACTURE, SHOT, CEMENT SQUEEZE RECORD

Amount and kind of material used	Depth interval treated
None	

INITIAL PRODUCTION

Date of first production		Producing method (flowing, pumping, gas lift, etc.)			
RATE OF PRODUCTION PER 24 HOURS	Oil bbls.	Gas MCF	Water bbls.	Gas-oil ratio	CFPB
Disposition of gas (vented, used on lease or sold)			Producing interval(s) None		

INSTRUCTIONS: As provided in KCC Rule 82-2-125, within 90 days after completion of a well, one completed copy of this Drillers Log shall be transmitted to the State Geological Survey of Kansas, 4150 Monroe Street, Wichita, Kansas 67209. Copies of this form are available from the Conservation Division, State Corporation Commission, 3830 So. Meridian (P.O. Box 17027), Wichita, Kansas 66217. Phone AC 316-522-2206. If confidential custody is desired, please note Rule 82-2-125. Drillers Logs will be on open file in the Oil and Gas Division, State Geological Survey of Kansas, Lawrence, Kansas 66044.

Operator S & S Oil Company DESIGNATE TYPE OF COMP.: OIL, GAS, DRY HOLE, SWDW, ETC.:

Well No. 2 Lease Name Mike Hahn Dry

S 32 T 34 R 20 E W

WELL LOG

Show all important zones of porosity and contents thereof; cored intervals, and all drill-stem tests, including depth interval tested, cushion used, time tool open, flowing and shut-in pressures, and recoveries.

SHOW GEOLOGICAL MARKERS, LOGS RUN, OR OTHER DESCRIPTIVE INFORMATION.

FORMATION DESCRIPTION, CONTENTS, ETC.	TOP	BOTTOM	NAME	DEPTH
Overburden	0	7		
Black shale	7	12		
Gray lime	12	38		
Gray shale	38	125		
Brown sand	125	152		
Gray shale	152	165		
Lime	165	169		
Gray shale	169	172		
Black shale	172	175		
Gray shale	175	250		
Gray sand	250	262		
Gray shale	262	310		
Black shale	310	315		
Lgt. gray sandy shale	315	317		
Dark sand	317	325	Barts.	
Gray shale	325	329		
Gray sand	329	340		
Gray shale	340	385		
Brown sand	385	395		
Gray shale	395	593		
M		593	Top Miss.	
Miss. lime	593	625		
		625	T.D.	

USE ADDITIONAL SHEETS, IF NECESSARY, TO COMPLETE WELL RECORD.

Date Received	<i>Rudy Schappel Jr.</i>
	Signature
	Co-Owner
	Title
	11-21-80
	Date