

**F.W. MORGAN**  
GEOLOGIST

305 S. WASHINGTON  
ELDORADO, KANSAS 67042

Oct. 21, 1984

(316) 263-0134  
ELDORADO (316) 321-1463

Razook Oil Co.  
R. F. D. # 2  
Augusta, Kansas, 67010

Re; No 3 Born "A"  
Sec. 33-34S-5E  
Cowley County, Ks.

Gentlemen;

Enclosed is my geological log on the above listed well. We found 32 feet of Cleveland Sand from 2581 feet to 2613 feet. The Sand was porous and had good shows of oil and gas from 2584 feet to 2613 feet. It is about 14 to 16 feet thinner than the sand in No. 2-B, but the sand was lost off the bottom in which no shows were found in the 2-B. Therefore, the net pay of oil bearing sand is approximately the same.

The top of the Cleveland Sand is a (-1477). This is 12 feet lower than No. 1-B and 2 feet higher than No. 2-B.

Stalnaker Sand porosity was found from 1947' to 2051'. Layton Sand Porosity was found from 2249' to 2274', 2300' to 2357', and from 2398' to 2450'.

Casing was run and cemented to 2674' to test the Cleveland Sand.

Sincerely,

  
F. W. Morgan





LAUGHLIN-SIMMONS & CO. OF KANSAS, INC.

OIL FIELD SURVEYING  
1337 NORTH MERIDIAN, SUITE 2 (316) 943-5351  
WICHITA, KANSAS 67203

KG917841

INVOICE NO.

JIMMY RAZOOK

OPERATOR

3 B

NO

Born

FARM

Cowley

COUNTY

33

S

34s

T

5e

R

1700' FSL 1700' FEL of Section

LOCATION

ELEVATION: 1099 gr

JIMMY RAZOOK  
R. R. 4 Box 102  
Augusta, Kansas 67010

AUTHORIZED BY

SCALE: 1" = 1000'

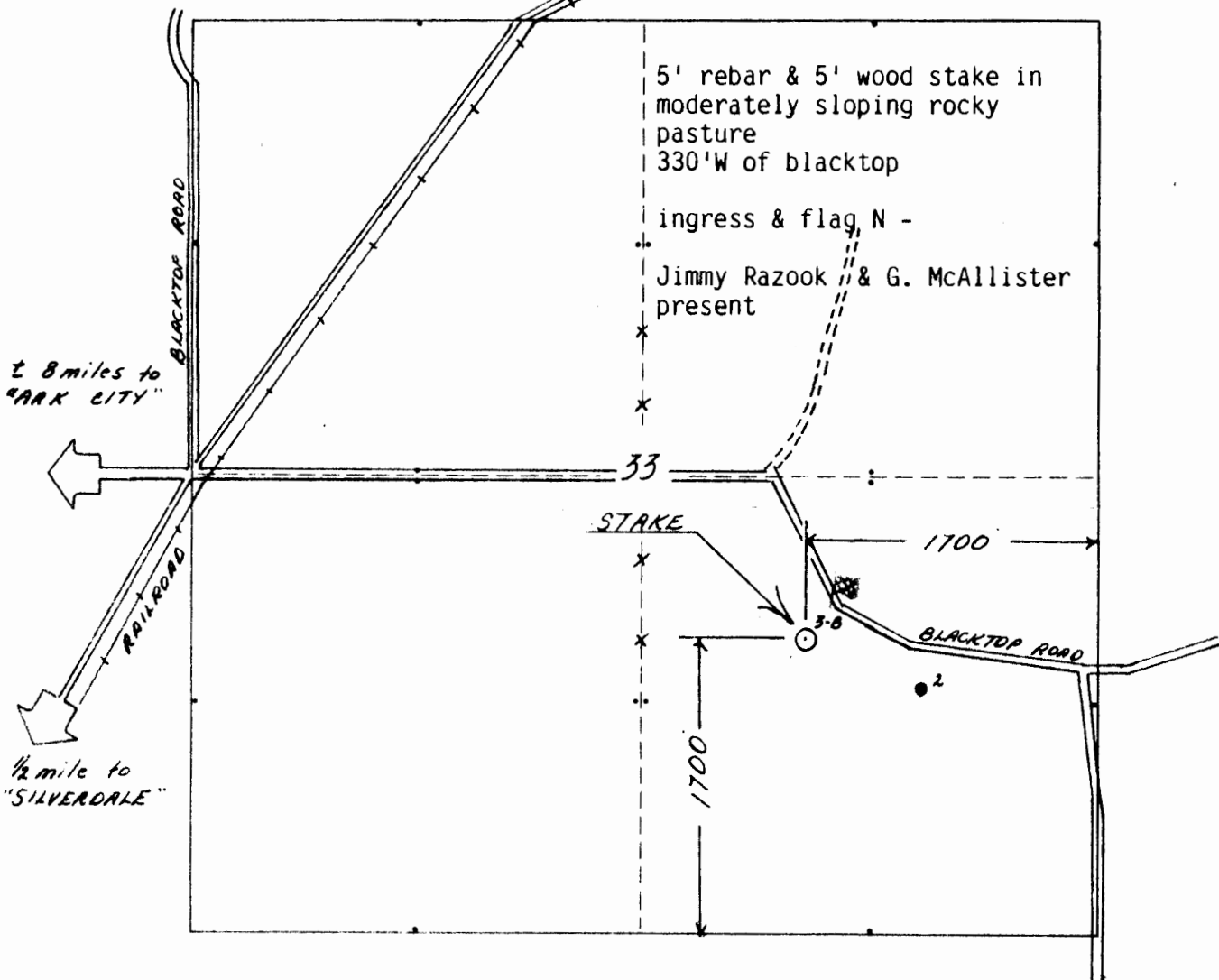

CARD MUST BE TYPED

# NOTICE OF INTENTION TO DRILL

CARD MUST BE SIGNED

Starting Date: 9-25-84

API Number is 035-23,472

OPERATOR: License # 5199

SE/4 Sec 33 Twp 34 S. Rge 5

Name: RAZOOK OIL

1700 Ft North from Southeast (corner of Section 1700 Ft West from Southeast (corner of Section

Address: R.R. #4, Box 102

1700 (water: Lease well on Section Plat on reverse side)

(by State/Zip): Augusta, KS 67010

Nearest lease or salt boundary line: 1700

(contact Person): JIMMY RAZOOK

County: Cowley

Phone: (316) 775-5631

Lease Name: BORN Well# 3-B

CONTRACTOR: License # 5108

Depth to Bottom of fresh water: 80

Name: McAllister Drilling Co., Inc.

Lowest usable water formation: 3 miles limestone

(In State): Wichita, Kansas

Depth to Bottom of usable water: 200

Well Drilled For: Well Class: Type Equipment:

Surface pipe by Alternate: 1XX 2

Oil  Sand  Infield   Mud Rotary

Conductor pipe if any required: 1099

Gas  In  Pool Ext  Air Rotary

Ground surface elevation: 1099

Oil/W/O  Exp  With  Coker

This Authorization Expires: 5-18-85

If (O/W/O) add well info as follows:

Approved By: 9-18-84

Operator: Well Name: (Camp Date) (Camp Date) (Camp Date)

Ground surface elevation: 1099

Projected Total Depth: 2750

Ground surface elevation: 1099

Projected Formation at TD: Cleveland Sand

Ground surface elevation: 1099

Expected Producing Formations: Cleveland Sand

Ground surface elevation: 1099

certify that we will comply with K.S.A. 86-101, et seq., plus eventually plugging holes to K.C.C. specifications.

Ground surface elevation: 1099

Signature of Operator or Agent: *Jimmy Razook*

Signature of Operator or Agent: *McAllister*

Title: *Agent*

McAllister

REMEMBER TO

SEP 14 1984

Form C-1 684