

**IMPORTANT**  
 Kans. Geo. Survey request  
 samples on this well.

15-125-21924

WICHITA BRANCH

**KANSAS DRILLERS LOG**

API No. 15 — 125 — 21924  
County Number

S. 18 T. 35S R. 15E <sup>E</sup>/<sub>W</sub>  
 Loc. NW/4 NE/4 SW/4  
 County Montgomery

Operator Collins Oil

Address 6740 E. 24th St. Tulsa, Okla. 74129

Well No. # 8C Lease Name Vinson

Footage Location  
2940 feet from N ~~X~~ S line 1520 feet from E ~~X~~ W line

Principal Contractor Dobbie Drilling Co. Geologist L.E. Collins

Spud Date 10-23-78 Total Depth 1475 P.B.T.D. 1410

Date Completed 11-21-78 Oil Purchaser CRA

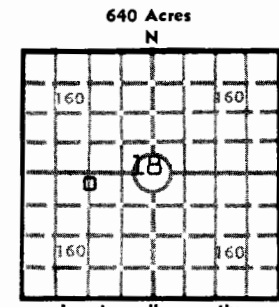

Elev.: Gr. 848 T  
 DF        KB       

**CASING RECORD**

Report of all strings set— surface, intermediate, production, etc.

Purpose of string	Size hole drilled	Size casing set (in O.D.)	Weight lbs/ft.	Setting depth	Type cement	Sacks	Type and percent additives
Surface	9"	7"	17	253	Portland	20	
Production	6 1/4"	4 1/2"	9 1/2	1440	Portland	175	4% gel

**LINER RECORD**

**PERFORATION RECORD**

Top, ft.	Bottom, ft.	Sacks cement	Shots per ft.	Size & type	Depth interval
			4		1216-20

TUBING RECORD		
Size	Setting depth	Packer set at
2"	1220	

**ACID, FRACTURE, SHOT, CEMENT SQUEEZE RECORD**

Amount and kind of material used	Depth interval treated
11,000 lb 20/40	1216-20

**INITIAL PRODUCTION**

Date of first production 11-25/78 Producing method (flowing, pumping, gas lift, etc.) Pumping

RATE OF PRODUCTION PER 24 HOURS	Oil <u>25</u> bbls.	Gas <u>SOME</u> MCF	Water <u>20</u> bbls.	Gas-oil ratio <u>CFPB</u>
---------------------------------	---------------------	---------------------	-----------------------	---------------------------

Disposition of gas (vented, used on lease or sold) vented Producing interval (s) 1214-1229

INSTRUCTIONS: As provided in KCC Rule 82-2-125, within 90 days after completion of a well, one completed copy of this Drillers Log shall be transmitted to the State Geological Survey of Kansas, 4150 Monroe Street, Wichita, Kansas 67209. Copies of this form are available from the Conservation Division, State Corporation Commission, 3830 So. Meridian (P.O. Box 17027), Wichita, Kansas 66217. Phone AC 316-522-2206. If confidential custody is desired, please note Rule 82-2-125. Drillers Logs will be on open file in the Oil and Gas Division, State Geological Survey of Kansas, Lawrence, Kansas 66044.

Operator COLLINS OIL COMPANY

DESIGNATE TYPE OF COMP.: OIL, GAS, DRY HOLE, SWDW, ETC.:  
Oil Well

Well No. 8C

Lease Name Vinson

S 18 T 35S R 15 E  
Wk

**WELL LOG**

Show all important zones of porosity and contents thereof; cored intervals, and all drill-stem tests, including depth interval tested, cushion used, time tool open, flowing and shut-in pressures, and recoveries.

SHOW GEOLOGICAL MARKERS, LOGS RUN, OR OTHER DESCRIPTIVE INFORMATION.

FORMATION DESCRIPTION, CONTENTS, ETC.	TOP	BOTTOM	NAME	DEPTH
Soil	0	3		
Clay	3	17		
Shale	17	22		
Lime/Sand	22	26		
Sand	26	100		
Shale	100	132		
Sand	132	147		
Shale	147	149		
Sand	149	195		
Lime	195	197		
Sand	197	224		
Lime	224	243		
Sand	243	245		
Lime/Sand	245	247		
Soil	247	249		
Lime	249	252		
Shale	252	357		
Lime	357	364		
Sand/Shale	364	383		
Lime	383	388		
Shale	388	486		
Lime	486	487		
Sandy Shale	487	504		
Lime	504	516		
Sandy Shale	516	594		
Lime	594	644		
Shale	644	730		
Lime	730	757		
Shale	757	876		
Lime	876	899		
Shale	899	908		
Lime	908	933		
Shale	933	941		
Lime	941	957		
Shale	957	1203		
Sand	1203	1214	Bartlesville	Dry
Sand	1214	1229	Bartlesville	Oil
Shale	1229	1310		
Sand	1310	1320	Top Miss.	1437 - 1475 TD
Shale	1320	1437		

USE ADDITIONAL SHEETS, IF NECESSARY, TO COMPLETE WELL RECORD.

Date Received

*R. E. Collins*

Signature

Partner

Title

4/3/79

Date

