

15-099-2010

Geological Survey

WICHITA BRANCH
KANSAS DRILLERS LOG

S. 3 T. 35 R. 19 E

Loc. NW NE

County Labette

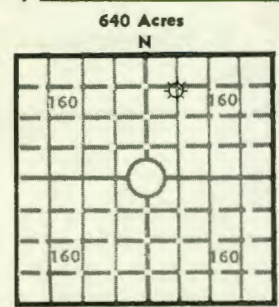

Elev.: Gr. _____

DF _____ KB _____

API No. 15 — 099 — 20,765
County Number

Operator
Lightning Oil Company

Address
P. O. Box 6598 San Antonio, Texas 78209

Well No. #1-A Lease Name D. J. McAtee

Footage Location
760 feet from (N) ~~XX~~ line 1980 feet from (E) ~~XX~~ line

Principal Contractor Nancy Drilling Col Geologist John W. Stewart

Spud Date April 13, 1978 Total Depth 714.5 P.B.T.D.

Date Completed April 22, 1978 Oil Purchaser

CASING RECORD

Report of all strings set — surface, intermediate, production, etc.

Purpose of string	Size hole drilled	Size casing set (in O.D.)	Weight lbs/ft.	Setting depth	Type cement	Sacks	Type and percent additives
Surface Csg.	9-5/8	7"	17#	165	Common	35	
Production Csg.	6½	4½	9#	695	Common	110	2% gel 2% CaCl

LINER RECORD

PERFORATION RECORD

Top, ft.	Bottom, ft.	Sacks cement	Shots per ft.	Size & type	Depth interval
			1½	80 gr. Ceramic	708-10

TUBING RECORD

Size	Setting depth	Packer set at

ACID, FRACTURE, SHOT, CEMENT SQUEEZE RECORD

Amount and kind of material used	Depth interval treated

INITIAL PRODUCTION

Date of first production _____ Producing method (flowing, pumping, gas lift, etc.) _____

RATE OF PRODUCTION PER 24 HOURS
Oil _____ bbls. Gas TSTM _____ MCF Water _____ bbls. Gas-oil ratio _____ CFPB

Disposition of gas (vented, used on lease or sold) _____ Producing interval (s) _____
Well shut-in pending further evaluation

INSTRUCTIONS: As provided in KCC Rule 82-2-125, within 90 days after completion of a well, one completed copy of this Drillers Log shall be transmitted to the State Geological Survey of Kansas, 4150 Monroe Street, Wichita, Kansas 67209. Copies of this form are available from the Conservation Division, State Corporation Commission, 3830 So. Meridian (P.O. Box 17027), Wichita, Kansas 66217. Phone AC 316-522-2206. If confidential custody is desired, please note Rule 82-2-125. Drillers Logs will be on an open file in the Oil and Gas Division, State Geological Survey of Kansas, Lawrence, Kansas 66044.

Operator
Lightning

DESIGNATE TYPE OF COMP.: OIL, GAS, DRY HOLE, SWDW, ETC.:

Well No. #1-A Lease Name D.J. McAtee

Non-commercial Gas

S 3 T 35 R 19 E
XW

WELL LOG

Show all important zones of porosity and contents thereof; cored intervals, and all drill-stem tests, including depth interval tested, cushion used, time tool open, flowing and shut-in pressures, and recoveries.

SHOW GEOLOGICAL MARKERS, LOGS RUN, OR OTHER DESCRIPTIVE INFORMATION.

FORMATION DESCRIPTION, CONTENTS, ETC.	TOP	BOTTOM	NAME	DEPTH
Overburden	0	10	Oswego	81
Grey Shale	10	81	Mississippi	
Oswego Lime	81	115	Limestone	707
Black Shale	115	119		
Oswego Lime	119	140		
Black Shale	140	143		
Grey Sandstone	143	170		
Grey Shaley Sand	170	210		
Grey Shale	210	240		
Grey Shaley Sand	248	256		
Grey Shale	256	270		
Brown Lime	270	272		
Black Shale	272	338		
Grey Sand	338	343		
Grey Shale	343	415		
White Sand	415	502		
Grey Shale	502	508		
Brown Lime	508	516		
Grey Shale	516	609		
Grey Shaley Sand	609	622		
Grey Shale	622	707		
Mississippi Lime	707	714.5		
TD	714.5			

USE ADDITIONAL SHEETS, IF NECESSARY, TO COMPLETE WELL RECORD.

Date Received	 Signature <hr/> Geologist Title <hr/> June 19, 1978 Date
---------------	--