

State Geological Survey  
 WICHITA, KANSAS T. 35 R. 20 E  
 SEP 21

**KANSAS DRILLERS LOG**

API No. 15 — 099 — 20,913  
 County Number

Operator  
 S & S Oil Co.

Address Box 304 Oswego, Ks. 67356

Well No. #8 Lease Name John Filson KCC Records

Footage Location 800' FNL 4569 FSL; 2390 FEL 340' FWL  
 feet from (N) (S) line feet from (E) (W) line

Principal Contractor Nance Drilling Company Geologist Bill Kardos

Spud Date 3-15-79 Total Depth 969' P.B.T.D. N/A

Date Completed 4-28-79 Oil Purchaser Koch Oil Company

Loc. 340' FWL & 800' FNL NE  
 NW SW NW NE  
 County Labette

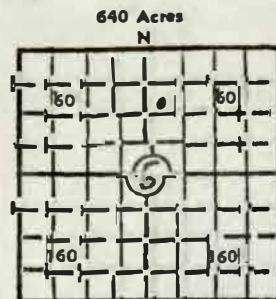

Locate well correctly  
 Elev.: Gr. 906'

DF KB

**CASING RECORD**

Report of all strings set — surface, intermediate, production, etc.

Purpose of string	Size hole drilled	Size casing set (in O.D.)	Weight lbs/ft.	Setting depth	Type cement	Sacks	Type and percent additives
Surface	8 1/2	7"	14	50'	Portland	10	None
Intermediate	6 1/2	4 1/2	9	865' 925'	Portland	112	None

**LINER RECORD**

**PERFORATION RECORD**

Top, ft.	Bottom, ft.	Sacks cement	Shots per ft.	Size & type	Depth interval

**TUBING RECORD**

Size	Setting depth	Packer set at

**ACID, FRACTURE, SHOT, CEMENT SQUEEZE RECORD**

Amount and kind of material used	Depth interval treated
None-Drilled out packer shoe.	

**INITIAL PRODUCTION**

Date of first production 5-22-79	Producing method (flowing, pumping, gas lift, etc.) Pumping
RATE OF PRODUCTION PER 24 HOURS	Oil 4 bbls. Gas None MCF Water 95 bbls. Gas-oil ratio CFPB
Disposition of gas (vented, used on lease or sold)	Producing interval (s) 965'-969'

INSTRUCTIONS: As provided in KCC Rule 82-2-125, within 90 days after completion of a well, one completed copy of this Drillers Log shall be transmitted to the State Geological Survey of Kansas, 4150 Monroe Street, Wichita, Kansas 67209. Copies of this form are available from the Conservation Division, State Corporation Commission, 3830 So. Meridian (P.O. Box 17027), Wichita, Kansas 66217. Phone AC 316-522-2206. If confidential custody is desired, please note Rule 82-2-125. Drillers Logs will be on open file in the Oil and Gas Division, State Geological Survey of Kansas, Lawrence, Kansas 66044.



DEPTH IN FEET		KIND OF ROCK	REMARKS	DEPTH IN FEET		KIND OF ROCK	REMARKS
FROM	TO			FROM	TO		
0	7	OVERBURDEN		313	315	GRAY SAND (Batonville)	
7	19	LIME		315	334	DRK " SHALE	
19	25	DRK GRAY SHALE		334	340	GRAY SAND show some	
25	53	LIME		340	388	DRK GRAY SHALE	
53	61	GRAY SAND		388	402	GRAY SANDY "	
61	137	DRK " SHALE		402	597	DRK " SHALE	
137	143	BRN SAND		597	616	MISS LIME BRN SANDY LIME	
143	157	DRK GRAY SHALE		616	622	WHITE "	
157	164	BRN SAND		622	651	DRK GRAY SANDY " (140 BRN)	
164	176	DRK GRAY SHALE		651	660	LT BRN LIME CHERT	
176	180	BRN LIME		660	674	BRN LIME CHERT	
180	189	DRK GRAY SHALE		674	701	DRK BRN LIME	
189	193	Black "		701	715	LT BRN SANDY LIME	
193	297	DRK GRAY "		715	875	BRN LIME CHERT (at 525')	
297	383	" SHALE		875	883	GRAY LIME CHERT	

B 7

6-35-200

883	902	LT BRN LIME CHERT	Bottom cemented out,
902	916	GRAY LIME CHERT	H H well service bumped
916	929	LT BRN LIME (at 916' or 929' or 931')	into formations 4 more inches.
929	931	GREEN SHALE	Total T.D. 969' 2"
931	935	" LIME	Rock set 35" off bottom
935	937	DRK GRAY SHALE	
937	942	LT BRN LIME	
942	949	DRK GRAY SHALE	
949	955	" BRN LIME	
955	965	BLACK SHALE	
965	968	GRAY LIME (cap rock)	
968	969	unusable	
	TD	968' 10"	