

10-7-13E 10/24/84 KCC

SIDE ONE

STATE CORPORATION COMMISSION OF KANSAS
OIL & GAS CONSERVATION DIVISION

WELL COMPLETION OR RECOMPLETION FORM
ACO-1 WELL HISTORY

DESCRIPTION OF WELL AND LEASE

Operator: License # 6033
Name Murfin Drilling Company
Address 250 N. Water
Suite 300
City/State/Zip Wichita, KS 67202

Purchaser.....

Operator Contact Person Ramona Gunn
Phone 316-267-3241

Contractor: License # 5420
Name White & Ellis

Wellsite Geologist Curtis Covey
Phone 316-942-2685

Designate Type of Completion

- New Well Re-Entry Workover
- Oil SWD Temp Abd
- Gas Inj Delayed Comp.
- Dry Other (Core, Water Supply etc.)

If OWWO: old well info as follows:

Operator
Well Name
Comp. Date Old Total Depth.....

WELL HISTORY

Drilling Method:
 Mud Rotary Air Rotary Cable

.10-12-84.. .10-23-84... .10-24-84....
Spud Date Date Reached TD Completion Date

.2740!..RTD.
Total Depth PBDT

Amount of Surface Pipe Set and Cemented at 320 feet
Multiple Stage Cementing Collar Used? Yes No
If yes, show depth set.....feet
If alternate 2 completion, cement circulated
from.....feet depth to.....w/.....SX cmt

API NO. 15-085-20,038.....

County... Jackson.....

S/2 S/2 NE Sec. 10 Twp. 7S Rge. 13 East West

3168 Ft North from Southeast Corner of Section
1320 Ft West from Southeast Corner of Section
(Note: Locate well in section plat below)

Lease Name... Thompson Well #... 1-10

Field Name... Wildcat.....

Producing Formation.....

Elevation: Ground... 1115' KB... 1120

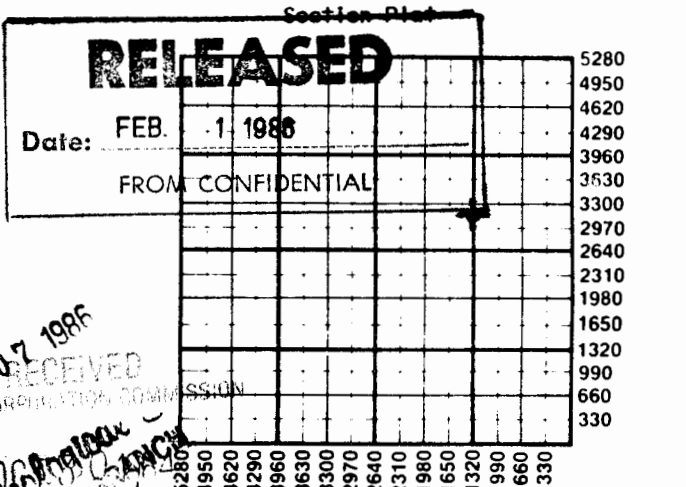

WATER SUPPLY INFORMATION
Disposition of Produced Water: Disposal Repressuring
Docket #

Questions on this portion of the ACO-1 call:
Water Resources Board (913) 296-3717

Source of Water:
Division of Water Resources Permit #.....

Groundwater.....Ft North from Southeast Corner
(Well)Ft West from Southeast Corner of
Sec Twp Rge East West

Surface Water.....Ft North from Southeast Corner
(Stream, pond etc).....Ft West from Southeast Corner
Sec Twp Rge East West

Other (explain).....
(purchased from city, R.W.D. #)

INSTRUCTIONS: This form shall be completed in duplicate and filed with the Kansas Corporation Commission, 200 Colorado Derby Building, Wichita, Kansas 67202, within 90 days after completion or recompletion of any well. Rule 82-3-130 and 82-3-107 apply.

Information on side two of this form will be held confidential for a period of 12 months if requested in writing and submitted with the form. See rule 82-3-107 for confidentiality in excess of 12 months. One copy of all wireline logs and drillers time log shall be attached with this form. Submit CP-4 form with all plugged wells. Submit CP-111 form with all temporarily abandoned wells.

SIDE TWO

Operator Name Murfin Drilling Company Lease Name Thompson Well # i-10

Sec. 10 Twp. 7S Rge. 13 East West County Jackson

WELL LOG

INSTRUCTIONS: Show important tops and base of formations penetrated. Detail all cores. Report all drill stem tests giving interval tested, time tool open and closed, flowing and shut-in pressures, whether shut-in pressure reached static level, hydrostatic pressures, bottom hole temperature, fluid recovery, and flow rates if gas to surface during test. Attach extra sheet if more space is needed. Attach copy of log.

Drill Stem Tests Taken Yes No
 Samples Sent to Geological Survey Yes No
 Cores Taken Yes No

Formation Description
 Log Sample

Name	Top	Bottom
Heebner	894'	
Lanisng	1220'	
Kansas City		1539'
Miss LM	2402'	
Kinderhook	2481'	
Hunton	2708'	

CASING RECORD <input checked="" type="checkbox"/> New <input type="checkbox"/> Used							
Report all strings set-conductor, surface, intermediate, production, etc.							
Purpose of String	Size Hole Drilled	Size Casing Set (in O.D.)	Weight Lbs/Ft.	Setting Depth	Type of Cement	#Sacks Used	Type and Percent Additives
..Surface.....	..12-1/4"8-5/8"...	...24#.....	...320....	..Common..	...120...
.....
.....
PERFORATION RECORD				Acid, Fracture, Shot, Cement Squeeze Record			
Shots Per Foot	Specify Footage of Each Interval Perforated			(Amount and Kind of Material Used)			Depth
.....
.....
.....
.....
TUBING RECORD				Liner Run	<input type="checkbox"/> Yes <input type="checkbox"/> No		
Date of First Production	Producing Method						
	<input type="checkbox"/> Flowing <input type="checkbox"/> Pumping <input type="checkbox"/> Gas Lift <input type="checkbox"/> Other (explain).....						
	Oil	Gas	Water	Gas-Oil Ratio

10-7-136 PL

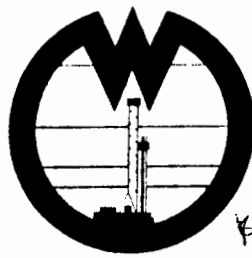

WHITE

AND ELLIS DRILLING, Inc.

DRILLERS LOG

OPERATOR: Murfin Drilling Co.
 250 N. Water, Suite 300
 Wichita, Kansas 67202

CONTRACTOR: White & Ellis Drilling, Inc., 401 E. Douglas, Suite 500,
 Wichita, Ks. 67202

Lease Name Thompson Well No. #1-10
 Sec. 10 T. 7S R. 13E Spot 528' FSL & 1320' FEL NE/4
 County Jackson State Kansas Elevation _____

Casing Record:

Surface: 8 5/8 @ 326' with 120 SX., 3% cc

Production: _____ @ _____ with _____ SX.

Type Well: D & A Total Depth 2740'

Drilling Commenced 10-17-84 Drilling Completed 10-24-84

Formation	From	To	Tops
Cellar	0	7	Douglas - 1098
Shale, Lime	7	1098	Lansing - 1221
Sand	1098	1170	Kinderhook - 2481
Shale	1170	1203	Hunton - 2701
Lime	1203	1221	
Lime	1221	1548	
Shale	1548	1596	
Lime, Shale	1596	1703	
Shale, Lime	1703	2400	
Lime	2400	2481	
Shale	2481	2649	
Shale, Lime	2649	2701	
Lime	2701	2740	

STATE OF KANSAS
 NOV 02 1984
 COMMISSIONER OF GEOLOGY