

11-7-188 8128187 KCC
Incl

RELEASED
STATE CORPORATION COMMISSION OF KANSAS
Date: SEP 17 1987
OIL & GAS CONSERVATION DIVISION
FROM CONFIDENTIAL
WELL COMPLETION OR RECOMPLETION FORM
ACO-1 WELL HISTORY

SIDE ONE

API NO. 15-.....005-20049.....
County.....Atchison.....
C N/2 NE/4 Sec. 11 Twp. 7S Rge. 18 East West
.....4620..... Ft North from Southeast Corner of Section
.....1320..... Ft West from Southeast Corner of Section
(Note: Locate well in section plat below)
Lease Name.....Page.....Well #.....1.....
Field Name.....Wetkin.....
Producing Formation.....McLouth.....
Elevation: Ground.....1094.....KB.....1100.....

DESCRIPTION OF WELL AND LEASE
Operator: License #6668.....
NameTheodore I. Leben & Assoc.....
Address640 Broadway Plaza Bldg.....
.....Wichita, Kansas 67202.....
City/State/Zip
Purchaser.....NA.....
.....Mc-KCC.....
Operator Contact Person Theodore I. Leben
Phone316-264-2375.....
Contractor: License #5676.....
NameEDCO Drilling Company Inc.....
Wellsite Geologist John Hickox
Phone.....913-354-7332.....

Designate Type of Completion
 New Well Re-Entry Workover
 Oil SWD Temp Abd
 Gas Inj Delayed Comp.
 Dry Other (Core, Water Supply etc.)
If OWWO: old well info as follows:
Operator
Well Name
Comp. DateOld Total Depth.....

KANSAS GEOLOGICAL SURVEY
WICHITA BRANCH

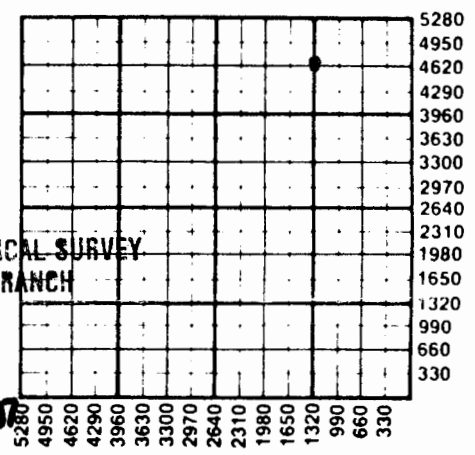

SEP 17 1987

WATER SUPPLY INFORMATION
Disposition of Produced Water: Disposal Repressuring
Docket #

WELL HISTORY

Drilling Method:
 Mud Rotary Air Rotary Cable
6-28-86 7-2-86 7-3-86
Spud Date Date Reached TD Completion Date
1869'
Total Depth PBTD
Amount of Surface Pipe Set and Cemented at202' feet
Multiple Stage Cementing Collar Used? Yes No
If yes, show depth set.....feet
If alternate 2 completion, cement circulated
from.....feet depth to.....w/.....SX cmt

Questions on this portion of the ACO-1 call:
Water Resources Board (913) 296-3717
Source of Water:
Division of Water Resources Permit #.....
 Groundwater.....Ft North from Southeast Corner
(Well)Ft West from Southeast Corner of
Sec Twp Rge East West
 Surface Water.....Ft North from Southeast Corner
(Stream, pond etc).....Ft West from Southeast Corner
Sec Twp Rge East West
 Other (explain).....
(purchased from city, R.W.D. #)

INSTRUCTIONS: This form shall be completed in duplicate and filed with the Kansas Corporation Commission, 200 Colorado Derby Building, Wichita, Kansas 67202, within 90 days after completion or recompletion of any well. Rule 82-3-130 and 82-3-107 apply.
Information on side two of this form will be held confidential for a period of 12 months if requested in writing and submitted with the form. See rule 82-3-107 for confidentiality in excess of 12 months.
One copy of all wireline logs and drillers time log shall be attached with this form. Submit CP-4 form with all plugged wells. Submit CP-111 form with all temporarily abandoned wells.

SIDE TWO

Operator Name Theodore I. Leben & Assoc. Lease Name Page Well # 1

Sec. 11 Twp. 7 S. Rge. 18 East West County Atchison County, Kansas

WELL LOG

INSTRUCTIONS: Show important tops and base of formations penetrated. Detail all cores. Report all drill stem tests giving interval tested, time tool open and closed, flowing and shut-in pressures, whether shut-in pressure reached static level, hydrostatic pressures, bottom hole temperature, fluid recovery, and flow rates if gas to surface during test. Attach extra sheet if more space is needed. Attach copy of log.

Drill Stem Tests Taken Yes No
 Samples Sent to Geological Survey Yes No
 Cores Taken Yes No

Formation Description
 Log Sample

DST #1 MISRUN 1762 - 1771
 DST #2 1765 - 1779
 15 30 45 60
 Gas to surface in 5 min. Gauged
 749 MCF per day. Recovered 150'
 gassy drilling mud.
 IFP 62/72 FFP 142/135
 ISIP 593 FSIP 583
 HP 916 - 906

Name	Top	Bottom
B/Kans. City	998	+142
Marmaton	1084	+ 16
B/Ft. Scott	1216	-116
Ardmore LM	1313	-213
Coal Marker	1668	-568
Lower McClouth	1766	-666
Mississippi	1802	-702
TD	1863	

CASING RECORD <input checked="" type="checkbox"/> New <input type="checkbox"/> Used							
Report all strings set-conductor, surface, intermediate, production, etc.							
Purpose of String	Size Hole Drilled	Size Casing Set (in O.D.)	Weight Lbs/Ft.	Setting Depth	Type of Cement	#Sacks Used	Type and Percent Additives
Surface	12 1/2"	8 5/8"	20#	212'	Common	160	3% CC
Production		4 1/2"	10.5#	1859'	60/40 Pos	150	10% salt
PERFORATION RECORD				Acid, Fracture, Shot, Cement Squeeze Record			
Shots Per Foot	Specify Footage of Each Interval Perforated			(Amount and Kind of Material Used)			Depth
	NA						
TUBING RECORD				Liner Run <input type="checkbox"/> Yes <input type="checkbox"/> No			
Date of First Production		Producing Method					