



SIDE ONE

CONV 54 F.

STATE CORPORATION COMMISSION OF KANSAS
OIL & GAS CONSERVATION DIVISION
WELL COMPLETION OR RECOMPLETION FORM
ACO-1 WELL HISTORY
DESCRIPTION OF WELL AND LEASE

Operator: License # 6871
Fairway Petroleum, Inc.
Name 12603 Southwest Freeway
Address Suite 370
City/State/Zip Stafford, TX 77477

Owner: Kelly Maclaskey
El Dorado, KS 67042

Operator Contact Person: Jeanne E. Flanagan
Phone (713) 240-1555

Tractor: License # 4160
Hutton Drilling

Wellsite Geologist: Larry E. Culbertson
Phone (913) 773-8514

Designate Type of Completion
New Well Re-Entry Workover
Oil Gas Dry
SwD Inj Other (Core, Water Supply etc.)
Temp Abd Delayed Comp.

If OWO: old well info as follows:
Operator
Well Name
Comp. Date Old Total Depth

WELL HISTORY

Drilling Method:
Mud Rotary Air Rotary Cable
3/87 8/23/87 10/2/87
Date Date Reached TD Completion Date

1530
Total Depth PBTD
Amount of Surface Pipe Set and Cemented at 40 feet
Multiple Stage Cementing Collar Used? Yes X No
If yes, show depth set feet
If alternate 2 completion, cement circulated from feet depth to w/SX cement
Cement Company Name
Invoice #

Table with 2 columns: Estimated Production Per 24 Hours, Oil Bbls. Value: 6 Bbls.

API NO. 15-103-20.883

County Leavenworth

NE NW SW Sec. 9 Twp. 8S Rge. 21 East West

2000 Ft North from Southeast Corner of Section
4580 Ft West from Southeast Corner of Section
(Note: Locate well in section plot below)

Lease Name Toot Well # 7

Field Name

Producing Formation

Elevation: Ground 1068 KB

SECTIONAL SURVEY
SECTIONAL SURVEY

JAN 26 1988

NOV 16 1987
KANSAS OIL & GAS CONSERVATION DIVISION
WICHITA, KANSAS

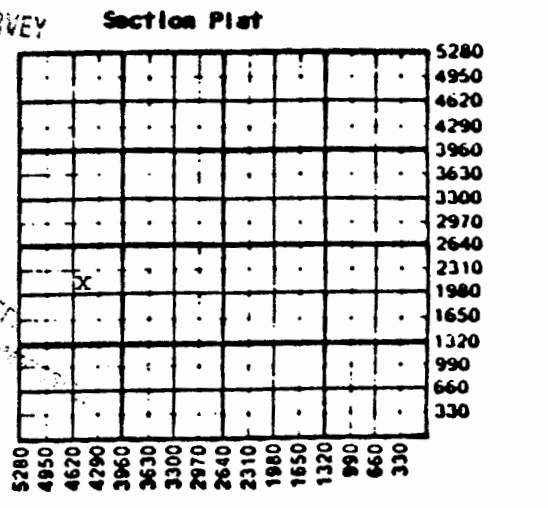

MATER SUPPLY INFORMATION

Disposition of Produced Water: Disposal
Docket # 23 591 Repressuring

Questions on this portion of the ACO-1 call:
Water Resources Board (913) 296-3717
Source of Water:
Division of Water Resources Permit #
Groundwater Ft North from Southeast Corner (Well) Ft West from Southeast Corner of Sec Twp Rge East West
Surface Water Ft North from Southeast Corner (Stream, pond etc.) Ft West from Southeast Corner Sec Twp Rge East West
X Other (explain) Purchased from local hauler (purchased from city, R.W.D. #)

Table with 4 columns: Gas, Water, Gas-Oil Ratio, Gravity. Values: MCF, 4 Bbls, CFPB, 19.1

Operator Name Fairway Petroleum, Inc. Lease Name Toot Well # 7
 Sec. 9 Twp. 8S Rge. 21 County Leavenworth
 East West

WELL LOG

INSTRUCTIONS: Show important tops and base of formations penetrated. Detail all cores. Report all drill stem tests giving interval tested, time tool open and closed, flowing and shut-in pressures, whether shut-in pressure reached static level, hydrostatic pressures, bottom hole temperature, fluid recovery, and flow rates if gas to surface during test. Attach extra sheet if more space is needed. Attach copy of log.

Drill Stem Tests Taken Yes No
 Samples Sent to Geological Survey Yes No
 Cores Taken Yes No

Name	Formation Description	
	Top	Bottom
Coal	1341	1342
Shale & Sand	1343	1391
Coal	1392	1393
Shale	1394	1477
Sand oil show	1478	1493
Shale	1494	1514
Sand oil show	1515	1520
Shale	1520	1526
Mississippi lime	1527	TD

METHOD OF COMPLETION

Disposition of gas: Vented Open Hole Perforation
 Sold Other (Specify)
 Used on Lease Fully Completed

Production Interval
1480-1498.....

CASING RECORD New Used
 Report all strings set-conductor, surface, intermediate, production, etc.

Purpose of String	Size Hole Drilled	Size Casing Set (In O.D.)	Weight Lbs/Ft.	Setting Depth	Type of Cement	#Sacks Used	Type and Percent Additives
Surface	9 1/4	7		40	Portland	15	
Production	6 1/2	4 1/2		1535	Type H	260	Silica flour

PERFORATION RECORD

Shots Per Foot	Specify Footage of Each Interval Perforated	Acid, Fracture, Shot, Cement Squeeze Record (Amount and Kind of Material Used)	Depth
3	1482 - 1484	9/4 - Hot Oil frac	1491
3	1490 - 1492	9/4 Acidize	1481-91

TUBING RECORD
 Size 2 3/8" Set At 1400' Packer at _____ Liner Run Yes No

Date of First Production _____ Producing Method Flowing Pumping Gas Lift Other (explain).....