

14-8-21E 01

SIDE ONE

STATE CORPORATION COMMISSION OF KANSAS  
OIL & GAS CONSERVATION DIVISION  
WELL COMPLETION OR RECOMPLETION FORM  
ACO-1 WELL HISTORY

DESCRIPTION OF WELL AND LEASE

Operator: license # .6871  
name Fairway Petroleum, Inc.  
address 12603 Southwest Freeway Suite 370  
Stafford, TX 77477  
City/State/Zip

Operator Contact Person Jeanne Flanagan  
Phone 713-240-1555

Operator: license # 4423  
name Van Drilling

Wellsite Geologist Mark Bray  
Phone 913-773-8514

Designate Type of Completion  
 New Well  Re-Entry  Workover  
 Oil  SWD  Temp Abd  
 Gas  Inj  Delayed Comp.  
 Dry  Other (Core, Water Supply etc.)

OWWO: old well info as follows:  
Operator N/a  
Well Name n/a  
Comp. Date n/a Old Total Depth

WELL HISTORY

Drilling Method:  Mud Rotary  Air Rotary  Cable  
Spud Date 7/2/85 Date Reached TD 7/2/85 Completion Date  
1416 PBDT  
Amount of Surface Pipe Set and Cemented at 40' feet  
Multiple Stage Cementing Collar Used?  Yes  No  
If Yes, Show Depth Set feet

Alternate 2 completion, cement circulated  
from feet depth to w/ SX cmt

API NO. 15-103-20,385  
County Leavenworth  
SE. SE. SW. Sec. 14 Twp 8 Rge. 21  
(location) XX East West



Ft North from Southeast Corner of Section  
Ft West from Southeast Corner of Section  
(Note: locate well in section plat below)

Lease Name Leavenworth County Fish & Game Well# 1

Field Name

Producing Formation none

Elevation: Ground 1036 KB

AUG 14 1985  
State Geomining Survey  
WICHITA BRANCH

Section Plat

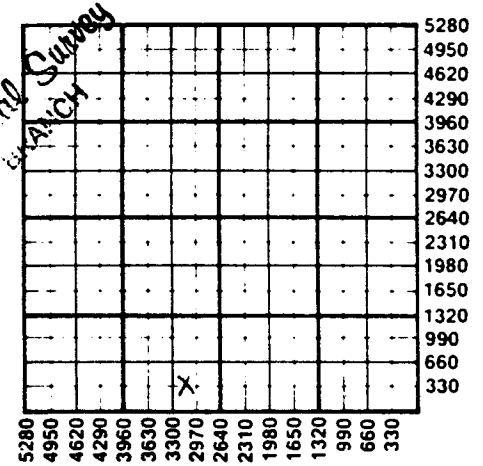

WATER SUPPLY INFORMATION

Source of Water:  
Division of Water Resources Permit #  
 Groundwater Ft North From Southeast Corner and  
(Well) Ft West From Southeast Corner of  
Sec Twp Rge  East  West  
 Surface Water Ft North From Southeast Corner and  
(Stream, Pond etc.) Ft West From Southeast Corner  
Sec Twp Rge  East  West  
 Other (explain) Purchased from local water hauler  
(purchased from city, R.W.D.#)

Disposition of Produced Water:  Disposal  Repressuring  
Docket # n/a

INSTRUCTIONS: This form shall be completed in duplicate and filed with the Kansas Corporation Commission, 200 Colorado Derby Building, Wichita, Kansas 67202, within 90 days after completion or recompletion of any well. Rules 82-3-130 and 82-3-107 apply.

Information on side two of this form will be held confidential for a period of 12 months if requested in writing and submitted with the form. See rule 82-3-107 confidentiality in excess of 12 months.  
All wireline logs and drillers time log shall be attached with this form. Submit CR-1 form with all plugged wells. Submit CR-111 form with all...

SIDE TWO

Operator Name Fairway Petroleum Lease Name Leavenworth County Fish & Game Well# 14 SEC 14 TWP. 8S RGE. 21  East  West

WELL LOG

**INSTRUCTIONS:** Show important tops and base of formations penetrated. Detail all cores. Report all drill stem tests giving interval tested, time tool open and closed, flowing and shut-in pressures, whether shut-in pressure reached static level, hydrostatic pressures, bottom hole temperature, fluid recovery, and flow rates if gas to surface during test. Attach extra sheet if more space is needed. Attach copy of log.

Drill Stem Tests Taken  Yes  No  
 Samples Sent to Geological Survey  Yes  No  
 Cores Taken  Yes  No

Formation Description  
 Log  Sample

Name	Top	Bottom
Mississippian	1416	1400
Burgess	1396	- 1400
Lower McLouth	1366	- 1374

AUG 4 1985  
 State Geological Survey  
 WICHITA BRANCH

CASING RECORD  new  used

Report all strings set - conductor, surface, intermediate, production, etc.

Purpose of string	size hole drilled	size casing set (in O.D.)	weight lbs/ft.	setting depth	type of cement	# sacks used	type and percent additives
surface	9"	7"		40'	OWC	18	

PERFORATION RECORD

Acid, Fracture, Shot, Cement Squeeze Record

shots per foot	specify footage of each interval perforated	(amount and kind of material used)	Depth