

**KANSAS STATE GEOLOGICAL SURVEY**  
**WICHITA, BRANCH**

**IMPORTANT**  
 Kans. Geo. Survey request  
 samples on this well.

S. 18 T. 8 R. 21 ~~W~~ <sup>E</sup>  
 Loc. C NW SW  
 County Leavenworth

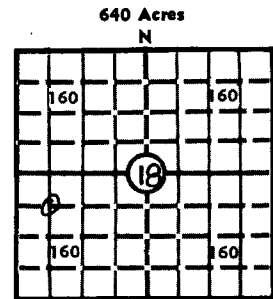

Locate well correctly  
 Elev.: Gr. 267  
 DF \_\_\_\_\_ KB \_\_\_\_\_

API No. 15 — 103 — 20,015  
 County Number

Operator  
Tomlinson Oil Co., Inc.

Address  
1030 O. Garvey Bldg, Wichita, Kansas

Well No. 1 Lease Name Timpe

Footage Location  
 feet from (N) (S) line feet from (E) (W) line

Principal Contractor B+N Drilling Co Geologist

Spud Date 5/26/72 Total Depth 1438 P.B.T.D.

Date Completed 6/1/72 Oil Purchaser

**D+A CASING RECORD**

Report of all strings set — surface, intermediate, production, etc.

Purpose of string	Size hole drilled	Size casing set (in O.D.)	Weight lbs/ft.	Setting depth	Type cement	Sacks	Type and percent additives
Surface		7"		63'			

**LINER RECORD PERFORATION RECORD**

Top, ft.	Bottom, ft.	Sacks cement	Shots per ft.	Size & type	Depth interval

Size	Setting depth	Packer set at

**ACID, FRACTURE, SHOT, CEMENT SQUEEZE RECORD**

Amount and kind of material used	Depth interval treated

**INITIAL PRODUCTION**

Date of first production		Producing method (flowing, pumping, gas lift, etc.)			
RATE OF PRODUCTION PER 24 HOURS		Oil	Gas	Water	Gas-oil ratio
		bbls.	MCF	bbls.	CFPB
Disposition of gas (vented, used on lease or sold)				Producing interval (s)	

INSTRUCTIONS: As provided in KCC Rule 82-2-125, within 90 days after completion of a well, one completed copy of this Drillers Log shall be transmitted to the State Geological Survey of Kansas, 4150 Monroe Street, Wichita, Kansas 67209. Copies of this form are available from the Conservation Division, State Corporation Commission, 3830 So. Meridian (P.O. Box 17027), Wichita, Kansas 66217. Phone AC 316-522-2206. If confidential custody is desired, please note Rule 82-2-125. Drillers Logs will be on open file in the Oil and Gas Division, State Geological Survey of Kansas, Lawrence, Kansas 66044.

Operator

DESIGNATE TYPE OF COMP.: OIL, GAS, DRY HOLE, SWDW, ETC.:

Well No.

Lease Name

S \_\_\_ T \_\_\_ R \_\_\_ E \_\_\_ W

### WELL LOG

Show all important zones of porosity and contents thereof; cored intervals, and all drill-stem tests, including depth interval tested, cushion used, time tool open, flowing and shut-in pressures, and recoveries.

SHOW GEOLOGICAL MARKERS, LOGS RUN, OR OTHER DESCRIPTIVE INFORMATION.

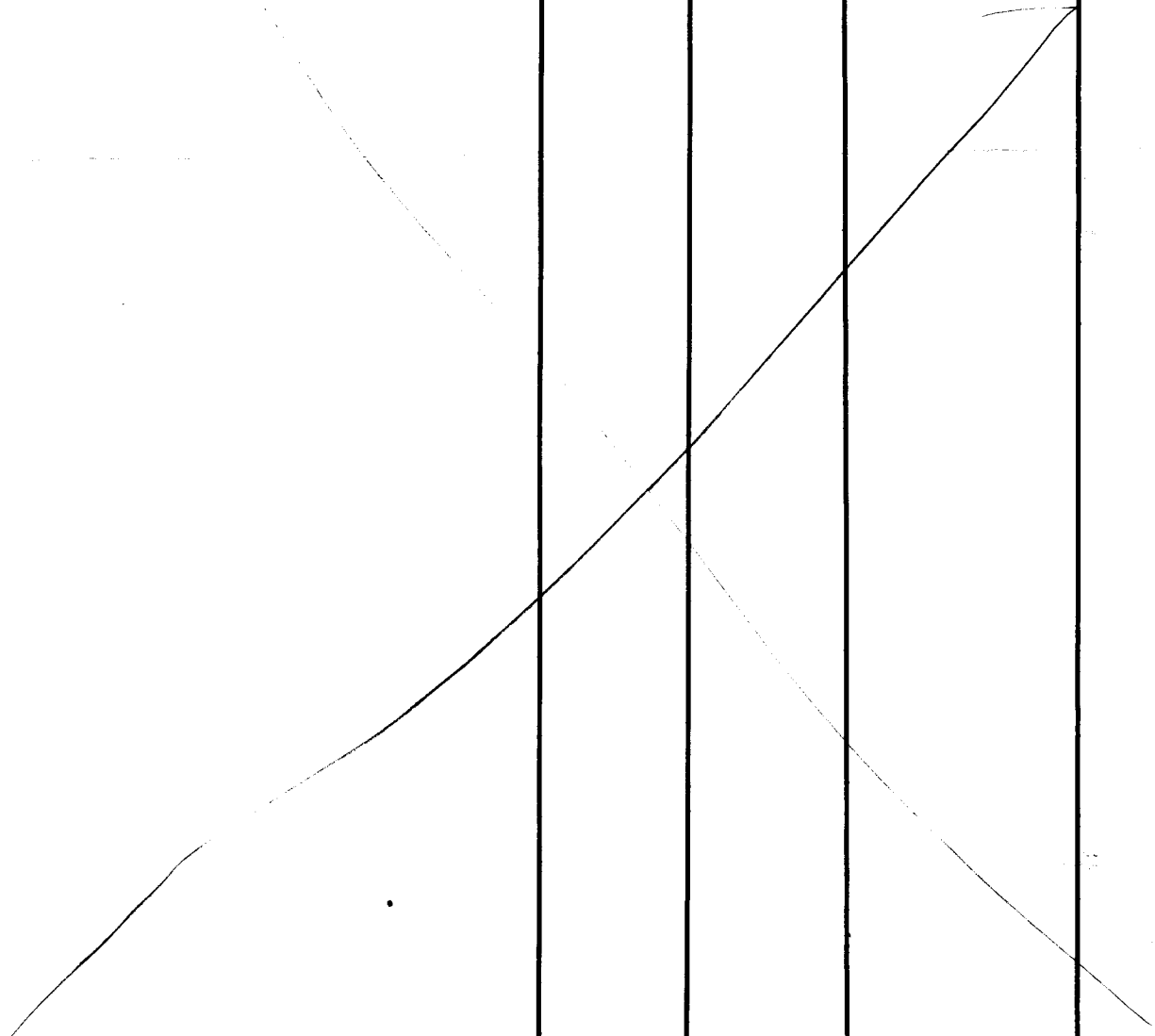
FORMATION DESCRIPTION, CONTENTS, ETC.	TOP	BOTTOM	NAME	DEPTH
				

USE ADDITIONAL SHEETS, IF NECESSARY, TO COMPLETE WELL RECORD.

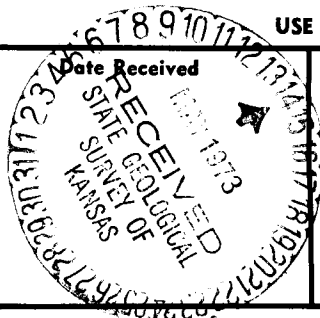

*Robert J. Giles*  
 \_\_\_\_\_  
 Signature

Title

Date

State Geological Survey  
WELL RECORD  
WICHITA, BRANCH

14-8-21E

No. 1 Farm \_\_\_\_\_ Timpe \_\_\_\_\_ Producer Tomlinson Oil Co.  
 Location \_\_\_\_\_ C NW SW \_\_\_\_\_ Sec. 18, Twp. 8S Rge. 21E  
 Elevation \_\_\_\_\_ State Kansas County Leavenworth  
 Kind (Oil, Gas, Water, Dry Hole) Dry Hole Contractor B & N Drilling  
 Producing Formation \_\_\_\_\_ Top \_\_\_\_\_ Bottom \_\_\_\_\_  
 Shot With \_\_\_\_\_ Qts. \_\_\_\_\_ from \_\_\_\_\_ to \_\_\_\_\_  
 Packer Set At \_\_\_\_\_ Kind \_\_\_\_\_ Size \_\_\_\_\_  
 Liner \_\_\_\_\_ from \_\_\_\_\_ to \_\_\_\_\_ Perforated from \_\_\_\_\_ to \_\_\_\_\_

Thick-	Strata	Depth	Thick-	Strata	Depth
6	soil	6	8	shale	541
7	clay	13	10	lime	551
20	lime	33	14	shale	565
4	shale black	37	22	lime	587
2	lime	39	11	shale	598
11	shale	50	17	lime	615
10	lime	60	10	shale	625
7	sandy shale	67	16	lime	641
6	shale	73	7	shale sandy	648
5	red bed	78	19	sand	667
150	shale	228	91	sandy shale	758
4	lime	232	1	lime	759
89	shale	321	21	shale & sand	780
5	lime	326	5	lime	785
5	sandy shale	331	17	shale sandy	802
10	lime	341	2	lime	804
7	shale	348	36	shale	840
5	lime	350	5	lime	845
2	shale & lime	352	5	shale	850
21	shale	373	2	lime	852
15	lime	388	38	shale & sand	890
7	shale	405	190	shale	1080
9	lime	414	71	sandy shale	1151
53	shale	467	51	shale & lime	1202
26	lime	493	105	shale sandy	1307
8	shale	501	63	shale	1370
8	lime	509	13	sandy shale	1383
17	shale	526	56	lime Miss	1439
5	lime & shale	531			
2	lime	533			

Total Depth 1439  
 Open Hole \_\_\_\_\_  
 Casing 7" at \_\_\_\_\_  
 Casing \_\_\_\_\_ at \_\_\_\_\_  
 Casing \_\_\_\_\_ at \_\_\_\_\_  
 Cement \_\_\_\_\_  
 Tubing \_\_\_\_\_  
 Rods \_\_\_\_\_  
 Additional Information \_\_\_\_\_  
Plug well, bottom plug at 240'  
with 15 sacks of cement, mud to  
40' with 10 sacks cement.

Date Completed 6/1/72 O.K. \_\_\_\_\_  
 Superintendent \_\_\_\_\_