

24-8-216

Note: Well was initially reported as #3 Theis in NE SE SE 24-8S-21E

SIDE ONE

STATE CORPORATION COMMISSION OF KANSAS OIL & GAS CONSERVATION DIVISION WELL COMPLETION OR RECOMPLETION FORM ACO-1 WELL HISTORY DESCRIPTION OF WELL AND LEASE

Operator: License # 4081 Name Simco Petroleum Company Address P.O. Box 1515 Cheyenne, WY 82003 City/State/Zip

Purchaser Caparale Pipeline Corporation

Operator Contact Person Ted Simola Phone 307-632-6468

Contractor: License # 4423 Name Van Drilling, Inc.

Wellsite Geologist Martin K. Dubois Phone 316-221-0428

Designate Type of Completion: X New Well, Re-Entry, Workover. Oil, Gas, Dry, SWD, Inj, Other (Core, Water Supply etc.), Temp Abd, Delayed Comp.

If OWNED: old well info as follows: Operator, Well Name, Comp. Date, Old Total Depth.

WELL HISTORY

Drilling Method: X Mud Rotary, Air Rotary, Cable

12-29-88, 1-3-89, 1-10-89 Spud Date, Date Reached TD, Completion Date. 1290, 1288 Total Depth, PBDT

Amount of Surface Pipe Set and Cemented at 81 feet. Multiple Stage Cementing Collar Used? Yes X No. Cement Company Name Sun Cementing & Acidizing Co. License # 2426

API NO. 15-103-21-096 County Leavenworth E 1/2 SE SE Sec. 24 Twp 8 Rge 21 660 Ft North from Southeast Corner of Section 330 Ft West from Southeast Corner of Section (Note: Locate well in section plat below) Lease Name C Heim Well # 14 Field Name Slammer Producing Formation Burgess Elevation: Ground 870 EGL KB

KANSAS GEOLOGICAL SURVEY WICHITA BRANCH

APR 21 1989

RECEIVED STATE CORPORATION COMMISSION

APR 14 1989

CONSERVATION DIVISION Wichita, Kansas

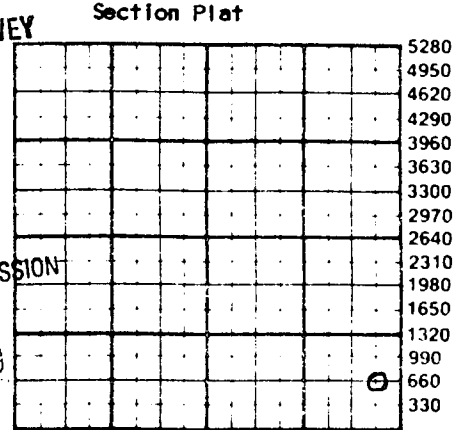

WATER SUPPLY INFORMATION

Disposition of Produced Water: None Disposal, Docket #, Repressuring

Questions on this portion of the ACO-1 call: Water Resources Board (913) 296-3717

Source of Water: Division of Water Resources Permit # N/A. Groundwater 660 Ft North from Southeast Corner (Well) 490 Ft West from Southeast Corner of Sec 24 Twp 8 Rge 21 East West. Surface Water 660 Ft North from Southeast Corner (Stream, pond etc) 490 Ft West from Southeast Corner Sec 24 Twp 8 Rge 21 East West. Other (explain) (purchased from city, R.W.D. #)

INSTRUCTIONS: This form shall be completed in triplicate and filed with the Kansas Corporation Commission, 200 Colorado Derby Building, Wichita, Kansas 67202, within 120 days of the spud date of any well. Rule 82-3-130, 82-3-107 and 82-3-106 apply. Information on side two of this form will be held confidential for a period of 12 months if requested in writing and submitted with the form. See rule 82-3-107 for confidentiality in excess of 12 months. One copy of all wireline logs and drillers time log shall be attached with this form. Submit CP-4 form with all plugged wells. Submit CP-111 form with all temporarily abandoned wells.

All requirements of the statutes, rules and regulations promulgated to regulate the oil and gas industry have been fully complied with and the statements herein are complete and correct to the best of my knowledge.

Signature Martin K. Dubois

Title Geologist Date 4/12/89

Subscribed and sworn to before me this 12th day of April 1989

Notary Public Janice A. Flick

Date Commission Expires 9/2/91

K.C.C. OFFICE USE ONLY. (F) Letter of Confidentiality Attached, (C) Wireline Log Received, (C) Drillers Timelog Received. Distribution: KCC, SWD/Rep, NGPA, KGS, Plug, Other (Specify)

JANICE S. FLICK NOTARY PUBLIC STATE OF KANSAS MY APPT. EXPIRES 9/2/91

Sec. 24 Twp. 8 N. Rge. 21 E

Operator Name Sinco Petroleum Company Lease Name... C. Heim Well # 14

Sec..... 24 Twp... 8 Rge..... 21 East West County... Leavenworth

WELL LOG

INSTRUCTIONS: Show important tops and base of formations penetrated. Detail all cores. Report all drill stem tests giving interval tested, time tool open and closed, flowing and shut-in pressures, whether shut-in pressure reached static level, hydrostatic pressures, bottom hole temperature, fluid recovery, and flow rates if gas to surface during test. Attach extra sheet if more space is needed. Attach copy of log.

Drill Stem Tests Taken Yes No
 Samples Sent to Geological Survey Yes No
 Cores Taken Yes No

Formation Description
 Log Sample

Name	Top	Bottom
Lansing	135	(+735)
B. Kansas City	460	(+410)
Cherokee	704	(+166)
Coal Marker	1088	(-218)
Burgess	1218	(-348)
Mississippi	1239	(-367)
LTD	1287	(-417)
RTD	1290	(-420)

CASING RECORD <input checked="" type="checkbox"/> New <input type="checkbox"/> Used							
Report all strings set-conductor, surface, intermediate, production, etc.							
Purpose of String	Size Hole Drilled	Size Casing Set (in O.D.)	Weight Lbs/Ft.	Setting Depth	Type of Cement	#Sacks Used	Type and Percent Additives
surface	12 1/4	7 5/8	24	80	reg	50	3% CaCl
production	6 1/2	4 1/2	95	1288	50-50 pazmix Reg	90 50	10% Gell 2% CaCl & 2% Gell
PERFORATION RECORD				Acid, Fracture, Shot, Cement Squeeze Record			
Shots Per Foot	Specify Footage of Each Interval Perforated			(Amount and Kind of Material Used)		Depth	
8							
3	1220-1224			None			
TUBING RECORD				Size <u>None</u>	Set At	Packer at	Liner Run <input type="checkbox"/> Yes <input type="checkbox"/> No
Date of First Production		Producing Method					
1-10-89		<input checked="" type="checkbox"/> Flowing <input type="checkbox"/> Pumping <input type="checkbox"/> Gas Lift <input type="checkbox"/> Other (explain).....					
Estimated Production Per 24 Hours		Oil	Gas	Water	Gas-Oil Ratio	Gravity	
➔		Bbl's	200 MCF	0 Bbl's	CFPB		

METHOD OF COMPLETION

Production Interval

Disposition of gas: Vented Sold Used on Lease
 Open Hole Perforation Other (Specify)
 Dually Completed Conmingled

Burgess (1220-24)