

34-8-21E

SIDE ONE

STATE CORPORATION COMMISSION OF KANSAS
OIL & GAS CONSERVATION DIVISION
WELL COMPLETION OR RECOMPLETION FORM
ACO-1 WELL HISTORY
DESCRIPTION OF WELL AND LEASE

Operator: License # 9851
Name Pryor Oil Co.
Address 423 N. Shore Dr.
City/State/Zip Parkville, MO 64151

Purchaser Kelly McKlaskey

Operator Contact Person J. Pryor
Phone 816-587-1225

Contractor: License # 4968
Name Northeast Oil & Gas

Wellsite Geologist
Phone

Designate Type of Completion
 New Well Re-Entry Workover
 Oil SWD Temp Abd
 Gas Inj Delayed Comp.
 Dry Other (Core, Water Supply etc)
If OWWO: old well info as follows:
Operator
Well Name
Comp. Date Old Total Depth

WELL HISTORY

Drilling Method: Mud Rotary Air Rotary Cable
8/28/88 9/1/88 9/7/88
Spud Date Date Reached TD Completion Date
1558' 1549'
Total Depth PBTD
Amount of Surface Pipe Set and Cemented at 42' feet
Multiple Stage Cementing Collar Used? Yes No
If yes, show depth set feet
If alternate 2 completion, cement circulated from 1523' feet depth to 166' SX cmt
Cement Company Name Consolidated Services
Invoice # 96361

API NO. 15-103-21035
County Leavenworth
NE. SW. NW. Sec. 34. Twp. 8. Rge. 21. East West
3630 Ft North from Southeast Corner of Section
4290 Ft West from Southeast Corner of Section
(Note: Locate well in section plat below)

Lease Name Bergman Well # 1
Field Name
Producing Formation McLouth
Elevation: Ground 1097.9' KB

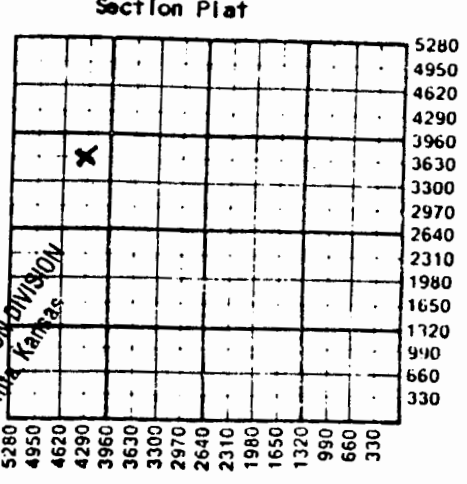

DEC 06 1988
KANSAS GEOLOGICAL SURVEY
WICHITA BRANCH
RECEIVED
STATE CORPORATION COMMISSION
NOV 14 1988
CONSERVATION DIVISION
Wichita, Kansas

WATER SUPPLY INFORMATION
Disposition of Produced Water: Disposal Repressuring
Docket #

Questions on this portion of the ACO-1 call:
Water Resources Board (913) 296-3717
Source of Water:
Division of Water Resources Permit #
Groundwater Ft North from Southeast Corner (Well) Ft West from Southeast Corner of Sec Twp Rge East West
Surface Water Ft North from Southeast Corner (Stream, pond etc) Ft West from Southeast Corner Sec Twp Rge East West
Other (explain) Purchased from Hauler (purchased from city, R.W.D. #)

INSTRUCTIONS: This form shall be completed in triplicate and filed with the Kansas Corporation Commission, 200 Colorado Derby Building, Wichita, Kansas 67202, within 120 days of the spud date of any well. Rule 82-3-130, 82-3-107 and 82-3-106 apply.
Information on side two of this form will be held confidential for a period of 12 months if requested in writing and submitted with the form. See rule 82-3-107 for confidentiality in excess of 12 months.
One copy of all wireline logs and drillers time log shall be attached with this form. Submit CP-4 form with all plugged wells. Submit CP-111 form with all temporarily abandoned wells.

All requirements of the statutes, rules and regulations promulgated to regulate the oil and gas industry have been fully complied with and the statements herein are complete and correct to the best of my knowledge.

Signature
Title Date 11-9-88
Subscribed and sworn to before me this day of Nov 1988
Notary Public
Date Commission Expires

DALE A. SMITH
NOTARY PUBLIC
STATE OF KANSAS
My Appointment Expires 11/15/89

K.C.C. OFFICE USE ONLY
 Letter of Confidentiality Attached
 Wireline Log Received
 Drillers Timelog Received
Distribution
 KCC SWD/Rep NGPA
 KGS Plug Other (Specify)

Sec. 34 Twp. 8. Rge. 21E