

18-8-225 ¹¹⁵¹⁸⁵ KCC

STATE CORPORATION COMMISSION OF KANSAS
OIL & GAS CONSERVATION DIVISION

WELL COMPLETION OR RECOMPLETION FORM
ACO-1 WELL HISTORY

DESCRIPTION OF WELL AND LEASE

Operator: License #9803.....
Name ...WYKOMA OIL, INC.....
Address P.O. BOX 471.....
City/State/Zip PINE BLUFF, WYOMING.....
82082

Purchaser...LAGGS, Inc.....

Operator Contact Person Kenneth D. Spear..
Phone 316-721-4273.....

Contractor: License # 5101.....
Name ...K & W DRILLING.....

Wellsite Geologist ROBERT L. LAYMON.....
Phone 316-721-0572.....

Designate Type of Completion

- New Well
- Re-Entry
- Workover
- Oil
- SMD
- Temp Abd
- Gas
- Inj
- Delayed Comp.
- Dry
- Other (Core, Water Supply etc.)

If ONNO: old well info as follows:

Operator
Well Name
Comp. DateOld Total Depth.....

WELL HISTORY

Drilling Method:

- Mud Rotary
- Air Rotary
- Cable

.5-27-84. .5-31-84... .1-15-85...
Spud Date Date Reached TD Completion Date

.1423!.....
Total Depth PBSD

Amount of Surface Pipe Set and Cemented at .95 feet
Multiple Stage Cementing Collar Used? Yes No
If yes, show depth set.....feet
If alternate 2 completion, cement circulated
from .1423....feet depth to surface 187 SX cmt

API NO. 15-103-20-253.....
County...LEAVENWORTH.....
.....SW. SW. Sec. 18. Twp. 88. Rge. 22.. East West

...730.... Ft North from Southeast Corner of Section
...4635... Ft West from Southeast Corner of Section
(Note: Locate well in section plat below)

Lease Name...HUND.....Well #...1.....

Field Name.....

Producing Formation...McLouth Sand.....

Elevation: Ground...1020.....KB.....

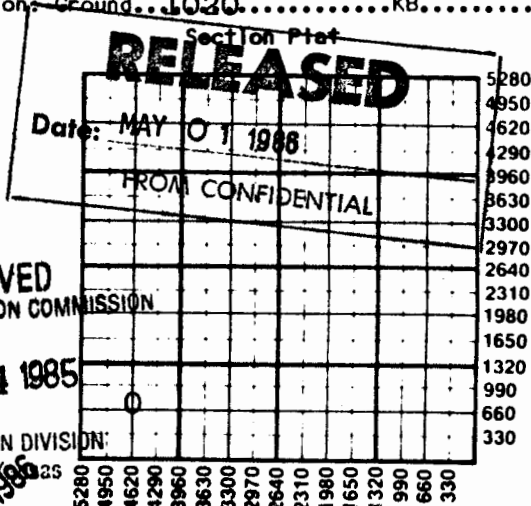

STATE CORPORATION COMMISSION

FEB 4 1985

CONSERVATION DIVISION
Wichita, Kansas

MAY 29 1985

WATER SUPPLY INFORMATION

Disposition of Produced Water: Disposal Repressuring
Docket #.....

Questions on this portion of the ACO-1 call:

Water Resources Board (913) 296-3717

Source of Water:
Division of Water Resources Permit #.....

Groundwater.....Ft North from Southeast Corner
(Well)Ft West from Southeast Corner of
Sec Twp Rge East West

Surface Water.....Ft North from Southeast Corner
(Stream, pond etc).....Ft West from Southeast Corner
Sec Twp Rge East West

Other (explain).....
(purchased from city, R.W.D. #)

INSTRUCTIONS: This form shall be completed in duplicate and filed with the Kansas Corporation Commission, 200 Colorado Derby Building, Wichita, Kansas 67202, within 90 days after completion or recompletion of any well. Rule 82-3-130 and 82-3-107 apply.

Information on side two of this form will be held confidential for a period of 12 months if requested in writing and submitted with the form. See rule 82-3-107 for confidentiality in excess of 12 months.

One copy of all wireline logs and drillers time log shall be attached with this form. Submit CP-4 form with all plugged wells. Submit CP-111 form with all temporarily abandoned wells.

All requirements of the statutes, rules and regulations promulgated to regulate the oil and gas industry have been fully complied with and the statements herein are complete and correct to the best of my knowledge.

Operator Name **WYKOMA OIL, INC.** Lease Name **HUND** Well # **1**

Sec. **18** Twp. **8S** Rge. **22** East West County **LEAVENWORTH**

WELL LOG

INSTRUCTIONS: Show important tops and base of formations penetrated. Detail all cores. Report all drill stem tests giving interval tested, time tool open and closed, flowing and shut-in pressures, whether shut-in pressure reached static level, hydrostatic pressures, bottom hole temperature, fluid recovery, and flow rates if gas to surface during test. Attach extra sheet if more space is needed. Attach copy of log.

Drill Stem Tests Taken Yes No
 Samples Sent to Geological Survey Yes No
 Cores Taken Yes No

Formation Description
 Log Sample

Name	Top	Bottom
McLouth	1323	1345
Mississippian	1428	not reached

Estimated Production Per 24 Hours

2.0 Bbls 380.0 MCF 0.0 Bbls 190,000 CFPB 18

METHOD OF COMPLETION

Production Interval

Disposition of gas: Vented Open Hole Perforation
 Sold Other (Specify)
 Used on Lease Dually Completed Commingled

1324...1328..
 1354...1370..

CASING RECORD New Used

Report all strings set-conductor, surface, intermediate, production, etc.

Purpose of String	Size Hole Drilled	Size Casing Set (In O.D.)	Weight Lbs/Ft.	Setting Depth	Type of Cement	#Sacks Used	Type and Percent Additives
..SURFACE.....	10".....	7".....	20.....	95'.....	Common	90.....
..PRODUCTION..	6 1/4".....	4 1/2".....	10.....	1414.....	Port A.	210.....

PERFORATION RECORD

Shots Per Foot	Specify Footage of Each Interval Perforated	Acid, Fracture, Shot, Cement Squeeze Record (Amount and Kind of Material Used)	Depth
2	1324 to 1328	500 gal. 15% MCA	
4	1354...to...1370.....	500 gal. 15% MCA.....	

TUBING RECORD Size Set At Packer at Liner Run Yes No

Date of First Production 1-15-85 Producing Method Flowing Pumping Gas Lift Other (explain).....