

RELEASED

SIDE ONE

20-8-226 5/1/87 KC



STATE CORPORATION COMMISSION OF KANSAS
OIL & GAS CONSERVATION DIVISION
WELL COMPLETION OR RECOMPLETION FORM
FROM CONFIDENTIAL WELL HISTORY
DESCRIPTION OF WELL AND LEASE

Date

JUN 1 1987

API NO. 15-103-20,338

County Leavenworth

SE SW SW Sec 20 Twp 8 S Rge 22 East West

330 Ft North from Southeast Corner of Section
4290 Ft West from Southeast Corner of Section
(Note: Locate well in section plat below)

Operator: License # 4081
Name Since Petroleum, Inc.
Address P.O. Box 1515
City/State/Zip Cheyenne, WY 82003

Lease Name Heim Well # 1-20

Purchaser Fautina

Field Name SLAMMER, NE

Operator Contact Person Kenneth D. Spear
Phone 316-721-0572

Producing Formation Cherokee Sand

Elevation: Ground 907' KB

Contractor: License # 5101
Name K & W Drilling

Wellsite Geologist Kenneth D. Spear
Phone 316-721-0572

Designate Type of Completion
X New Well Re-Entry Workover
Oil SWD Temp Abd
Gas Inj Delayed Comp.
Dry Other (Core, Water Supply etc.)

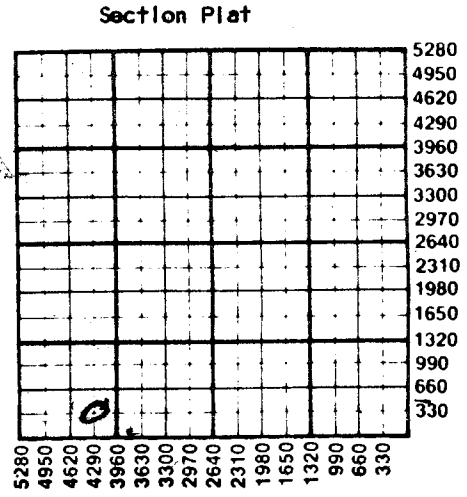

If OWWO: old well info as follows:
Operator
Well Name
Comp. Date Old Total Depth

CONFIDENTIAL

WELL HISTORY

Drilling Method:
X Mud Rotary Air Rotary Cable
4-2-85... 4-6-85... 4-7-85...
Spud Date Date Reached TD Completion Date

1360!...
Total Depth PBTD

Amount of Surface Pipe Set and Cemented at 85 feet
Multiple Stage Cementing Collar Used? Yes X No
If yes, show depth set... feet
If alternate 2 completion, cement circulated from 1360 feet depth to surface 175' cmt
Cement Company Name Consolidated
Invoice # 57317

WATER SUPPLY INFORMATION
Disposition of Produced Water: X Disposal
Docket # Repressuring

Questions on this portion of the ACO-1 call:
Water Resources Board (913) 296-3717
Source of Water:
Division of Water Resources Permit #

Groundwater... Ft North from Southeast Corner
(Well) RECEIVED Ft West from Southeast Corner of
STATE CORPORATION COMMISSION Rge East West
Surface Water... Ft North from Southeast Corner
(Stream, pond etc.)... Ft West from Southeast Corner
CONSERVATION DIVISION Rge East West
Wichita, Kansas
Other (explain) (purchased from city, R.W.D. #)

INSTRUCTIONS: This form shall be completed in duplicate and filed with the Kansas Corporation Commission, 200 Colorado Derby Building, Wichita, Kansas 67202, within 90 days after completion or recompletion of any well. Rule 82-3-130 and 82-3-107 apply. Information on side two of this form will be held confidential for a period of 12 months if requested in writing and submitted with the form. See rule 82-3-107 for confidentiality in excess of 12 months. One copy of all wireline logs and drillers time log shall be attached with this form. Submit CP-4 form with all plugged wells. Submit CP-111 form with all temporarily abandoned wells.

All requirements of the statutes, rules and regulations promulgated to regulate the oil and gas industry have

SIDE TWO

Operator Name **Simco Petroleum, Inc.** Lease Name **Hein** Well # **1-20**

Sec. **20** Twp. **8 S** Rge. **22** East West County **Leavenworth**

WELL LOG

INSTRUCTIONS: Show important tops and base of formations penetrated. Detail all cores. Report all drill stem tests giving interval tested, time tool open and closed, flowing and shut-in pressures, whether shut-in pressure reached static level, hydrostatic pressures, bottom hole temperature, fluid recovery, and flow rates if gas to surface during test. Attach extra sheet if more space is needed. Attach copy of log.

Drill Stem Tests Taken Yes No
Samples Sent to Geological Survey Yes No
Cores Taken Yes No

Formation Description
 Log Sample

Name	Top	Bottom
Lower Burgess	1238-	1257'
Mississippian	1312-	not reached

Estimated Production Per 24 Hours	Oil	Gas	Water	Gas-Oil Ratio	Gravity
	0 Bbls	250 MCF	0 Bbls	0 CFPB	none

METHOD OF COMPLETION

Production Interval

Disposition of gas: Vented Open Hole Perforation
 Sold Other (Specify) 1288'-1295'.....
 Used on Lease Dually Completed 1294'-1299'.....

CASING RECORD New Used

Report all strings set-conductor, surface, intermediate, production, etc.

Purpose of String	Size Hole Drilled	Size Casing Set (in O.D.)	Weight Lbs/Ft.	Setting Depth	Type of Cement	#Sacks Used	Type and Percent Additives
surface	9"	7"	21	85'	Portland A	42	none
production	6 1/2"	4 1/2"	9.5	1354'	Portland A	175	2% gal

PERFORATION RECORD

Acid, Fracture, Shot, Cement Squeeze Record

Shots Per Foot	Specify Footage of Each Interval Perforated	(Amount and Kind of Material Used)	Depth
2	1280-1284'	500 gal 7 1/2% MCA	
2	1294-1298'	500 gal 7 1/2% MCA	

TUBING RECORD Size **none** Set At Packer at Liner Run Yes No

Date of First Production **2-01-86** Producing Method Flowing Pumping Gas Lift Other (explain).....