

AMENDED
STATE CORPORATION COMMISSION OF KANSAS
OIL & GAS CONSERVATION DIVISION
WELL COMPLETION OR RECOMPLETION FORM
ACO-1 WELL HISTORY
DESCRIPTION OF WELL AND LEASE

Operator: License # 8493
Name S & V Oil Inc.
Address Box 857
City/State/Zip Russell, KS 67665

Purchaser none

Operator Contact Person Mrs. James H. Norris
Phone 913-483-4376

Contractor: License # 4423
Name Van Drilling Co.

Wellsite Geologist Dubois & Johnson
Phone 316-221-0428

Designate Type of Completion
 New Well Re-Entry Workover
 Oil SWD Temp Abd
 Gas SI Inj Delayed Comp.
 Dry Other (Core, Water Supply etc.)

If OWO: old well info as follows:
Operator
Well Name
Comp. Date Old Total Depth

WELL HISTORY

Drilling Method:
 Mud Rotary Air Rotary Cable
7/23/87 7/23/87
Spud Date Date Reached TD Completion Date
1336
Total Depth PBD

Amount of Surface Pipe Set and Cemented at 40' feet
Multiple Stage Cementing Collar Used? Yes No
If yes, show depth set feet
If alternate 2 completion, cement circulated from 1336 feet depth to surface 84 SX cmt
Cement Company Name Consolidated Well Services
Invoice # 72135

API NO. 15-103-20,878
County Leavenworth
SE SW SW NE Sec. 32 Twp. 8S Rge. 22 West



* 2805 3300 Ft North from Southeast Corner of Section
2445 1980 Ft West from Southeast Corner of Section
(Note: Locate well in section plat below)

Lease Name Baumgartner D Well # 1.2

Field Name Possum Hollow

Producing Formation Burgess Sandstone

Elevation: Ground 925' KB

Section Plat

KANSAS GEOLOGICAL SURVEY
WICHITA BRANCH
JUL 20 1988

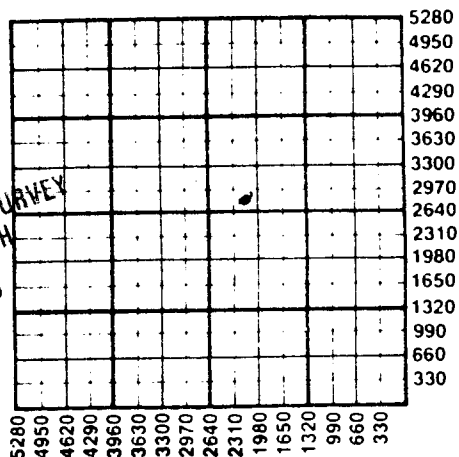

WATER SUPPLY INFORMATION

Disposition of Produced Water: Disposal
Docket # Repressuring

Questions on this portion of the ACO-1 call:
Water Resources Board (913) 296-3717

Source of Water:
Division of Water Resources Permit #

Groundwater.....Ft North from Southeast Corner
(Well)Ft West from Southeast Corner of
Sec Twp Rge East West

Surface Water.....Ft North from Southeast Corner
(Stream, pond etc).....Ft West from Southeast Corner
Sec Twp Rge East West

Other (explain).....
(purchased from city, R.W.D. #)

INSTRUCTIONS: This form shall be completed in duplicate and filed with the Kansas Corporation Commission, 200 Colorado Derby Building, Wichita, Kansas 67202, within 90 days after completion or recompletion of any well. Rule 82-3-130 and 82-3-107 apply.

Information on side two of this form will be held confidential for a period of 12 months if requested in writing and submitted with the form. See rule 82-3-107 for confidentiality in excess of 12 months. One copy of all wireline logs and drillers time log shall be attached with this form. Submit CP-4 form with all plugged wells. Submit CP-111 form with all temporarily abandoned wells.

All requirements of the statutes, rules and regulations promulgated to regulate the oil and gas industry have been fully complied with and the statements herein are complete and correct to the best of my knowledge.

Signature Mrs. James H. Norris

Title Secretary Date 6/17/88

Subscribed and sworn to before me this 7th day of June 1988

Notary Public Dorothy Mashburn

Date Commission Expires 12-18-88

K.C.C. OFFICE USE ONLY
F Letter of Confidentiality Attached
C Wireline Log Received
C Drillers Timelog Received
Distribution
SWD/Rep NGPA
Plug Other (Specify)

CONSERVATION DIVISION
Wichita, Kansas

DOROTHY MASHBURN
State of Kansas
My Appt. Exp. 12-18-88

Sec 32 Twp. 8 Rge. 22 E

SIDE TWO

Operator Name S & V Oil, Inc. Lease Name Baumgartner D. Well # 1

Sec. 32 Twp. 8S Rge. 22 East West County Leavenworth

WELL LOG

INSTRUCTIONS: Show important tops and base of formations penetrated. Detail all cores. Report all drill stem tests giving interval tested, time tool open and closed, flowing and shut-in pressures, whether shut-in pressure reached static level, hydrostatic pressures, bottom hole temperature, fluid recovery, and flow rates if gas to surface during test. Attach extra sheet if more space is needed. Attach copy of log.

Drill Stem Tests Taken Yes No
 Samples Sent to Geological Survey Yes No
 Cores Taken Yes No

Formation Description
 Log Sample

Name	Top	Bottom
Lansing	170	
Base KC	496	
Coal Marker	1132	
Lower Burgess	1291	
Mississippian	1332	
Total Depth	1336	

CASING RECORD New Used
 Report all strings set-conductor, surface, intermediate, production, etc.

Purpose of String	Size Hole Drilled	Size Casing Set (in O.D.)	Weight Lbs/Ft.	Setting Depth	Type of Cement	#Sacks Used	Type and Percent Additives
Surface	6 ³ / ₄ "	7"	18	40	Portland	12	N/A
Production	6 ³ / ₄ "	4 1/2"	9.5	1334	Portland A	84	8% Gel

PERFORATION RECORD
 Shots Per Foot | Specify Footage of Each Interval Perforated | Acid, Fracture, Shot, Cement Squeeze Record (Amount and Kind of Material Used) | Depth

16	1290-1294	200 gallons 7 1/2%	
----	-----------	--------------------	--

TUBING RECORD Size Set At Packer at Liner Run Yes No

Date of First Production | Producing Method Flowing Pumping Gas Lift Other (explain) Shut-in

Estimated Production Per 24 Hours	Oil Bbls	Gas MCF	Water Bbls	Gas-Oil Ratio	Gravity
					Shut-in

METHOD OF COMPLETION

Production Interval

Disposition of gas: Vented Open Hole Perforation
 Sold Other (Specify) 1290-1294
 Used on Lease Dually Completed
 Commingled