

29-9-115

KANSAS DRILLERS LOG

S. 29 T. 9S R. 11 ^E/_W
 Loc. C SE SE SE
 County Pottawatomie

API No. 15 — 149 — 20,033
 County Number

Operator
Anadarko Production Co.-Diamond-Shamrock Corp.

Address
P. O. Box 351, Liberal, Kansas 67901

Well No. 1 Lease Name STRAUB "A"

Footage Location
330 feet from (N) (S) line 330 feet from (E) (W) line

Principal Contractor B & N Drilling Company ~~Engineer~~ Walt Riggs

Spud Date 10 P.M. 5/3/76 Total Depth 3103' P.B.T.D. _____

Date Completed _____ Oil Purchaser _____

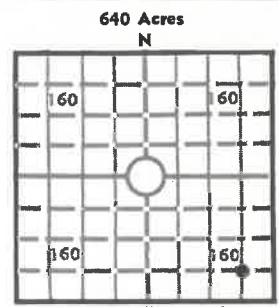

Locate well correctly
 Elev.: Gr. 967
 DF _____ KB _____

CASING RECORD

State Geological Survey
WICHITA BRANCH

Report of all strings set — surface, intermediate, production, etc.

Purpose of string	Size hole drilled	Size casing set (in O.D.)	Weight lbs/ft.	Setting depth	Type cement	Sacks	Type and percent additives
Surface	12-1/4"	8-5/8"	20#	163	Common	140	3% CaCl ₂

LINER RECORD

PERFORATION RECORD

Top, ft.	Bottom, ft.	Sacks cement	Shots per ft.	Size & type	Depth interval

TUBING RECORD

Size	Setting depth	Packer set at

ACID, FRACTURE, SHOT, CEMENT SQUEEZE RECORD

Amount and kind of material used	Depth interval treated

INITIAL PRODUCTION

Date of first production _____ Producing method (flowing, pumping, gas lift, etc.) _____

RATE OF PRODUCTION PER 24 HOURS	Oil	Gas	Water	Gas-oil ratio
	bbls.	MCF	bbls.	CFPB

Disposition of gas (vented, used on lease or sold) _____ Producing interval (s) _____

INSTRUCTIONS: As provided in KCC Rule 82-2-125, within 90 days after completion of a well, one completed copy of this Drillers Log shall be transmitted to the State Geological Survey of Kansas, 4150 Monroe Street, Wichita, Kansas 67209. Copies of this form are available from the Conservation Division, State Corporation Commission, 3830 So. Meridian (P.O. Box 17027), Wichita, Kansas 66217. Phone AC 316-522-2206. If confidential custody is desired, please note Rule 82-2-125. Drillers Logs will be on open file in the Oil and Gas Division, State Geological Survey of Kansas, Lawrence, Kansas 66044.

Operator: Anadarko Production Co., -Diamond-Shamrock Corp. DESIGNATE TYPE OF COMP.: OIL, GAS, DRY HOLE, SWDW, ETC.: Dry Hole

Well No. 1 Lease Name STRAUB "A"

S 29 T 9S R 11 E W

WELL LOG

Show all important zones of porosity and contents thereof; cored intervals, and all drill-stem tests, including depth interval tested, cushion used, time tool open, flowing and shut-in pressures, and recoveries.

SHOW GEOLOGICAL MARKERS, LOGS RUN, OR OTHER DESCRIPTIVE INFORMATION.

FORMATION DESCRIPTION, CONTENTS, ETC.	TOP	BOTTOM	NAME	DEPTH
Clay-Gravel-Lime	0	180		
Shale-Lime Streaks	180	1250		
Lime-Shale	1250	2767		
Lime	2767	3080		
Granite	3080	3103		

USE ADDITIONAL SHEETS, IF NECESSARY, TO COMPLETE WELL RECORD.

Date Received



Stanley R. Shoemaker
Signature

Stanley R. Shoemaker, Division Office Manager

Title

May 21, 1976

Date

54-4-112