

STATE CORPORATION COMMISSION OF KANSAS
OIL & GAS CONSERVATION DIVISION

WELL COMPLETION OR RECOMPLETION FORM
ACO-1 WELL HISTORY

DESCRIPTION OF WELL AND LEASE

Operator: License # 9705
Name Mid-American Hydrocarbon Inc.
Address 114 East Avenue North
Lyons, Kansas
City/State/Zip 67554

Purchaser.....

Operator Contact Person Don Teeters
Phone 316-257-5111

Contractor: License # 9421
Name Regis Brothers Drilling

Wellsite Geologist Howell Crenshaw
Phone 316-832-0870

Designate Type of Completion
 New Well Re-Entry Workover

Oil SWD Temp Abd
 Gas Inj Delayed Comp.
 Dry Other (Core, Water Supply etc.)

If OWWO: old well info as follows:
Operator Red Bents Oil
Well Name Brown
Comp. Date 1976 Old Total Depth 365

WELL HISTORY

Drilling Method:
 Mud Rotary Air Rotary Cable

4/18/86 Spud Date 4/21/86 Date Reached TD 4-21-86 Completion Date

4068 Total Depth 4200 PBDT

Amount of Surface Pipe Set and Cemented at 350 feet
Multiple Stage Cementing Collar Used Yes No
If yes, show depth set.....feet
If alternate 2 completion, cement circulated from.....feet depth to.....w/.....SX cmt

API NO. 15-105-01000-0001

County Lincoln

NE NE SW Sec 35. Twp 10S Rge 10W East West

2310 Ft North from Southeast Corner of Section
2970 Ft West from Southeast Corner of Section

(Note: Locate well in section plat below)

Lease Name Sulsar Well # 1

Field Name Wildcat

Producing Formation.....

Elevation: Ground 1523 KB 1528

Section Plat

JUN 24 1986
KANSAS GEOLOGICAL SURVEY
WICHITA BRANCH

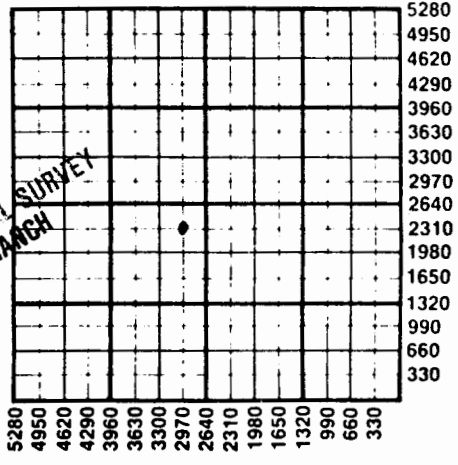

WATER SUPPLY INFORMATION

Disposition of Produced Water: Disposal Repressuring
Docket #

Questions on this portion of the ACO-1 call:
Water Resources Board (913) 296-3717

Source of Water:
Division of Water Resources Permit #.....

Groundwater.....Ft North from Southeast Corner (Well)Ft West from Southeast Corner of Sec Twp Rge East West

Surface Water.....Ft North from Southeast Corner (Stream, pond etc).....Ft West from Southeast Corner Sec Twp Rge East West

Other (explain) City (purchased from city, R.W.D. #)

INSTRUCTIONS: This form shall be completed in duplicate and filed with the Kansas Corporation Commission, 200 Colorado Derby Building, Wichita, Kansas 67202, within 90 days after completion or recompletion of any well. Rule 82-3-130 and 82-3-107 apply.

Information on side two of this form will be held confidential for a period of 12 months if requested in writing and submitted with the form. See rule 82-3-107 for confidentiality in excess of 12 months. One copy of all wireline logs and drillers time log shall be attached with this form. Submit CP-4 form with all plugged wells. Submit CP-111 form with all temporarily abandoned wells.

SIDE TWO

Operator Name Mid American Hydrocarbon Lease Name Salsar Well # 1

Sec. 35 Twp. 105 Rge. 10W East West County Lincoln

WELL LOG

INSTRUCTIONS: Show important tops and base of formations penetrated. Detail all cores. Report all drill stem tests giving interval tested, time tool open and closed, flowing and shut-in pressures, whether shut-in pressure reached static level, hydrostatic pressures, bottom hole temperature, fluid recovery, and flow rates if gas to surface during test. Attach extra sheet if more space is needed. Attach copy of log.

Drill Stem Tests Taken Yes No
Samples Sent to Geological Survey Yes No
Cores Taken Yes No

Formation Description Log Sample

3981 3412
3964 3399
3918 3384
3699 3363
3683 3355
3528 2996
3516 2944
3507
3501 No shows in any of the
3487 cores.
3479
3473
3471
3462
3432
3427
3418

Name	Top	Bottom
Heebner	2656	-1128
Kansing	2744	-1216
Marmaton	2994	-1466
Cherokee	3173	-1645
Mississippian	3354	-1826
Gilmore City	3520	-1992
Kinderhook	3550	-2022
Hunton	3630	-2102
Maquoketa	3640	-2112
Viola	3680	-2152
Simpson	3934	-2406
Arbuckle	3980	-2452

CASING RECORD New Used
Report all strings set-conductor, surface, intermediate, production, etc.

Purpose of String	Size Hole Drilled	Size Casing Set (in O.D.)	Weight Lbs/Ft.	Setting Depth	Type of Cement	#Sacks Used	Type and Percent Additives
Surface	12 1/4	8 5/8	23 lb	730'	Class A	60	N/A

PERFORATION RECORD

Shots Per Foot	Specify Footage of Each Interval Perforated	Acid, Fracture, Shot, Cement Squeeze Record (Amount and Kind of Material Used)	Depth

TUBING RECORD

Size	Set At	Packer at	Liner Run <input type="checkbox"/> Yes <input type="checkbox"/> No

Date of First Production _____ Producing Method Flowing Pumping Gas Lift Other (explain) _____