

KANSAS DRILLERS LOG

IMPORTANT
Kans. Geo. Survey request
samples on this well.

S. 8 T. 10 R. 15^W_W
Loc. SE NW
County Osborne

API No. 15 — 141 — 20,026
County Number

Operator
John O. Farmer, Inc.

Address
Box 352, Russell, Kansas 67665

Well No. #1 Lease Name Hachmeister

Footage Location
660 feet from (N) (S) line 660 feet from (E) (W) line

Principal Contractor John O. Farmer, Inc. Geologist Sam Farmer

Spud Date August 22, 1975 Total Depth 3580' P.B.T.D. D & A

Date Completed August 30, 1975 Oil Purchaser None - D & A

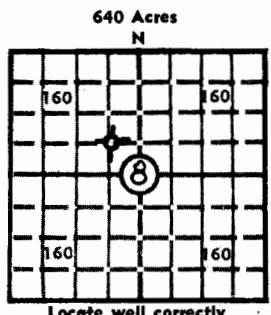

Locate well correctly
Elev.: Gr. 1926'
DF 1928' KB 1931'

CASING RECORD

Report of all strings set — surface, intermediate, production, etc.

| Purpose of string | Size hole drilled | Size casing set (in O.D.) | Weight lbs/ft. | Setting depth | Type cement | Sacks | Type and percent additives |
|-------------------|-------------------|---------------------------|----------------|---------------|-------------|-------|----------------------------|
| Surface | 12 1/4 | 8-5/8 | 26 | 212' | Common | 160 | |
| | | | | | | | |
| | | | | | | | |
| | | | | | | | |

LINER RECORD

PERFORATION RECORD

| Top, ft. | Bottom, ft. | Sacks cement | Shots per ft. | Size & type | Depth interval |
|----------|-------------|--------------|---------------|-------------|----------------|
| | | | | | |
| | | | | | |
| | | | | | |

TUBING RECORD

| Size | Setting depth | Packer set at |
|------|---------------|---------------|
| | | |
| | | |
| | | |

ACID, FRACTURE, SHOT, CEMENT SQUEEZE RECORD

| Amount and kind of material used | Depth interval treated |
|----------------------------------|------------------------|
| | |
| | |
| | |
| | |

INITIAL PRODUCTION

| | | | | | |
|--|-------|---|------------------------|---------------|--|
| Date of first production | | Producing method (flowing, pumping, gas lift, etc.) | | | |
| RATE OF PRODUCTION PER 24 HOURS | Oil | Gas | Water | Gas-oil ratio | |
| | bbls. | MCF | bbls. | CFPB | |
| Disposition of gas (vented, used on lease or sold) | | | Producing interval (s) | | |

INSTRUCTIONS: As provided in KCC Rule 82-2-125, within 90 days after completion of a well, one completed copy of this Drillers Log shall be transmitted to the State Geological Survey of Kansas, 4150 Monroe Street, Wichita, Kansas 67209. Copies of this form are available from the Conservation Division, State Corporation Commission, 3830 So. Meridian (P.O. Box 17027), Wichita, Kansas 66217. Phone AC 316-522-2206. If confidential custody is desired, please note Rule 82-2-125. Drillers Logs will be on open file in the Oil and Gas Division, State Geological Survey of Kansas, Lawrence, Kansas 66044.

Operator

John O. Farmer, Inc.

DESIGNATE TYPE OF COMP.: OIL, GAS, DRY HOLE, SWDW, ETC.:

Well No.

#1

Lease Name

Hachmeister

Dry Hole

S 8 T 10 R 15 W

WELL LOG

Show all important zones of porosity and contents thereof; cored intervals, and all drill-stem tests, including depth interval tested, cushion used, time tool open, flowing and shut-in pressures, and recoveries.

SHOW GEOLOGICAL MARKERS, LOGS RUN, OR OTHER DESCRIPTIVE INFORMATION.

| FORMATION DESCRIPTION, CONTENTS, ETC. | TOP | BOTTOM | NAME | DEPTH |
|---------------------------------------|------|--------|-----------------|---------------|
| | | | FORMATION TOPS: | |
| Shale & Sand | 0 | 60 | Topeka | 2881' (-950) |
| Shale | 60 | 245 | Heebner | 3117' (-1186) |
| Shale & Shells | 245 | 580 | Toronto | 3142' (-1211) |
| Sand | 580 | 710 | Lansing | 3164' (-1233) |
| Red Bed | 710 | 1090 | B/K.C. | 3451' (-1520) |
| Shale & Shells | 1090 | 1830 | Cong. Sand | 3536' (-1605) |
| Shale & Lime | 1830 | 1970 | Cong. Chert | 3548' (-1617) |
| Lime & Shale | 1970 | 2080 | T.D. | 3580' (-1649) |
| Shale & Lime | 2080 | 3055 | | |
| Lime & Shale | 3055 | 3140 | | |
| Lime | 3140 | 3470 | | |
| Shale & Lime | 3470 | 3555 | | |
| Chert | 3555 | 3580 | | |
| Total Depth | 3580 | | | |

DST #1 3185' to 3225'
 Tool open 30-30-30-30, weak blow
 20 min.
 Rec: 10' mud
 FP: 62-62
 BHP: 561-116
 Temp: 108°

USE ADDITIONAL SHEETS, IF NECESSARY, TO COMPLETE WELL RECORD.



John O. Farmer
 Signature
 President

September 3, 1975

Date

91600L