

STATE CORPORATION COMMISSION OF KANSAS
OIL & GAS CONSERVATION DIVISION

WELL COMPLETION OR RECOMPLETION FORM
ACO-1 WELL HISTORY

DESCRIPTION OF WELL AND LEASE

Operator: License # 6600
Name Don Karst Well Service, Inc.
Address 201 E. 29th
City/State/Zip Hays, KS 67601

Purchaser Farm and Industries
Bartlesville, OK 74006

Operator Contact Person Don Karst
Phone (913) 483-3958

Contractor: License # 8241
Name Emphasis Oil Operations

Wellsite Geologist
Phone

Designate Type of Completion

New Well Re-Entry Workover

Oil SWD Temp Abd
 Gas Inj Delayed Completion
 Dry Other (Core, Water Supply etc.)

If ONWO: old well info as follows:

Operator Lavanco Drilling, Inc.
Well Name Koelling #1
Comp. Date 5/10/85 Old Total Depth 3360'

WELL HISTORY

Drilling Method:

Mud Rotary Air Rotary Cable

Spud Date 8/6/85 Date Reached TD 8/8/85 Completion Date 8/27/85

Total Depth 3359' PBSD

Amount of Surface Pipe Set and Cemented at 564'
Multiple Stage Cementing Collar Used? Yes No
If yes, show depth set.....feet
If alternate 2 completion, cement circulated
from.....feet depth to.....w/.....SX cmt

API NO. 15-141-20-218A

22-10-1500

County Osborne

NW SW SE Sec 22 Twp 10 Rge 15 East West

990 Ft North from Southeast Corner of Section
2310 Ft West from Southeast Corner of Section

(Note: Locate well in section plat below)

Lease Name Koelling Well # 1

Field Name

Producing Formation Topeka - Lansing KC

Elevation: Ground 1781' KB 1786'

Section Plat

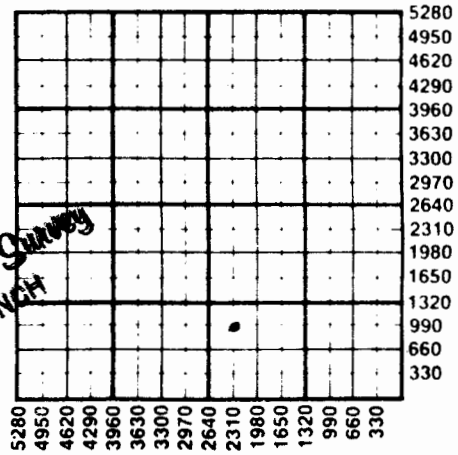

SEP 24 1985
State Geological Survey
WICHITA BRANCH

WATER SUPPLY INFORMATION

Disposition of Produced Water: Disposal
Docket # Repressuring

Questions on this portion of the ACO-1 call:

Water Resources Board (913) 296-3717

Source of Water:

Division of Water Resources Permit #.....

Groundwater.....Ft North from Southeast Corner
(Well)Ft West from Southeast Corner of
Sec Twp Rge East West

Surface Water 650 Ft North from Southeast Corner
(Stream, pond etc) 100 Ft West from Southeast Corner
Sec 22 Twp 10 Rge 15 East West

Other (explain).....
(purchased from city, R.W.D. #)

INSTRUCTIONS: This form shall be completed in duplicate and filed with the Kansas Corporation Commission, 200 Colorado Derby Building, Wichita, Kansas 67202, within 90 days after completion or recompletion of any well. Rule 82-3-130 and 82-3-107 apply.

Information on side two of this form will be held confidential for a period of 12 months if requested in writing and submitted with the form. See rule 82-3-107 for confidentiality in excess of 12 months.

SIDE TWO

Operator Name Don Karst Well Service, Inc. Lease Name..... Koelling..... Well #.....

70029

22 10 15 East West County..... Osborne

Date of First Production 8-27-85	Producing Method <input type="checkbox"/> Flowing <input checked="" type="checkbox"/> Pumping <input type="checkbox"/> Gas Lift <input type="checkbox"/> Other (explain).....				
Estimated Production Per 24 Hours	Oil	Gas	Water	Gas-Oil Ratio	Gravity
	50 Bbls		23 MCF		39 CFPB

Drill Stem Tests Taken Yes No
 Samples Sent to Geological Survey Yes No
 Cores Taken Yes No

Formation Description
 Log Sample

Name	Top	Bottom
Topeka	2660'	-874
Heebner	2903'	-1117
Toronto	2927'	-1141
LKC	2956'	-1170
BKC	3220'	-1434
Conglomerate	3310'	-1524

METHOD OF COMPLETION

Production Interval

Disposition of gas: Vented Sold Used on Lease
 Open Hole Perforation Other (Specify)
 Dually Completed Commingled

2690-98'
 2982-86'

CASING RECORD <input type="checkbox"/> New <input type="checkbox"/> Used							
Report all strings set-conductor, surface, intermediate, production, etc.							
Purpose of String	Size Hole Drilled	Size Casing Set (in O.D.)	Weight Lbs/Ft.	Setting Depth	Type of Cement	#Sacks Used	Type and Percent Additives
..... Surface..... 12-1/4..... 8-5/8"..... Previously set.....
..... Production..... 7-7/8..... 4-1/2..... 9-1/2..... 3350..... 50/40POZ..... 200..... 10% salt.....
PERFORATION RECORD				Acid, Fracture, Shot, Cement Squeeze Record			
Shots Per Foot	Specify Footage of Each Interval Perforated			(Amount and Kind of Material Used)		Depth	
..... 4..... 2690-98'.....		 4000 gal. 15% HC.....	 8'.....	
..... 4..... 2984-3000 Limited Entry (2982-86).....		 4500 gal. 20% HC.....	 4'.....	
.....	
.....	
TUBING RECORD				Liner Run <input type="checkbox"/> Yes <input type="checkbox"/> No			
Size	Set At	Packer at					
2 3/8	3326'						

22-10-154

EMPHASIS OIL OPERATIONS

P. O. Box 506

Russell, KS 67665

DRILLERS LOG

OPERATOR: Don Karst Well Service, Inc.
201 E. 29th
Hays, KS 67601

CONTRACTOR: Emphasis Oil Operations
Box 506
Russell, KS 67665

LEASE: Koelling

WELL #1 "OWWO" ✓

LOCATION: NW SW SE
Section 22-10S-15W
Osborne County, Kansas

SEP 24 1985

State Geological Survey
WICHITA BRANCH

Rotary Total Depth: 3359'

Elevation:

Completed: 8/6/85

Completed: 8/8/85

Casing: 8-5/8" @ 564' previously set

Status: Oil Well

DEPTHS & FORMATIONS

(All measurements from K.B.)

Cement	40'	Cement, mud & cavings	340'
Mud & cavings	150'	Cement	520'
Cement	230'	Mud & cavings (R.T.D.)	3359'

STATE OF KANSAS)
) ss
COUNTY OF RUSSELL)

Joe K. Branum, of Emphasis Oil Operations, states that the above and foregoing is a true and correct log of the above captioned well, to the best of his knowledge.

Joe K. Branum