

26-10-18 W

STATE CORPORATION COMMISSION OF KANSAS
OIL & GAS CONSERVATION DIVISION

WELL COMPLETION OR RECOMPLETION FORM
ACO-1 WELL HISTORY

DESCRIPTION OF WELL AND LEASE

Operator: license # 8925
name Liberty Operations & Completions
address 308 West Mill
City/State/Zip Plainville, Ks 67663

Operator Contact Person Charles G. Comeau
Phone 913-434-4686

Contractor: license # 5665
name Pioneer Drilling Company, Inc.

Wellsite Geologist Kevin Adams
Phone 913-628-6698

PURCHASER

Date Type of Completion
 New Well Re-Entry Workover

- Oil SWD Temp Abd
- Gas Inj Delayed Comp.
- Dry Other (Core, Water Supply etc.)

If OWWO: old well info as follows:
Operator
Well Name
Comp. Date Old Total Depth

WELL HISTORY

Drilling Method: Mud Rotary Air Rotary Cable
8-31-84 8-30-84 8-30-84
Spud Date Date Reached TD Completion Date

3750' PBT
Total Depth PBT

Amount of Surface Pipe Set and Cemented at 8/58" @ 219' feet

Multiple Stage Cementing Collar Used? Yes No

If Yes, Show Depth Set feet

If alternate 2 completion, cement circulated from feet depth to w/ SX cmt

Will be by record

API NO. 15-163-22,447
County Rooks

SW. SW. NW. Sec 26 Twp 10S Rge 18
(location)

2970 Ft North from Southeast Corner of Section
4950 Ft West from Southeast Corner of Section
(Note: locate well in section plat below)

Lease Name Shepard "B" Well# 1

Field Name

Producing Formation

Elevation: Ground 2038' KB 2043'

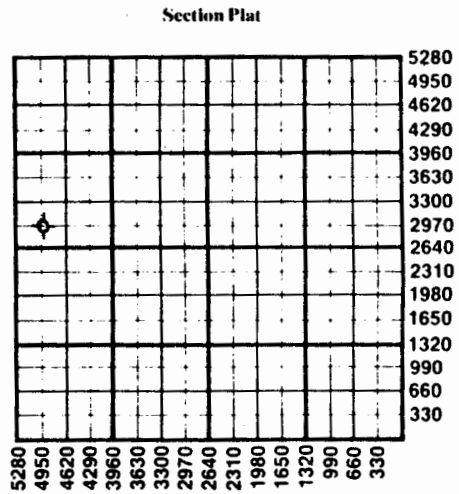

WATER SUPPLY INFORMATION

Source of Water:
Division of Water Resources Permit #

Groundwater Ft North From Southeast Corner and (Well) Ft West From Southeast Corner of Sec Twp Rge East West

Surface Water Ft North From Southeast Corner and (Stream, Pond etc.) Ft West From Southeast Corner Sec 19 Twp 10SRge 18 East West

Other (explain) (purchased from city, R.W.D.#)

Disposition of Produced Water: Disposal Repressuring

Docket #

INSTRUCTIONS: This form shall be completed in duplicate and filed with the Kansas Corporation Commission, 200 Colorado Derby Building, Wichita, Kansas 67202, within 90 days after completion or recompletion of any well. Rules 82-3-130 and 82-3-107 apply.

Information on side two of this form will be held confidential for a period of 12 months if requested in writing and submitted with the form. See rule 82-3-107 confidentiality in excess of 12 months.

Copy of all wireline logs and drillers time log shall be attached with this form. Submit CP-4 form with all plugged wells. Submit CP-111 form witharily abandoned wells.

SEP 19 1984

SIDE TWO

72681

Operator Name Liberty Operations & Completions, Inc. Lease Name Shepard "B" Well# 1 SEC. 26 TWP. 10s RGE. 18 East West

WELL LOG

INSTRUCTIONS: Show important tops and base of formations penetrated. Detail all cores. Report all drill stem tests giving interval tested, time tool open and closed, flowing and shut-in pressures, whether shut-in pressure reached static level, hydrostatic pressures, bottom hole temperature, fluid recovery, and flow rates if gas to surface during test. Attach extra sheet if more space is needed. Attach copy of log.

Drill Stem Tests Taken Yes No
 Samples Sent to Geological Survey Yes No
 Cores Taken Yes No

Formation Description
 Log Sample

LOG TOPS

ANHYDRITE	1398 (+645)
TOPEKA	3036 (-993)
HEEBNER	3257 (-1214)
TORONTO	3274 (-1231)
LANSING/KC	3300 (-1257)
BASE/KC	3523 (-1480)
ARBUCKLE	3686 (-1643)

Name	Top	Bottom
shale	0'	219'
shale and sand	219'	1380'
shale	1380'	1390'
anhydrite	1399'	144'
shale	1440'	1608'
shale	1608'	2048'
shale	2048'	2371'
shale	2371'	2636'
shale	2636'	286'
shale	2860'	3095'
shale	3095'	3240'
shale	3240'	3347'
shale	3347'	3433'
shale	3433'	3477'
shale and lime	3477'	3580'
shale and lime	3580'	3667'
shale and lime	3667'	3750'
	3750'	R.T.D.

CASING RECORD <input checked="" type="checkbox"/> new <input type="checkbox"/> used							
Report all strings set - conductor, surface, intermediate, production, etc.							
Purpose of string	size hole drilled	size casing set (in O.D.)	weight lbs/ft.	setting depth	type of cement	# sacks used	type and percent additives
Surface Casing	12. 1/4"	8. 5/8"	20#	219'	60-40pos	135	2%gel 3%cc
PERFORATION RECORD				Acid, Fracture, Shot, Cement Squeeze Record			
shots per foot	specify footage of each interval perforated			(amount and kind of material used)			Depth