

**KANSAS DRILLERS LOG**

State Geological Survey  
WICHITA, BRANCH

S. 6 T. 10 R. 19 <sup>E</sup> W

Loc. S2 NW NW

County Rooks

API No. 15 — 163 — 20,631  
County Number

Operator  
F & M Oil Co., Inc.

Address  
505 Union Center Wichita, Kansas 67202

Well No. #1 Lease Name Childs

Footage Location  
feet from (N) (S) line feet from (E) (W) line

Principal Contractor Duke Drilling Geologist Harlan Dixon

Spud Date 10-4-76 Total Depth 3840 P.B.T.D.

Date Completed 10-11-76 Oil Purchaser

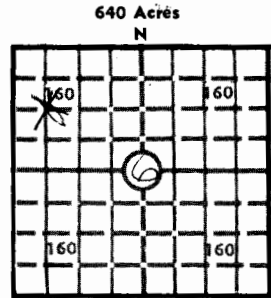

Locate well correctly

Elev.: Gr. 2228

DF 2230 KB 2233

APR 07 1977

**CASING RECORD**

Report of all strings set — surface, intermediate, production, etc.

Purpose of string	Size hole drilled	Size casing set (in O.D.)	Weight lbs/ft.	Setting depth	Type cement	Sacks	Type and percent additives
surface		8 5/8		250	common	160	2% gel 3% Ca. Cl

**LINER RECORD**

**PERFORATION RECORD**

Top, ft.	Bottom, ft.	Sacks cement	Shots per ft.	Size & type	Depth interval

**TUBING RECORD**

Size	Setting depth	Packer set at

**ACID, FRACTURE, SHOT, CEMENT SQUEEZE RECORD**

Amount and kind of material used	Depth interval treated

**INITIAL PRODUCTION**

Date of first production		Producing method (flowing, pumping, gas lift, etc.)			
RATE OF PRODUCTION PER 24 HOURS	Oil bbls.	Gas MCF	Water bbls.	Gas-oil ratio	CFPB
Disposition of gas (vented, used on lease or sold)			Producing interval (s)		

INSTRUCTIONS: As provided in KCC Rule 82-2-125, within 90 days after completion of a well, one completed copy of this Drillers Log shall be transmitted to the State Geological Survey of Kansas, 4150 Monroe Street, Wichita, Kansas 67209. Copies of this form are available from the Conservation Division, State Corporation Commission, 3830 So. Meridian (P.O. Box 17027), Wichita, Kansas 66217. Phone AC 316-522-2206. If confidential custody desired, please note Rule 82-2-125. Drillers Logs will be on open file in the Oil and Gas Division, State Geological Survey of Kansas, Lawrence, Kansas 44.

ator

F & M OIL CO., INC.

DESIGNATE TYPE OF COMP.: OIL, GAS,  
DRY HOLE, SWDW, ETC.:  
Dry & abandoned

Well No. 1	Lease Name Childs
S <u>6</u> T <u>10S</u> R <u>19</u> W <u>WE</u>	

**WELL LOG**

Show all important zones of porosity and contents thereof; cored intervals, and all drill-stem tests, including depth interval tested, cushion used, time tool open, flowing and shut-in pressures, and recoveries.

SHOW GEOLOGICAL MARKERS, LOGS RUN, OR OTHER DESCRIPTIVE INFORMATION.

FORMATION DESCRIPTION, CONTENTS, ETC.	TOP	BOTTOM	NAME	DEPTH
DST #1 3816-3923, 20-20-20-20 Weak 10 minute blow. Recovered 375' mud. FP's 244 and 244, BHP's 825-750			Log Tops: Anhydrite Heebner Topeka Toronto Lansing B/Kansas City Cherty Cong. Arbuckle Log T. D.	1650 (+ 583) 3441 (-1208) 3234 (-1001) 3466 (-1233) 3483 (-1280) 3695 (-1462) 3748 (-1515) 3815 (-1582) 3835 (-1602)

USE ADDITIONAL SHEETS, IF NECESSARY, TO COMPLETE WELL RECORD.

Date Received	Signature
	Title
	Date

617 82L