

15-163-20836

State Geological Survey

WICHITA BRANCH

KANSAS DRILLERS LOG

API No. 15 — 163 — 20,836
County Number

S. 26 T. 10 R. 19 NE W
Loc. NE SE SW
County Rooks

Operator
Arrowhead Petroleum, Inc.

Address
P. O. Box 8287 Munger Station Wichita, Kansas 67208

Well No. #1 Lease Name Sutor

Footage Location
990 feet from (S) line 2,310 feet from (E) line

Principal Contractor Big Springs Geologist E. J. Schierling

Spud Date 8-24-78 Total Depth 3,628 P.B.T.D.

Date Completed 9-2-78 Oil Purchaser Koch

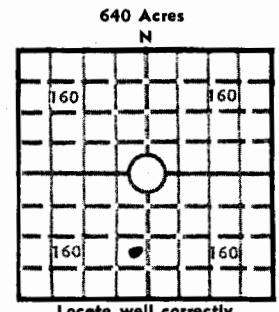

Elev.: Gr. _____
DF _____ KB 2,106

CASING RECORD

Report of all strings set— surface, intermediate, production, etc.

Purpose of string	Size hole drilled	Size casing set (in O.D.)	Weight lbs/ft.	Setting depth	Type cement	Sacks	Type and percent additives
Surface	12 1/4	8 5/8		248		165	
Production	7 7/8	4 1/2		3,627		125	

LINER RECORD

PERFORATION RECORD

Top, ft.	Bottom, ft.	Sacks cement	Shots per ft.	Size & type	Depth interval
					3501-04
					3,466-70
					3,368-72

TUBING RECORD

Size	Setting depth	Packer set at
2 7/8	3414	

ACID, FRACTURE, SHOT, CEMENT SQUEEZE RECORD

RE AP 3377-80

Amount and kind of material used	Depth interval treated
3,000 AC	3,501-04, 3,466-70
1,000 AC	3,368-72

INITIAL PRODUCTION

Date of first production 12-31-78 Producing method Pumping (flowing, pumping, gas lift, etc.)

RATE OF PRODUCTION PER 24 HOURS
Oil 3 bbls. Gas NA MCF Water 50 bbls. Gas-oil ratio NR CFPB

Disposition of gas (vented, used on lease or sold) _____ Producing interval(s) _____

INSTRUCTIONS: As provided in KCC Rule 82-2-125, within 90 days after completion of a well, one completed copy of this Drillers Log shall be transmitted to the State Geological Survey of Kansas, 4150 Monroe Street, Wichita, Kansas 67209. Copies of this form are available from the Conservation Division, State Corporation Commission, 3830 So. Meridian (P.O. Box 17027), Wichita, Kansas 66217. Phone AC 316-522-2206. If confidential custody is desired, please note Rule 82-2-125. Drillers Logs will be on open file in the Oil and Gas Division, State Geological Survey of Kansas, Lawrence, Kansas 66044.

DESIGNATE TYPE OF COMP.: OIL, GAS, DRY HOLE, SWDW, ETC.:

Operator **Arrowhead Petroleum**

Well No. **#1**

Lease Name **Sutor**

0.1

S **26**T **10**R **19**^E_W

WELL LOG

Show all important zones of porosity and contents thereof; cored intervals, and all drill-stem tests, including depth interval tested, cushion used, time tool open, flowing and shut-in pressures, and recoveries.

SHOW GEOLOGICAL MARKERS, LOGS RUN, OR OTHER DESCRIPTIVE INFORMATION.

FORMATION DESCRIPTION, CONTENTS, ETC.	TOP	BOTTOM	NAME	DEPTH
DST #1 3,015-38 30-45-60-60 ISIP - 830 FSIP - 809 IFP - 43-43 FFP - 65-86 Rec. 10' UHO + 6CM	Top HEEB TOR LANS BAC ARB RTD	3,035 3,245 3,274 3,294 3,511 3,623 3,628		
DST #2 3,250-3,340 30-45-45-45 ISIP 1195 FSIP 1173 IFP 86-140 FFP 184-259 Rec. 491' UHO + 6CM W				
DST #3 3,350-97 30-45-45-45 ISIP 959 FSIP 948 IFP 151-573 FFP 627-852 Rec. 100' GIP 1800' G + MCSW				
DST #4 3,431-75 30-45-45-45 ISIP 1141 FSIP 1013 IFP 54-54 FFP 65-65 Rec. 70' UHO CM				
DST #5 3,475-3,515 30-45-45-60 ISIP 1013 FSIP 981 IFP 43-43 FFP - 65-65 Rec. 1' 0,5' ocm 75' MCSW				
		DST #6 3,624-30 30-30-30-30 ISIP 1120 FSIP 1120 IFP 54-783 FFP 959-1120 Rec. 15' ocm 2,225' SOCM		

USE ADDITIONAL SHEETS, IF NECESSARY, TO COMPLETE WELL RECORD.

Date Received

JW Shuttard
Signature

Vice - Pres
Title

7/16/79
Date

Date

bhTEL

Duplicate

15-163-20836

BIG SPRINGS DRILLING, INC.

P.O. BOX 8287
MUNGER STATION
WICHITA, KANSAS 67208

SUITE 29 • 400 NORTH WOODLAWN • (316) 681-1732

26-10-19W

September 7, 1978

DRILLERS LOG

Re: Arrowhead Petroleum, Inc.
Sutor No. 1
NE SE SW
Sec 26 twp10S Rg 19W
Rooks County, Kansas

OPERATOR: Arrowhead Petroleum, Inc.
CONTRACTOR: Big Springs Drilling, Inc.
COMMENCED: 8-24-78
COMPLETED: 9-3-78

Surface Pipe: 248' of 8 5/8" W/165 sx common 2% gel 3% ccl

0	249	Post Rock, Clay and Shale
249	1449	Shale, Shells and Sand
1449	1478	Anhydrite
1478	2330	Shale and Lime
2330	2772	Lime and Shale
2772	2917	Lime
2917	3117	Lime and Shale
3117	3397	Lime and Shale
3397	3630	Lime
3630		RTD

RECEIVED
STATE CORPORATION COMMISSION

SEP 08 1978

CONSERVATION DIVISION
Wichita, Kansas

We Certify that the above and foregoing is a true and correct copy of the log on the #1 Sutor located in Rooks County, Kansas.

BIG SPRINGS DRILLING, INC.

Paul A. Seymour, Jr.

Subscribed and sworn to before me this 7th day of September, 1978.

Ruth M. Bassett Notary Public

My Commission expires:

May 30, 1979