

State Geological Survey

WICHITA BRANCH

KANSAS DRILLERS LOG

15-163-20708

API No. 15 _____
County _____ Number _____

S. 35 T. 10s R. 19 ^N/_W
Loc. 950' fnl & 1450' fw1 NE
County Rooks

Operator Murfin Drilling Company		
Address 617 Union Center, Wichita, Ks 67202		
Well No. 2	Lease Name JOHNSON "B"	
Footage Location 950 feet from (N) (X) line 1450 feet from (X) (W) line NE		
Principal Contractor Murfin Drilling		Geologist Charles Spradlin
Spud Date 6/17/77	Total Depth 3640'	P.B.T.D. 3607'
Date Completed 7/26/77	Oil Purchaser American Petrofina	

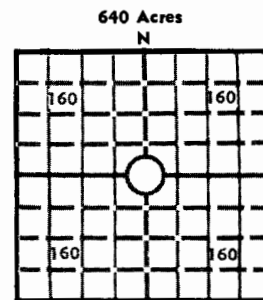

Elev.: Gr. 2107'
DF _____ KB _____

CASING RECORD

Report of all strings set — surface, intermediate, production, etc.

Purpose of string	Size hole drilled	Size casing set (in O.D.)	Weight lbs/ft.	Setting depth	Type cement	Sacks	Type and percent additives
Surface	12 1/4"	8 5/8"	24#	162'		150	
Production	7 7/8"	4 1/2"	9.5#	3636'	Cl. A, 10% salt Cl. A Latex	150 50	+ 3/4% CFR-2

LINER RECORD

PERFORATION RECORD

Top, ft.	Bottom, ft.	Sacks cement	Shots per ft.	Size & type	Depth interval
			4	Golden Jets	3065-71, 3166-72, 3433-38, 3441-46, 3453-55, 3464-66, 3473-76, 3489-94, 3498-3502 & 3510-14'

Size	Setting depth	Packer set at
EUE 2 3/8"	3525.19'	--

ACID, FRACTURE, SHOT, CEMENT SQUEEZE RECORD

Amount and kind of material used	Depth interval treated
3000 gallons of SS-20 acid	above perforations

INITIAL PRODUCTION

Date of first production		Producing method (flowing, pumping, gas lift, etc.) Pumping			
RATE OF PRODUCTION PER 24 HOURS	Oil 11.52 bbls.	Gas MCF	Water 46.08 bbls.	Gas-oil ratio CFPB	
Disposition of gas (vented, used on lease or sold)			Producing interval (s)		

INSTRUCTIONS: As provided in KCC Rule 82-2-125, within 90 days after completion of a well, one completed copy of this Drillers Log shall be transmitted to the State Geological Survey of Kansas, 4150 Monroe Street, Wichita, Kansas 67209. Copies of this form are available from the Conservation Division, State Corporation Commission, 3830 So. Meridian (P.O. Box 17027), Wichita, Kansas 66217. Phone AC 316-522-2206. If confidential custody is desired, please note Rule 82-2-125. Drillers Logs will be on open file in the Oil and Gas Division, State Geological Survey of Kansas, Lawrence, Kansas 66044.

Operator **Murfin Drilling** DESIGNATE TYPE OF COMP.: OIL, GAS, DRY HOLE, SWDW, ETC.: **Oil**

Well No. **2** Lease Name **JOHNSON "B"**

S 35 T 10s R 19 ^E/_W

WELL LOG

Show all important zones of porosity and contents thereof; cored intervals, and all drill-stem tests, including depth interval tested, cushion used, time tool open, flowing and shut-in pressures, and recoveries.

SHOW GEOLOGICAL MARKERS, LOGS RUN, OR OTHER DESCRIPTIVE INFORMATION.

FORMATION DESCRIPTION, CONTENTS, ETC.	TOP	BOTTOM	NAME	DEPTH
sand, clay		115	Anhydrite	1410 +702
shale		825	base Anhy	1442 +670
sand, shale		1440	Towanda	2172 +60
shale		2195	B/Florence	2258 -146
shale, lime		2350	Wreford	2326 -214
shale		2510	Neva	2503 -391
shale, lime		3280	Red Eagle	2592 -480
lime		3618	Stotler	2848 -736
lime w/chert		3640	Tarkio	2892 -780
RTD		3640	Topeka	3038 -926
			Heebner	3256 -1144
			Toronto	3284 -1172
			Lansing	3301 -1189
			Base/KC	3530 -1418
			Marmaton	3538 -1426
			Conglomerate	3556 -1444
			Simpson	3594 -1482
			Arbuckle	-----
			RTD	3640 -1528
DST #1: 3260-3350/30-45-45-60, 30' M. DST #2: 3349-80/30-30-30-30, 10' M w/SpO, 707-45/45-45/45-321, 102 ^o . DST #3: 3420-85/30-30-30-30, 65' SOSpMW, 2006-45/68-68/68-2006#, HP 2018-2018, 103 ^o . DST #4: 3485-3527/30-30-30-30, 20' SOCM, 786-34/34-45/45-309. DST #5: 3532-3640/30-45-45-60, 200' WM, 1101-91-114-110}. DST #6: (straddle) 3052-92/misrun.				

USE ADDITIONAL SHEETS, IF NECESSARY, TO COMPLETE WELL RECORD.

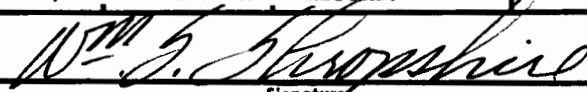
Date Received	
	Signature
	Wm. S. Shropshire, Asst. Gen. Mgr.
	Title
	October 5, 1977
	Date

8892L