

Section 20 Township 10 Range 23W

Well No. #1 C. Brown

Company Mid-Continent Petroleum

NORTH

							0

WEST

EAST

SOUTH

SEC: **HOT FILE** P.W.P. R. 20 10S 23W ✓

WELL NO. 1 Celestin Brown FARM

COMPANY MCPC

CONTRACTOR Gabbert-Jones Drlg. Co.

Happy Pool
Ft. from N. Line

330 Ft. from S. Line

330 Ft. from E. Line

Ft. from W. Line

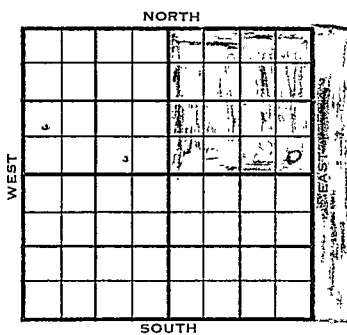

~~E/2-NE~~ SE SE NE

	ELEVATION	REPORT
1954	2400' DF	
4/22	Location	(DR)
4/23	RUR	"
4/26	Spud 4-23-54. 8-5/8" @ 236	
	Drlg. 2345'	"
4/27	Drlg. 3025'	"
4/27	Spud 4-23-54	
	8" @ 235' Drlg. 3409' (F.R. Ticket)	
4/29	Drlg. 3740'	(DR)
4/30	TD 3835'	
	DST 3815-35, open 1 hr, gas in 19",	
	oil in 35", rec 3200' oil. (DR)	
5/1	Lansing 3662'	
	DST 3815-35, open 1 hr gas in 19 mins,	
	Flowed a little mud & oil in 35 mins.	
	SD until morning. Filled up 3200'	
	oil. Grav. 42.3 @ 68 deg.	
	BHP 1320# in 20".	
	DST 3843-82, open 1 hr, gas in 55 mins,	
	rec 700' oil, 63' oily mud. BHP 1040#	
	Plan to drill to 3898' & set pipe.	
	(Ltr. McGehee)	
5/3	TD 3898'. 5 1/2" @ 3897' w/175 sax. (DR)	
5/4	TD 3898' WOC	"

OVER

1954
 5/5 TD 3898' Moving in cable tools (DR)
 5/6 TD 3898' Bailing mud. "
 5/7 TD 3898' Drilling plugs. "
 5/10 TD 3898'. Perf 3822-34 w/72 shots.
 Perf 3840-52 w/72 shots.
 Perf 3860 $\frac{1}{2}$ -68 $\frac{1}{2}$ w/48 shots. "
 5/10 Perf 48/3860 $\frac{1}{2}$ -3868 $\frac{1}{2}$
 72/3840-52 72/3832-34
 F/43 BOPH 3 hr, open casing
 1500 Acid. Rng. tubing to Swab
 down. (Wire)
 5/11 TD 3898' Testing. (DR)
 5/12 TD 3898' Testing. "
 5/13 TD 3898' WO State test. "
 5/14 TD 3898' WO State test. "
 5/17 TD 3898' WO State test. "
 5/18 TD 3898' Taking potential "
 5/19 TD 3898' Comp. 5-19-54 "
 Potential: 463 BOPD "
 5/27 Completed for a state test of 3000
 BOPD (Ltr-McGehee)
 5/26 Spud 4-23-54 - Oil Well
 TD 3898'
 8" @ 236'
 Heeb 3626', Tor 3645', ans 3662'
 DST. 3815-35', opn 1 hr., gas in 19",
 FU 3200' oil, 1320#
 DST 3843-82', opn 1 hr., gas in 55",
 rec. 700' oil, 63' mudd oil, 1040#
 TD 3898'
 5" @ 3897'
 48/3860-68, 72/3840-52, 72/3822-34
 F/43 BOPH 3 hrs., 1500A,
 F/56 bo 1 hrs.
 Comp. 3000 BOPD
 BHB Test 7799 BOPD

COMPLETED

LOCATION NOTICE

TULSA, OKLA., April 21, 1954

WELL NO. 1 ON Celestin Brown FARM

WILL BE AS FOLLOWS:

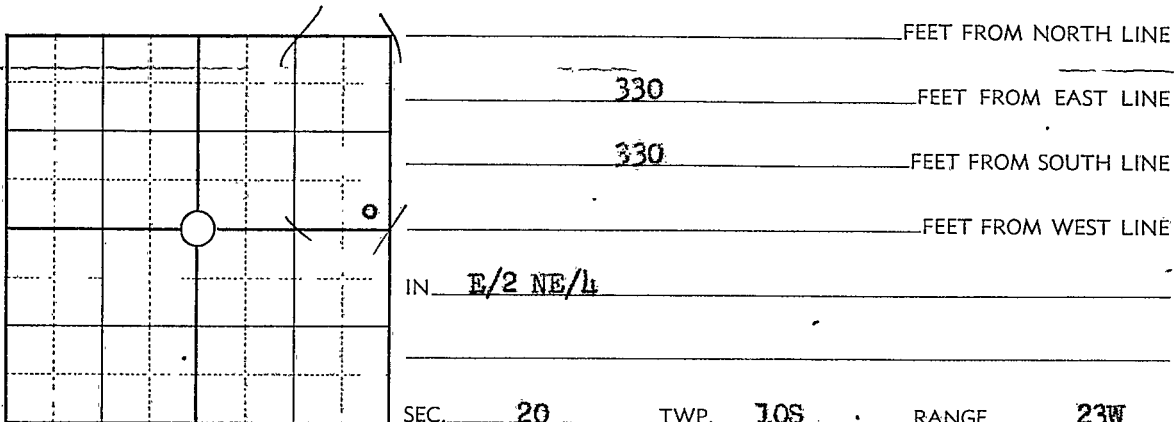

Graham COUNTY, STATE OF Kansas

REMARKS: R.I. Mankey; R.O. Bobey

M.G.P.G. ----- 100%

Lease also covers E/2 NW/4 Sec. 21,

COPIES TO:

- R. W. McDOWELL
- DISTRICT SUPT.
- ACCOUNTING DEPT.
- ✓ SCOUTING DEPT.
- GEOLOGICAL DEPT.
- PIPE LINE DEPT.
- MATERIALS DEPT.
- RENTAL DEPT.
- LEGAL DEPT.
- LEO MEYER
- INCOME TAX DEPT.
- ENGINEERING DEPT.
- LEASE INVENTORY
- CLAIM DEPT.
- J. W. BASORE
- FILE

SIGNED A. E. Pierce

W

Card made

4/23/54

A.E.P.

59