

\* Corrected ACO-1  
24-10-20W 2nd

STATE CORPORATION COMMISSION OF KANSAS  
OIL & GAS CONSERVATION DIVISION

WELL COMPLETION OR RECOMPLETION FORM  
ACO-1 WELL HISTORY

DESCRIPTION OF WELL AND LEASE

Operator: License # 5020  
Name Rine Exploration Company  
Address Suite #645  
300 W. Douglas  
City/State/Zip Wichita, KS 67202

\* Purchaser ~~AT&T~~ Mobil Oil  
KCKC KCKC

Operator Contact Person M. Bradford Rine  
Phone 316/262-5418

Contractor: License # 5422  
Name Abercrombie Drilling, Inc.

Wellsite Geologist Steve Kriedler  
Phone 316/265-5370

Designate Type of Completion

- New Well  Re-Entry  Workover
- Oil  SWD  Temp Abd
- Gas  Inj  Delayed Comp.
- Dry  Other (Core, Water Supply etc.)

If OWWO: old well info as follows:

Operator  
Well Name  
Comp. Date Old Total Depth

WELL HISTORY

Drilling Method:  
 Mud Rotary  Air Rotary  Cable

08/27/85	09/02/85	09/03/85
Spud Date	Date Reached TD	Completion Date
3696'	3690'	
Total Depth	PBTD	

Amount of Surface Pipe Set and Cemented at 305' feet  
Multiple Stage Cementing Collar Used?  Yes  No  
If yes, show depth set...feet  
If alternate 2 completion, cement circulated from...feet depth to...w/...SX cmt

API NO. 15-163-22,742  
County Rooks  
NW 1/4 SE 1/4 SW 1/4 Sec. 24 Twp. 10S Rge. 20W  East  West

990 Ft North from Southeast Corner of Section  
3630 Ft West from Southeast Corner of Section  
(Note: Locate well in section plat below)

Lease Name Sutor Well # 1-24

Field Name Marcotte

Producing Formation Arbuckle

Elevation: Ground 2128' KB 2133'

Section Plat

DEC 07 1985  
State Geological Survey  
WICHITA BRANCH

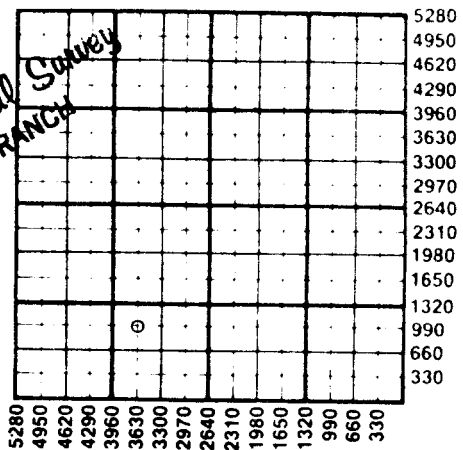

WATER SUPPLY INFORMATION

Disposition of Produced Water:  Disposal  Repressuring  
Docket #

Questions on this portion of the ACO-1 call:

Water Resources Board (913) 296-3717

Source of Water:  
Division of Water Resources Permit #

Groundwater...Ft North from Southeast Corner (Well) ...Ft West from Southeast Corner of Sec Twp Rge  East  West

Surface Water...850 Ft North from Southeast Corner (Stream, pond etc.) 3630 Ft West from Southeast Corner Sec 24 Twp 10S Rge 20  East  West

Other (explain) (purchased from city, R.W.D. #)

INSTRUCTIONS: This form shall be completed in duplicate and filed with the Kansas Corporation Commission, 200 Colorado Derby Building, Wichita, Kansas 67202, within 90 days after completion or recompletion of any well. Rule 82-3-130 and 82-3-107 apply.

Information on side two of this form will be held confidential for a period of 12 months if requested in writing and submitted with the form. See rule 82-3-107 for confidentiality in excess of 12 months.

One copy of all wireline logs and drillers time log shall be attached with this form. Submit CP-4 form with plugged wells. Submit CP-111 form with all temporarily abandoned wells.

75635

SIDE TWO

Operator Name RINE EXPLORATION COMPANY Lease Name Sutor Well # 1-24

24 10 South 20 West  East  West County Rocks

Date of First Production Approx. Oct. 15, 1985	Producing Method <input type="checkbox"/> Flowing <input checked="" type="checkbox"/> Pumping <input type="checkbox"/> Gas Lift <input type="checkbox"/> Other (explain).....				
Estimated Production Per 24 Hours	Oil 50 Bbls	Gas -0- MCF	Water Trace Bbls	Gas-Oil Ratio CFPB	Gravity

Drill Stem Tests Taken  Yes  No  
 Samples Sent to Geological Survey  Yes  No  
 Cores Taken  Yes  No

Formation Description  
 Log  Sample

DST #1 / 3160'-3206' (Topeka) 30-45-45-60. Weak blow, rec. 120' watery cut mud with slight show of oil.  
 IFP 21 - 21 ISIP 690  
 FFP 32 - 32 FSIP 679

DST #2 / 3527'-3657' (KC-Marm.) 30-30-30-30. Weak blow died in 20 min., rec. 10' mud.  
 IFP 32 - 32 ISIP 345  
 FFP 43 - 43 FSIP 226

DST #3 / 3636'-3696' (Arbuckle) 30-60-30-60. Strong blow, rec. 154' oil cut mud, 124' heavy oil and gas cut mud - 65% oil, 434' gassy oil.  
 IFP 86 - 216 ISIP 1055  
 FFP 280 - 313 FSIP 1012

Name	Top	Bottom
<u>SAMPLE TOPS</u>		
Anhydrite	1553	+ 580
Base Anhydrite	1586	+ 547
Topeka	3143	-1010
Heebner	3352	-1219
Lansing	3390	-1257
Base Kansas City	3597	-1464
Arbuckle	3692	-1559
RTD	3696	-1563
<u>E-LOG TOPS</u>		
Anhydrite	1551	+ 582
Base Anhydrite	1589	+ 544
Topeka	3143	-1010
Heebner	3351	-1218
Lansing	3389	-1256
Base Kansas City	3597	-1464
Arbuckle		Not on Log
LTD	3696	-1563

METHOD OF COMPLETION

Open Hole  Perfora  
 Other (Specify) .....

State Geological Survey  
 WICHITA BRANCH  
 7 1985

CASING RECORD  New  Used  
 Report all strings set-conductor, surface, intermediate, production, etc.

Purpose of String	Size Hole Drilled	Size Casing Set (in O.D.)	Weight Lbs/Ft.	Setting Depth	Type of Cement	#Sacks Used	Type and Percent Additives
Surface	12 1/4"	8 5/8"	24#	305.50'	Common	215	2% gel/3% cc
Production	7 7/8"	4 1/2"	10 1/2#	3693.50'	Mud Flush	10b.	75% CFR2

PERFORATION RECORD

Shots Per Foot	Specify Footage of Each Interval Perforated	Acid, Fracture, Shot, Cement Squeeze Record (Amount and Kind of Material Used)	Depth
Two	At 1554' and squeeze-cemented off the Dakota Sandstone with 300 sacks	300 gal. of MOD-202 (15% HCl-10% Acetic) ATP - 1/3 bbl. per min., MTP - 1/3 bbl. per min., ATP - 300#, MTP - 300#	

TUBING RECORD

Size	Set At	Packer at	Liner Run <input type="checkbox"/> Yes <input type="checkbox"/> No
2 3/8"	3691'	N/A	