

STATE CORPORATION COMMISSION OF KANSAS  
OIL & GAS CONSERVATION DIVISION

WELL COMPLETION OR RECOMPLETION FORM  
ACO-1 WELL HISTORY

DESCRIPTION OF WELL AND LEASE

Operator: License # 5020  
Name Rine Exploration Company  
Address Suite #645  
300 W. Douglas  
City/State/Zip Wichita, KS 67202

Purchaser N/A

Operator Contact Person M. Bradford Rine  
Phone 316/262-5418

Contractor: License # 5422  
Name Abercrombie Drilling, Inc.

Wellsite Geologist Chuck Immich  
Phone 316/684-5500

Designate Type of Completion

- New Well
- Re-Entry
- Workover
- Oil
- Gas
- Dry
- SWD
- Inj
- Other (Core, Water Supply etc.)
- Temp Abd
- Delayed Comp.

If OWWO: old well info as follows:

Operator  
Well Name  
Comp. Date Old Total Depth

WELL HISTORY

Drilling Method:

- Mud Rotary
- Air Rotary
- Cable

01/09/86	01/16/86	01/16/86
Spud Date	Date Reached TD	Completion Date
3760'		
Total Depth	PBTD	

Amount of Surface Pipe Set and Cemented at 345 feet  
Multiple Stage Cementing Collar Used?  Yes  No  
If yes, show depth set  
If alternate 2 completion, cement circulated from 345 feet depth to surface/300 SX cmt

API NO. 15-163-22,858  
County Rooks  
500' N. of S. Line  
630' E. of W. Line 24 Sec. 10S Rge 20W  
 East  West

*Ind*  
**24-10-20W**

500 Ft North from Southeast Corner of Section  
1630 Ft West from Southeast Corner of Section  
(Note: Locate well in section plat below)

Lease Name Sutor Well # 2-24

Field Name

Producing Formation

Elevation: Ground 2122 KB 2127

Section Plat

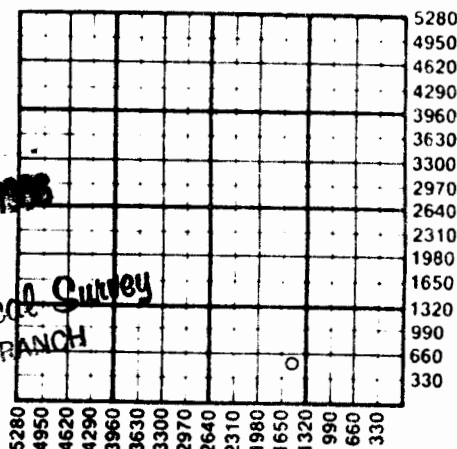

WATER SUPPLY INFORMATION

Disposition of Produced Water:  Disposal  
Docket #  Repressuring

Questions on this portion of the ACO-1 call:  
Water Resources Board (913) 296-3717

Source of Water:  
Division of Water Resources Permit #

Groundwater.....Ft North from Southeast Corner (Well) .....Ft West from Southeast Corner of Sec Twp Rge  East  West

Surface Water 500 Ft North from Southeast Corner (Stream, pond etc) 3630 Ft West from Southeast Corner Sec 24 Twp 10S Rge 20  East  West

Other (explain).....  
(purchased from city, R.W.D. #)

INSTRUCTIONS: This form shall be completed in duplicate and filed with the Kansas Corporation Commission, 200 Colorado Derby Building, Wichita, Kansas 67202, within 90 days after completion or recompletion of any well. Rule 82-3-130 and 82-3-107 apply.  
Information on side two of this form will be held confidential for a period of 12 months if requested in writing and submitted with the form. See rule 82-3-107 for confidentiality in excess of 12 months.  
One copy of all wireline logs and drillers time log shall be attached with this form. Submit CP-4 form with all plugged wells. Submit CP-111 form with all temporarily abandoned wells.

75636

STATE

Operator Name Rine Exploration Company Lease Name Sutor Well # 2-24
Sec. 24 Twp. 10 South Rge. 20 West County Rooks

WELL LOG

INSTRUCTIONS: Show important tops and base of formations penetrated. Detail all cores. Report all drill stem tests giving interval tested, time tool open and closed, flowing and shut-in pressures, whether shut-in pressure reached static level, hydrostatic pressures, bottom hole temperature, fluid recovery, and flow rates if gas to surface during test. Attach extra sheet if more space is needed. Attach copy of log.

Drill Stem Tests Taken [X] Yes [ ] No
Samples Sent to Geological Survey [X] Yes [ ] No
Cores Taken [ ] Yes [X] No
#1: 3378'-3394' (Lansing "A") 30-30-30-30. Weak blow, died in 15 min. Rec.: 10' of mud.
#2: 3411'-3456' (Lansing "B", "D" & "E") 30-30-15-60. Weak blow, died in 30 min. Rec.: 20' of mud.
#3: 3636'-3697' (Arbuckle) 30-30-30-30. Weak blow, died in 30 min. Rec.: 10' of mud.
#4: 3636'-3702' (Arbuckle) 30-45-30-45. Weak blow, died in 30 min. Rec.: 20' of mud.
#5: 3698'-3707' (Arbuckle) 30-30-15-15. Weak blow, died in 30 min. Rec.: 20' of mud.

Formation Description table with columns: Name, Top, Bottom. Includes entries for Heebner, Lansing, Base Kansas City, Arbuckle, and LTD.

CASING RECORD, PERFORATION RECORD, TUBING RECORD, and Date of First Production/Producing Method section.