

State Geological Survey

WICHITA BRANCH
KANSAS DRILLERS LOG

15-163-20724

API No. 15 — 163 — 20,726
County Number

S. 27 T. 10 R. 20 ^EW

Loc. C NE SE

County Rooks

Operator

Meltzer Oil Co.

Address

Drawer "B" Great Bend, Kansas 67530

Well No.

#4

Lease Name

Poague

Footage Location

660 feet from (N) line 1320 feet from (E) line

Principal Contractor

A. L. Abercrombie, Inc.

Geologist

Spud Date

9-12-77

Total Depth

1595'

P.B.T.D.

Date Completed

9-14-77

Oil Purchaser

None - SWD

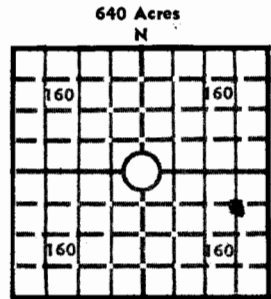

Locate well correctly

Elev.: Gr. _____

DF _____

KB _____

CASING RECORD

Report of all strings set — surface, intermediate, production, etc.

Purpose of string	Size hole drilled	Size casing set (in O.D.)	Weight lbs/ft.	Setting depth	Type cement	Sacks	Type and percent additives
Surface casing	12 1/4"	8 5/8"	260'	260'	common	165	3% Ca, Cl., 2% gel.
Casing	7 7/8"	4 1/2"	1595'	1594'	common	225 sx. 200 sx.	60/40 pos, 4% gel. common, 4% gel.

LINER RECORD

Top, ft. None Bottom, ft. None Sacks cement None

PERFORATION RECORD

Shots per ft. 1 Size & type 3.5 -scint Depth interval 20'

TUBING RECORD

Size None Setting depth None Packer set at None

ACID, FRACTURE, SHOT, CEMENT SQUEEZE RECORD

Amount and kind of material used

Depth interval treated

INITIAL PRODUCTION

Date of first production None Producing method (flowing, pumping, gas lift, etc.) _____

RATE OF PRODUCTION PER 24 HOURS
Oil _____ bbls. Gas _____ MCF Water _____ bbls. Gas-oil ratio _____ CFPB

Disposition of gas (vented, used on lease or sold) _____ Producing interval (s) _____

INSTRUCTIONS: As provided in KCC Rule 82-2-125, within 90 days after completion of a well, one completed copy of this Drillers Log shall be transmitted to the State Geological Survey of Kansas, 4150 Monroe Street, Wichita, Kansas 67209. Copies of this form are available from the Conservation Division, State Corporation Commission, 3830 So. Meridian (P.O. Box 17027), Wichita, Kansas 66217. Phone AC 316-522-2206. If confidential custody is desired, please note Rule 82-2-125. Drillers Logs will be on open file in the Oil and Gas Division, State Geological Survey of Kansas, Lawrence, Kansas 66044.

Operator Meltzer Oil Company DESIGNATE TYPE OF COMP.: OIL, GAS, DRY HOLE, SWDW, ETC.: SWDW

Well No. 4 Lease Name Poague

S 27 T 10S R 20W E/4 W Rooks County, Kansas

WELL LOG Show all important zones of porosity and contents thereof; cored intervals, and all drill-stem tests, including depth interval tested, cushion used, time tool open, flowing and shut-in pressures, and recoveries. SHOW GEOLOGICAL MARKERS, LOGS RUN, OR OTHER DESCRIPTIVE INFORMATION.

Table with 5 columns: FORMATION DESCRIPTION, CONTENTS, ETC., TOP, BOTTOM, NAME, DEPTH. The table is currently empty.

USE ADDITIONAL SHEETS, IF NECESSARY, TO COMPLETE WELL RECORD.

Date Received Nathan Meltzer Signature Owner Title 9-23-77 Date

45656