

State Geological Survey
WICHITA, BRANCH

KANSAS DRILLERS LOG

S. 1 T. 10 R. 22 ^W

API No. 15 — 065 — 20,880
County Number

Loc. 90' W/C NE

Operator
KEDCO Management Corp.

County Graham

Address **816 Union Center Wichita, Kansas 67202**

Well No. #2 Lease Name Brown

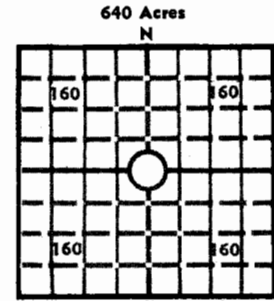

Footage Location
1320 feet from (N) line 1410 feet from (E) line

Principal Contractor **Abercrombie Drilling, Inc.** Geologist **George Dent**

Spud Date November 27, 1976 Total Depth 3950' P.B.T.D.

Date Completed December 16, 1976 Oil Purchaser **Mobil**

Elev.: Gr. 2332

DF KB 2340

CASING RECORD

Report of all strings set — surface, intermediate, production, etc.

Purpose of string	Size hole drilled	Size casing set (in O.D.)	Weight lbs/ft.	Setting depth	Type cement	Sacks	Type and percent additives
Surface	12 1/4"	8 5/8	28#	260	common cem.	160	2% gel, 3% CaCl
Production	7 7/8	4 1/2	10.5	3948	HLC cement	420 (DV) 150 (shoe)	420 Halco Light cem. 150--50/50 poz. salt sat w/10# gils/sx

LINER RECORD

PERFORATION RECORD

Top, ft.	Bottom, ft.	Sacks cement	Shots per ft.	Size & type	Depth interval
			2	Jet	3652 1/2 - 3655 1/2
			1	"	3654'
			3	"	3644 1/2 - 3646 1/2
			1	"	3645 1/2
			3	"	3569 - 3573

TUBING RECORD

Size	Setting depth	Packer set at	Shots per ft.	Size & type	Depth interval
2 3/8"	3911"	None	1	"	3645 1/2
			3	"	3569 - 3573

ACID, FRACTURE, SHOT, CEMENT SQUEEZE RECORD

Amount and kind of material used	Depth interval treated
1000 gal 15% N-E acid, BDP 800#, AIR of 8 B/M at 900#, ISDP 0#	3645 1/2 - 3654
1000 gal 15% N-E acid; BDP 1000#, IR of 5 1/2 - 8 1/2 B/M @ 200# - 500#	3569 - 3573

INITIAL PRODUCTION

Date of first production <u>January 17, 1977</u>	Producing method (flowing, pumping, gas lift, etc.)			
RATE OF PRODUCTION PER 24 HOURS	Oil <u>33</u> bbls.	Gas <u>-0-</u> MCF	Water <u>47</u> bbls.	Gas-oil ratio <u>CFPB</u>
Disposition of gas (vented, used on lease or sold)			Producing interval(s) L/KC A <u>3569-3573</u> L/KC F <u>3644 1/2-3646 1/2</u> ; G <u>3652 1/2-3655 1/2</u>	

INSTRUCTIONS: As provided in KCC Rule 82-2-125, within 90 days after completion of a well, one completed copy of this Drillers Log shall be transmitted to the State Geological Survey of Kansas, 4150 Monroe Street, Wichita, Kansas 67209. Copies of this form are available from the Conservation Division, State Corporation Commission, 3830 So. Meridian (P.O. Box 17027), Wichita, Kansas 66217. Phone AC 316-522-2206. If confidential custody is desired, please note Rule 82-2-125. Drillers Logs will be on open file in the Oil and Gas Division, State Geological Survey of Kansas, Lawrence, Kansas 66044.

Operator Kedco Management Corporation		DESIGNATE TYPE OF COMP.: OIL, GAS, DRY HOLE, SWDW, ETC.:
Well No. 2	Lease Name Brown	Oil
S 1 T 10S R 22 W		90' W/C NE

WELL LOG

Show all important zones of porosity and contents thereof; cored intervals, and all drill-stem tests, including depth interval tested, cushion used, time tool open, flowing and shut-in pressures, and recoveries.

SHOW GEOLOGICAL MARKERS, LOGS RUN, OR OTHER DESCRIPTIVE INFORMATION.

FORMATION DESCRIPTION, CONTENTS, ETC.	TOP	BOTTOM	NAME	DEPTH
Clay, Sand & Rock	0	175	Anhydrite	1820
Shale	175	945	Heebner	3528
Sand	945	1020	Toronto	3550
Shale & Sand	1020	1324	Lansing	3568
Sand	1324	1560	B/KC	3794
Shale	1560	1821	Arbuckle	3932
Anhydrite	1821	1858		
Shale	1858	2365		
Shale & Lime	2365	3651		
Lime	3651	3675		
Lime & Shale	3675	3750		
Lime	3750	3950		
Rotary Total Depth		3950		
DST #1 3542'-3590' (Toronto & Lansing "A" zone) Open 120 min with weak blow throughout Rec. 180' gas in pipe & 240' OCM (35% oil). IFP (60 min) 53#-86# ISIP (30 min) 707# FFP (60 min) 107#-129# FSIP (90 min) 866#		DST #4 3745'-3790' Open 90 min. with fair blow throughout Rec. 60' SOC water & 120' muddy water IFP (30 min) 43#-64# ISIP (60 min) 781# FFP (60 min) 86#-107# FSIP (90 min) 750#		
DST #2 3638'-3675' (Lansing "F" & "G" zones) Open 90 min. with strong blow throughout Rec. 600' gas in pipe, 480' H0&GC mud with trace of wtr. (fluid grind out: 68% oil, 12% mud, 5% wtr & 15% gas) IFP (30 min) 43#-118# ISIP (60 min) 516# FFP (60 min) 140#-226# FSIP (90 min) 516#				
DST #3 3704'-3750' (Lansing "H" & "I" zones) Open 60 min. with weak blow for 10 min. Rec. 5' mud. IFP (30 min) 53#-53# ISIP (30 min) 161# FFP (30 min) 53#-53# FSIP (30 min) 107#				

USE ADDITIONAL SHEETS, IF NECESSARY, TO COMPLETE WELL RECORD.

Date Received	<p><i>Wayne L. Brinegar</i> Wayne L. Brinegar Vice President</p>
	<p>Signature</p>
	<p>Title</p>
	<p>January 28, 1977</p>
	<p>Date</p>

2545L

CONTRACTOR'S WELL LOG

15-065-20880

OPERATOR:	KEDCO Management Corporation
CONTRACTOR:	Abercrombie Drilling, Inc.
WELL NAME:	BROWN #2
LOCATION:	C NE/4, Section 1-10S-22W
	Graham County, Kansas
SPUD DATE:	11-27-76
COMPLETION DATE:	12-06-76

MAR 17 1977

0	175	Clay, Sand & Rock
175	945	Shale
945	1020	Sand
1020	1324	Shale & Sand
1324	1560	Sand
1560	1821	Shale
1821	1858	Anhydrite
1858	2365	Shale
2365	3651	Shale & Lime
3651	3675	Lime
3675	3750	Lime & Shale
3750	3950	Lime
	3950	Rotary Total Depth

Drilled 261' of 12 1/4" hole. Ran 7 jts. of 8 5/8" surface casing. (Tally 250.64) Set at 260' K.B. Cemented with 160 sx. of common cement, 2% gel, 3% Ca. Cl. Cement did circulate. Plug was down at 10:30 p.m. 11-27-76.

Ran 122 Jts. of new 4 1/2" - 10 1/2# Casing, 64 jts. of used 4 1/2" & 58 jts. of new casing. (Total tally 3967.53') Shoe set at 3048' - 2 Staged, D.V. Tool set at 1844.18'. Bottom stage cemented with 150 sx. of 50/50 posmix, 18% Salt with 10# gilsonite per sack. Top stage cemented with 420 sx. of HLC Cement. Job complete at 5:35 p.m. 12-06-76.

SAMPLE TOPS:

Anhydrite 1821' (+519)
B/Anhydrite 1858' (+482)

STATE OF KANSAS)
) SS
COUNTY OF SEDGWICK)

Jack L. Partridge, Assistant Secretary-Treasurer of Abercrombie Drilling, Inc., does hereby certify that the above and foregoing is a true and correct copy of the log of the BROWN #2, C NE Section 1-10S-22W, Graham County, Kansas.

ABERCROMBIE DRILLING, INC.

BY: *Jack L. Partridge*