

S. 5 T. 10 R. 22 ^W

API No. 15 — 065 — 20,709
 County Number

Loc. C N2 NE SW

County Graham

Operator
Barnett Oil, Inc., & H. Rosen

Address
411 First National Bank Bldg., Wichita, Kansas 67202

Well No. #1 Lease Name Griffith

Footage Location
 feet from (N) (S) line _____ feet from (E) (W) line _____

Principal Contractor Red Tiger Drilling Co. Geologist R. B. Gebhart, Jr.

Spud Date September 13, 1974 Total Depth 4006' P.B.T.D. _____

Date Completed September 21, 1974 Oil Purchaser None

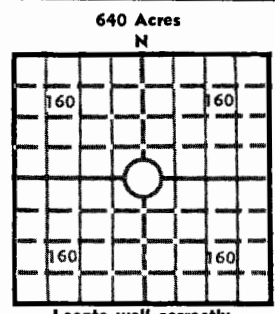

Locate well correctly
 Elev.: Gr. 2341
 DF 2343 KB 2346

CASING RECORD

Report of all strings set — surface, intermediate, production, etc.

Purpose of string	Size hole drilled	Size casing set (in O.D.)	Weight lbs/ft.	Setting depth	Type cement	Sacks	Type and percent additives
Surface	12 1/4"	8 5/8"	28#	212'	Common	150	

LINER RECORD

PERFORATION RECORD

Top, ft.	Bottom, ft.	Sacks cement	Shots per ft.	Size & type	Depth interval
- -			- -		

Size	Setting depth	Packer set at
- -		

ACID, FRACTURE, SHOT, CEMENT SQUEEZE RECORD

Amount and kind of material used	Depth interval treated
None	

INITIAL PRODUCTION

Date of first production None Producing method (flowing, pumping, gas lift, etc.) _____

RATE OF PRODUCTION PER 24 HOURS	Oil	Gas	Water	Gas-oil ratio
	bbls.	MCF	bbls.	CFPB

Disposition of gas (vented, used on lease or sold) _____ Producing interval(s) _____

INSTRUCTIONS: As provided in KCC Rule 82-2-125, within 90 days after completion of a well, one completed copy of this Drillers Log shall be transmitted to the State Geological Survey of Kansas, 4150 Monroe Street, Wichita, Kansas 67209. Copies of this form are available from the Conservation Division, State Corporation Commission, 3830 So. Meridian (P.O. Box 17027), Wichita, Kansas 66217. Phone AC 316-522-2206. If confidential custody is desired, please note Rule 82-2-125. Drillers Logs will be on open file in the Oil and Gas Division, State Geological Survey of Kansas, Lawrence, Kansas 66044.

Operator Barnett Oil, Inc. & H. Rosen DESIGNATE TYPE OF COMP.: OIL, GAS, DRY HOLE, SWDW, ETC.: Dry Hole

Well No. 1 Lease Name Griffith

S 5 T 10S R 22W E W

WELL LOG

Show all important zones of porosity and contents thereof; cored intervals, and all drill-stem tests, including depth interval tested, cushion used, time tool open, flowing and shut-in pressures, and recoveries.

SHOW GEOLOGICAL MARKERS, LOGS RUN, OR OTHER DESCRIPTIVE INFORMATION.

FORMATION DESCRIPTION, CONTENTS, ETC.	TOP	BOTTOM	NAME	DEPTH
Shale	0	780	Anhydrite	1882 (+464)
Sand & Shale	780	882	B/Anhydrite	1918 (+428)
Shale	882	1065	Howard Lm.	3318 (-972)
Shale & Shells	1065	1405	Topeka	3360 (-1014)
Sand	1405	1590	Heebner	3576 (-1232)
Shale & Redbed	1590	1810	Toronto	3599 (-1253)
Shale	1810	1882	Lansing	3613 (-1267)
Anhydrite	1882	1918	B/K.C.	3834 (-1488)
Shale	1918	2545	Penn. Conglo.	4001 (-1655)
Shale & Lime	2545	2740	R.T.D.	4006 (-1661)
Lime & Shale	2740	2930		
Shale & Lime	2930	3033		
Lime & Shale	3033	3140		
Lime	3140	3850		
Shale & Lime	3850	3930		
Lime	3930	4006		

DST #1 - 3740 - 3840 - 0 - 60"; SI - 30";
 0 - 30"; SI - 30"; had weak blow - died
 14"; rec. 60' VSOCM.
 IFP - 92/104 IBHP - 987#
 FFP - 104/104 FBHP - 908#

USE ADDITIONAL SHEETS, IF NECESSARY, TO COMPLETE WELL RECORD.

Date Received

BARNETT OIL, INC
 By: *J. G. Gould*
 J. G. Gould Signature
 President
 Title
 October 9, 1974
 Date

75553