

15-065-20981

State Geological Survey

WICHITA BRANCH KANSAS DRILLERS LOG

S. 29 T. 10S R. 22W^E_W
Loc. SE SE SW
County Graham

API No. 15 — 065 — 20,981
County Number

Operator
National Oil Company

Address
200 West Douglas, Suite 550, Wichita, KS 67202

Well No. 1 Lease Name Stites

Footage Location
330 feet from 000 (S) line 2310 feet from 00 (W) line

Principal Contractor John O. Farmer Geologist Jay Dirks

Spud Date Jan. 3, 1978 Total Depth 3850 P.B.T.D.

Date Completed Jan. 12, 1978 Oil Purchaser

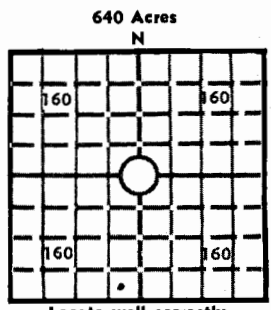

Locate well correctly
Elev.: Gr. 2326
DF 2328 KB 2331

CASING RECORD

Report of all strings set — surface, intermediate, production, etc.

Purpose of string	Size hole drilled	Size casing set (in O.D.)	Weight lbs/ft.	Setting depth	Type cement	Sacks	Type and percent additives
Surface	12½	8-5/8	26	208		165	3% cc

LINER RECORD

PERFORATION RECORD

Top, ft.	Bottom, ft.	Sacks cement	Shots per ft.	Size & type	Depth interval

TUBING RECORD

Size	Setting depth	Packer set at

ACID, FRACTURE, SHOT, CEMENT SQUEEZE RECORD

Amount and kind of material used	Depth interval treated

INITIAL PRODUCTION

Date of first production		Producing method (flowing, pumping, gas lift, etc.)			
RATE OF PRODUCTION PER 24 HOURS		Oil	Gas	Water	Gas-oil ratio
		bbls.	MCF	bbls.	CFPB
Disposition of gas (vented, used on lease or sold)				Producing interval (s)	

INSTRUCTIONS: As provided in KCC Rule 82-2-125, within 90 days after completion of a well, one completed copy of this Drillers Log shall be transmitted to the State Geological Survey of Kansas, 4150 Monroe Street, Wichita, Kansas 67209. Copies of this form are available from the Conservation Division, State Corporation Commission, 3830 So. Meridian (P.O. Box 17027), Wichita, Kansas 66217. Phone AC 316-522-2206. If confidential custody is desired, please note Rule 82-2-125. Drillers Logs will be on open file in the Oil and Gas Division, State Geological Survey of Kansas, Lawrence, Kansas 66044.

Operator National Oil Company DESIGNATE TYPE OF COMP.: OIL, GAS, DRY HOLE, SWDW, ETC.: Dry

Well No. 1 Lease Name Stites

S 29 T 10 S R 22 W E SE SE SW, Graham County, Kansas

WELL LOG
 Show all important zones of porosity and contents thereof; cored intervals, and all drill-stem tests, including depth interval tested, cushion used, time tool open, flowing and shut-in pressures, and recoveries. SHOW GEOLOGICAL MARKERS, LOGS RUN, OR OTHER DESCRIPTIVE INFORMATION.

FORMATION DESCRIPTION, CONTENTS, ETC.	TOP	BOTTOM	NAME	DEPTH
No Drill Stem Tests			Log Tops	
			Tarkio	3233 -902
			Howard	3311 -980
			Topeka	3355 -1024
			Heebner	3578 -1247
			Toronto	3602 -1271
			Lansing	3618 -1287
			B/Ks. City	3842 -1511
		LTD	3850 -1519	

USE ADDITIONAL SHEETS, IF NECESSARY, TO COMPLETE WELL RECORD.

Date Received _____
 Signature *Bill C. Romig*
 Title Geologist
 Date January 24, 1978

1989L