

15-065-20968

State Geological Survey
WICHITA BRANCH

IMPORTANT
Kans. Geo. Survey request
samples on this well.

KANSAS DRILLERS LOG

S. 28 T. 10 R. 24 ^E/_W

API No. 15 — 065 — 20,968
County Number

Loc. C SE

Operator
Don E. Pratt

County Graham

Address
P. O. Box 370 Hays, Ks. 67601

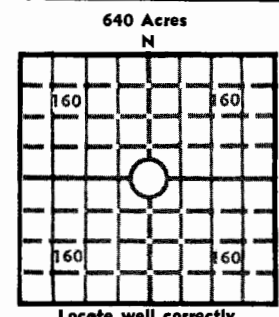

Well No. #1-28 Lease Name McCall

Elev.: Gr. 2383

Footage Location
1320 feet from ~~XX~~ (S) line 1320 feet from (E) ~~XX~~ line

DF 2385 KB 2388

Principal Contractor Murfin Drilling Co., Geologist Green & Green

Spud Date 10-27-77 Total Depth 4013 P.B.T.D.

Date Completed 11-4-77 Oil Purchaser Mobil

CASING RECORD

Report of all strings set — surface, intermediate, production, etc.

Purpose of string	Size hole drilled	Size casing set (in O.D.)	Weight lbs/ft.	Setting depth	Type cement	Sacks	Type and percent additives
Surface	12½"	8 5/8"	20#	172'	c.q.s.	140 sks.	
Oil string		5½"	10.50	4012'	c.q.s.	200 sks.	

LINER RECORD

PERFORATION RECORD

Top, ft.	Bottom, ft.	Sacks cement	Shots per ft.	Size & type	Depth interval
			4		3928-32

TUBING RECORD

Size	Setting depth	Packer set at

ACID, FRACTURE, SHOT, CEMENT SQUEEZE RECORD

Amount and kind of material used	Depth interval treated
none	

INITIAL PRODUCTION

Date of first production 11-10-77 Producing method (flowing, pumping, gas lift, etc.) swab.,

RATE OF PRODUCTION PER 24 HOURS	Oil <u>33 bbl. 3hr. test.,</u>	Gas	Water	Gas-oil ratio
		MCF	bbls.	CFPB

Disposition of gas (vented, used on lease or sold) _____ Producing interval (s) _____

INSTRUCTIONS: As provided in KCC Rule 82-2-125, within 90 days after completion of a well, one completed copy of this Drillers Log shall be transmitted to the State Geological Survey of Kansas, 4150 Monroe Street, Wichita, Kansas 67209. Copies of this form are available from the Conservation Division, State Corporation Commission, 3830 So. Meridian (P.O. Box 17027), Wichita, Kansas 66217. Phone AC 316-522-2206. If confidential custody is desired, please note Rule 82-2-125. Drillers Logs will be on open file in the Oil and Gas Division, State Geological Survey of Kansas, Lawrence, Kansas 66044.

Operator Don E. Pratt DESIGNATE TYPE OF COMP.: OIL, GAS, DRY HOLE, SWDW, ETC.: Oil

Well No. 1 Lease Name McCall

S 28 T 10S R 21W E W

WELL LOG

Show all important zones of porosity and contents thereof; cored intervals, and all drill-stem tests, including depth interval tested, cushion used, time tool open, flowing and shut-in pressures, and recoveries.

SHOW GEOLOGICAL MARKERS, LOGS RUN, OR OTHER DESCRIPTIVE INFORMATION.

FORMATION DESCRIPTION, CONTENTS, ETC.	TOP	BOTTOM	NAME	DEPTH
See geological report attached.,				

USE ADDITIONAL SHEETS, IF NECESSARY, TO COMPLETE WELL RECORD.

Date Received	<p style="text-align: right;"><i>Susie Ubert</i> Don E. Pratt</p> <p>BY: Susie Ubert <small>Signature</small></p> <p style="text-align: center;">Office Mgr.,</p> <hr/> <p style="text-align: center;">12-16-77</p> <hr/> <p style="text-align: center;"><small>Date</small></p>
---------------	--

17816t