

State Geological Survey
WICHITA BRANCH
KANSAS DRILLERS LOG

15-065-20995

API No. 15 — County — Number

S. 23 T. 10 R. 25 W

Loc. E/2 E/2 SW/4

County Graham

Operator Beren Corporation

Address 970 Fourth Financial Center, Wichita, Ks. 67202

Well No. 2 Lease Name SCHREINER

Footage Location 990 feet from (N) (S) line 330 feet from (E) (W) line

Principal Contractor John O. Farmer, Inc. Geologist Thomas E. Satter

Spud Date 2-23-78 Total Depth 4070 P.B.T.D.

Date Completed 3-4-78 Oil Purchaser None - D & A

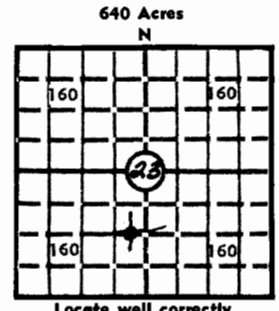

Locate well correctly Elev.: Gr. 2502

DF 2505 KB 2507

CASING RECORD

Report of all strings set — surface, intermediate, production, etc.

Purpose of string	Size hole drilled	Size casing set (in O.D.)	Weight lbs/ft.	Setting depth	Type cement	Sacks	Type and percent additives
Surface	12 1/4	8-5/8	26	302	Common	225	3% CC

LINER RECORD

PERFORATION RECORD

Top, ft.	Bottom, ft.	Sacks cement	Shots per ft.	Size & type	Depth interval

TUBING RECORD

Size	Setting depth	Packer set at

ACID, FRACTURE, SHOT, CEMENT SQUEEZE RECORD

Amount and kind of material used	Depth interval treated

INITIAL PRODUCTION

Date of first production		Producing method (flowing, pumping, gas lift, etc.)			
RATE OF PRODUCTION PER 24 HOURS	Oil bbls.	Gas MCF	Water bbls.	Gas-oil ratio CFPB	
Disposition of gas (vented, used on lease or sold)			Producing interval (s)		

INSTRUCTIONS: As provided in KCC Rule 82-2-125, within 90 days after completion of a well, one completed copy of this Drillers Log shall be transmitted to the State Geological Survey of Kansas, 4150 Monroe Street, Wichita, Kansas 67209. Copies of this form are available from the Conservation Division, State Corporation Commission, 3830 So. Meridian (P.O. Box 17027), Wichita, Kansas 66217. Phone AC 316-522-2206. If confidential custody is desired, please note Rule 82-2-125. Drillers Logs will be on open file in the Oil and Gas Division, State Geological Survey of Kansas, Lawrence, Kansas 66044.

Operator Beren Corporation DESIGNATE TYPE OF COMP.: OIL, GAS, DRY HOLE, SWDW, ETC.:

Well No. 2 Lease Name SCHREINER Dry Hole

S 23 T 10 R 25 W E
W

WELL LOG

Show all important zones of porosity and contents thereof; cored intervals, and all drill-stem tests, including depth interval tested, cushion used, time tool open, flowing and shut-in pressures, and recoveries.

SHOW GEOLOGICAL MARKERS, LOGS RUN, OR OTHER DESCRIPTIVE INFORMATION.

FORMATION DESCRIPTION, CONTENTS, ETC.	TOP	BOTTOM	NAME	DEPTH
Clay Pot Rock	0	80		
Sand	80	120		
Blue Shale	120	302		
Shale & Sand	302	1745		
Sand	1745	1940		
Red Bed	1940	2171		
Anhydrite	2171	2216		
Shale & Shells	2216	2598		
Shale & Lime	2598	3470		
Lime & Shale	3470	3645		
Shale & Lime	3645	3730		
Lime & Shale	3730	3874		
Lime	3874	3908		
Lime & Shale	3908	3920		
Lime	3920	4040		
Lime & Shale	4040	4070		

USE ADDITIONAL SHEETS, IF NECESSARY, TO COMPLETE WELL RECORD.

Date Received	<div style="margin-bottom: 5px;"></div> <hr/> <div style="margin-bottom: 5px;">Don Beauchamp - Geologist</div> <hr/> <div style="margin-bottom: 5px;">March 9, 1978</div> <hr/>
	<div style="margin-bottom: 5px;">Signature</div> <hr/> <div style="margin-bottom: 5px;">Title</div> <hr/> <div style="margin-bottom: 5px;">Date</div> <hr/>

H958L