

26-10-25W

SIDE ONE
S

STATE CORPORATION COMMISSION OF KANSAS
OIL & GAS CONSERVATION DIVISION
WELL COMPLETION OR RECOMPLETION FORM
ACO-1 WELL HISTORY
DESCRIPTION OF WELL AND LEASE

Operator: License # 7013
Name Geana Oil Company
Address Route 1, Box 4
WaKeeney, Kansas 67672
City/State/Zip

Purchaser None

Operator Contact Person Charles Rhoades
Phone 913-743-5419

Contractor: License # 3300
Name Lloyd Drilling Company

Wellsite Geologist Dusty Rhoades
Phone 913-743-5419

Designate Type of Completion
 New Well Re-Entry Workover
 Oil SWD Temp Abd
 Gas Inj Delayed Comp
 Dry Other (Core, Water Supply etc.)

If ONNO: old well info as follows:
Operator
Well Name
Comp. Date Old Total Depth

WELL HISTORY

Drilling Method:
 Mud Rotary Air Rotary Cable
5-11-88 5-17-88 5-18-88
Spud Date Date Reached TD Completion Date
4100' 4100'
Total Depth PBTD

Amount of Surface Pipe Set and Cemented at 226' feet
Multiple Stage Cementing Collar Used? Yes No
If yes, show depth set feet
If alternate 2 completion, cement circulated from feet depth to w/SX cmt
Cement Company Name BJ-Titan
Invoice # 362946

API NO. 15-065-22,458
County Graham
E/2 E/2 NW Sec 26 Twp 10 Rge 25 East
3960' Ft North from Southeast Corner of Section
2970' Ft West from Southeast Corner of Section
(Note: Locate well in section plat below)
Lease Name Knoll Well # 1
Field Name None
Producing Formation None
Elevation: Ground 2510 KB 2520

DEC 06 1988

KANSAS GEOLOGICAL SURVEY
WICHITA BRANCH

RECEIVED
STATE CORPORATION COMMISSION

CONSERVATION DIVISION
Wichita, Kansas

Section Plat

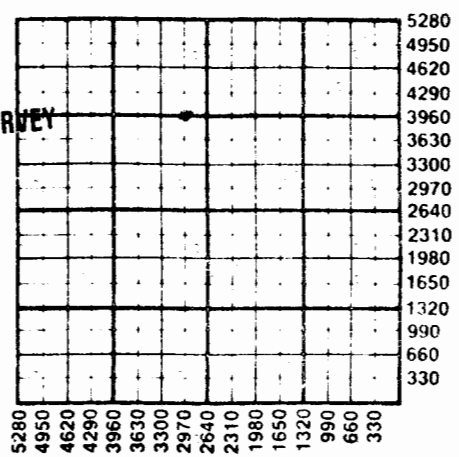

WATER SUPPLY INFORMATION

Disposition of Produced Water: Disposal
Docket # Repressuring

Questions on this portion of the ACO-1 call:
Water Resources Board (913) 296-3717

Source of Water:
Division of Water Resources Permit #
Groundwater Ft North from Southeast Corner (Well) Ft West from Southeast Corner of Sec Twp Rge East West
 Surface Water 1980' Ft North from Southeast Corner (Stream, pond etc) 900' Ft West from Southeast Corner Sec 15 Twp 10S Rge 25 East West
Other (explain) (purchased from city, R.W.D. #)

INSTRUCTIONS: This form shall be completed in triplicate and filed with the Kansas Corporation Commission, 200 Colorado Derby Building, Wichita, Kansas 67202, within 120 days of the spud date of any well. Rule 82-3-130, 82-3-107 and 82-3-106 apply. Information on side two of this form will be held confidential for a period of 12 months if requested in writing and submitted with the form. See rule 82-3-107 for confidentiality in excess of 12 months. One copy of all wireline logs and drillers time log shall be attached with this form. Submit CP-4 form with all plugged wells. Submit CP-111 form with all temporarily abandoned wells.

All requirements of the statutes, rules and regulations promulgated to regulate the oil and gas industry have been fully complied with and the statements herein are complete and correct to the best of my knowledge.

Signature Charles R. Rhoades
Title President Date 11/30/88

Subscribed and sworn to before me this 30th day of November 1988
Notary Public Angela Sherfick
Date Commission Expires 6/27/92

K.C.C. OFFICE USE ONLY
F Letter of Confidentiality Attached
C Wireline Log Received
C Drillers Timelog Received
Distribution
KCC SWD/Rep NGPA
KGS Plug Other (Specify)

ANGELA SHERFICK
NOTARY PUBLIC
STATE OF KANSAS
MY APPT. EXPIRES 6-27-92

Sec 26 Twp 10 Rge 25 W

Operator Name Geana Oil Company Lease Name Knoll Well # 1

Sec. 26 Twp. 10s Rge. 25 East West County Graham

WELL LOG

INSTRUCTIONS: Show important tops and base of formations penetrated. Detail all cores. Report all drill stem tests giving interval tested, time tool open and closed, flowing and shut-in pressures, whether shut-in pressure reached static level, hydrostatic pressures, bottom hole temperature, fluid recovery, and flow rates if gas to surface during test. Attach extra sheet if more space is needed. Attach copy of log.

Drill Stem Tests Taken Yes No
 Samples Sent to Geological Survey Yes No
 Cores Taken Yes No

Formation Description
 Log Sample

DST#1 - 3855-3895
 Open 30, Shut-in 60, Open 30, Shut-in 60
 Rec: 570' Dm, 120' Wm, Specks of Oil
 IHP-1855, FHP-1844, IFP-116-186, FFP-221-257,
 ISIP-1226, FSIP-1146, Temp.-118*

Name	Top	Bottom
Anhydrite	2176(+ 344)	
Base Anhydrite		2216(+ 304)
Topeka	3588(-1068)	
Heebner	3804(-1284)	
Toronto	3828(-1308)	
Lansing	3844(-1324)	
Base Kansas City	4068(-1548)	
RTD	4100(-1580)	
LTD	4099(-1579)	

DST#@ - 3950-4005
 Open 30, Shut-in 30, Open 30, Shut-in 30
 Rec: 5' Dm
 IHP-1935, FHP-1912, IFP-46-46, FFP-46-46,
 ISIP-128, FSIP-93, Temp.-120*

DST#3 - 4045-4100
 Open 30, Shut-in 30, Open 30, Shut-in 30
 Rec: 7' Dm
 IHP-1070, FHP-1947, IFP-46-46, FFP-46-46,
 ISIP-70, FSIP-70, Temp.-121*

CASING RECORD <input checked="" type="checkbox"/> New <input type="checkbox"/> Used							
Report all strings set-conductor, surface, intermediate, production, etc.							
Purpose of String	Size Hole Drilled	Size Casing Set (in O.D.)	Weight Lbs/Ft.	Setting Depth	Type of Cement	#Sacks Used	Type and Percent Additives
Protect Fresh Water Zones	12 1/4	8 5/8	23#	226'	60/40poz	155	3%CC, 2%gel
PERFORATION RECORD				Acid, Fracture, Shot, Cement Squeeze Record			
Shots Per Foot	Specify Footage of Each Interval Perforated			(Amount and Kind of Material Used)		Depth	
TUBING RECORD				Liner Run <input type="checkbox"/> Yes <input type="checkbox"/> No			
Date of First Production	Producing Method <input type="checkbox"/> Flowing <input type="checkbox"/> Pumping <input type="checkbox"/> Gas Lift <input type="checkbox"/> Other (explain).....						
Estimated Production Per 24 Hours	Oil	Gas	Water	Gas-Oil Ratio	Gravity		
	Bbls	MCF	Bbls	CFPB			

METHOD OF COMPLETION

Production Interval

Disposition of gas: Vented Open Hole Perforation
 Sold Other (Specify)
 Used on Lease Dually Completed
 Commingled