

STATE CORPORATION COMMISSION OF KANSAS
OIL & GAS CONSERVATION DIVISION

WELL COMPLETION OR RECOMPLETION FORM
ACO-1 WELL HISTORY

★ DESCRIPTION OF WELL AND LEASE

Operator: license # 9123
name Diamond Shamrock Exploration Company
address P. O. Box 400
City State Zip Amarillo, Texas 79188

Operator Contact Person James Skees
Phone 806-378-5681

Contractor: license # 5108
name H-30, Inc.

Wellsite Geologist Robert Smith
Phone 316-564-3362

PURCHASER

Designate Type of Completion
 New Well Re-Entry Workover

Oil SWD Temp Abd
 Gas Inj Delayed Comp.
 Dry Other (Core, Water Supply etc.)

If OWWO: old well info as follows:
Operator
Well Name
Comp. Date Old Total Depth

WELL HISTORY

Drilling Method: Mud Rotary Air Rotary Cable
7-1-85 7-9-85 7-9-85
Spud Date Date Reached TD Completion Date
4100
Total Depth PBDT

Amount of Surface Pipe Set and Cemented at 307 feet

Multiple Stage Cementing Collar Used? Yes No

If Yes, Show Depth Set feet

If alternate 2 completion, cement circulated from feet depth to w/ SX cmt

API NO. 15-179-20,825 *And P*

County Sheridan

NE SW SW Sec 2 Twp 10S Rge 26W

990 Ft North from Southeast Corner of Section
4290 Ft West from Southeast Corner of Section
(Note: locate well in section plat below)

Lease Name Norbert Von Lintel Well# 5

Field Name

Producing Formation

Elevation: Ground 2549 KB 2554

Section Plat

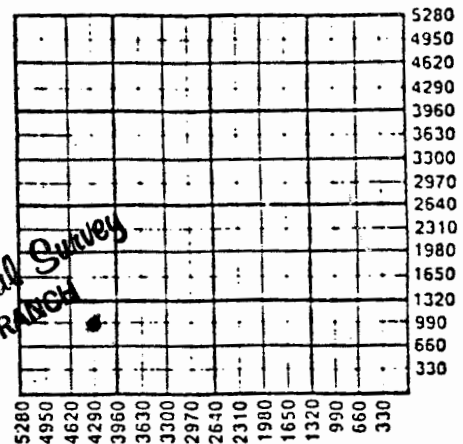

AUG 14 1985
State Geological Survey
WICHITA BRANCH

WATER SUPPLY INFORMATION

Source of Water:
Division of Water Resources Permit #
 Groundwater. Ft North From Southeast Corner and (Well) Ft West From Southeast Corner of Section Twp Rge East West
 Surface Water. Ft North From Southeast Corner and (Stream, Pond etc.) Ft West From Southeast Corner of Section Twp Rge East West
 Other (explain) (purchased from city, R.W.D.#)

Disposition of Produced Water: Disposal Repressuring
Docket #

INSTRUCTIONS: This form shall be completed in duplicate and filed with the Kansas Corporation Commission, 200 Colorado Derby Building, Wichita, Kansas 67202, within 90 days after completion or recompletion of any well. Rules 82-3-130 and 82-3-107 apply.

Information on side two of this form will be held confidential for a period of 12 months if requested in writing and submitted with the form. See rule 82-3-107 for confidentiality in excess of 12 months.

One copy of all wireline logs and drillers time log shall be attached with this form. Submit CP-4 form with all plugged wells. Submit CP-111 form with all temporarily abandoned wells.

All requirements of the statutes, rules, and regulations promulgated to regulate the oil and gas industry have been fully complied with and the statements herein are complete and correct to the best of my knowledge.

78793

Diamond Shamrock
 Operator Name Exploration Company..... Lease Name Lintel..... Well# 5 SEC. 2 TWP. 10S RGE. 26W East We

WELL LOG

INSTRUCTIONS: Show important tops and base of formations penetrated. Detail all cores. Report all drill s... tes giving interval tested, time tool open and closed, flowing and shut-in pressures, whether shut-in pressure reach... stat level, hydrostatic pressures, bottom hole temperature, fluid recovery, and flow rates if gas to surface during test. Attach extra sheet if more space is needed. Attach copy of log.

Drill Stem Tests Taken Yes No
 Samples Sent to Geological Survey Yes No
 Cores Taken Yes No

Formation Description
 Log Sample

DST #1: 3836-3856', times 30/60/30/60. IHP 1911, IFP 40/40, FFP 40/40, SIP 1039/1030, FHP 1852. DP rec 20' water cut mud.
 DST #2: 3858-3872', times 30/60/15/60. IHP 1832, IFP 20/20, FFP 20/20, SIP 20/20, FHP 1763. Samples rec 2000 cc mud at 10 psi.
 DST #3: 3881-3910', times 30/60/30/60. First open strong blow off btm of bucket in 23 mins. FP 60/110, SIP 1049. Second open strong blow off btm in 27 mins. FP 150/180, SIP 1049. Rec 110' watery mud & 250' muddy water. No shows of oil or gas.
 DST #4: 4006-35', times 15/30/15/30. First open 1/4" blow died in 10 mins. FP 70/50, SIP 60. Second open no blow. FP 50/40, SIP 60. Rec 2' drlg mud.

Name	Top	Bottom
Anhydrite	2182	
Heebner	3773	
Toronto	3794	
Lansing	3812	
B/KC	4042	
TD	4100	

CASING RECORD new used

Report all strings set - conductor, surface, intermediate, production, etc.

Purpose of string	size hole drilled	size casing set (in O.D.)	weight lbs/ft.	setting depth	type of cement	# sacks used	type and percent additives
Surface	12-1/4	8-5/8	24	307	Class A	250	2% gel, 3% cc

PERFORATION RECORD

Acid, Fracture, Shot, Cement Squeeze Record

shots per foot	specify footage of each interval perforated	(amount and kind of material used)

TUBING RECORD size set at nacker at